

Important Note:

Enclosed one set of Decra Classic Tile drawings.

Please note the drawing enclosed were published prior to name changes that were recently made in the Decra Roof Systems Product range.

The product previously known as the Decra Pantile has been re-branded as the Decra Classic Tile as part of our European harmonisation programme.

All of the Decra Pantile details enclosed also apply to the Decra Classic Tile profile, only the name has changed.

Yours sincerely

Mark Bell
Technical Manager

Decra Classic Tile

Drawing no	Description	Shown In Decra Brochure	Most Commonly Used Detail
DTSW010	Warm Roof Eaves Detail Eaves Overhang With Insulated Fascia and Soffit • <i>Warm Roof Eaves Detail</i>		<input checked="" type="checkbox"/>
DTSW011	Warm roof Eaves Detail No Eaves Overhang • <i>Warm Roof Eaves Detail</i>		<input checked="" type="checkbox"/>
DTSW012	Warm Roof Eaves Detail Eaves Overhang Over Door or Window Opening • <i>Warm Roof Eaves Detail</i>		<input checked="" type="checkbox"/>
DTSW013	Warm Roof Eaves Detail Eaves Gutter and Bracket for Gutter Calculation • <i>Warm Roof Eaves Detail</i>		<input checked="" type="checkbox"/>
DTSW014	Warm Roof Eaves Detail Internal Box Gutter • <i>Warm Roof Eaves Detail at Internal Box Gutter</i>		<input checked="" type="checkbox"/>
DTSW015	Warm Roof Eaves Detail Parapet Box Gutter • <i>Warm Roof Eaves Detail</i>		<input checked="" type="checkbox"/>
DTSW016	Warm Roof Eaves Detail at Dormer Window Head • <i>Warm Roof Eaves Detail at Dormer Window Head</i>		<input checked="" type="checkbox"/>
DTSW020	Warm Roof Hip Detail Using Ventilated 'D' Hip Ridge • <i>Hip detail Using 'D' Ridge</i>		<input checked="" type="checkbox"/>
DTSW021	Warm Roof Ridge Detail Ventilated 'D' Ridge Using Universal 'D' Ridge Ventilator • <i>Vented 'D' Ridge Detail</i>		<input checked="" type="checkbox"/>
DTSW022	Warm Roof Ridge Detail Using Ventilated Dd Ridge Vent Filler Unit		<input checked="" type="checkbox"/>
DTSW023	Warm Roof Ridge Detail Mono-Ridge With Decra D Ridge Vent Filler Unit		<input checked="" type="checkbox"/>
DTSW024	Warm Roof Ridge Detail Mono-Ridge With Universal Ridge Vent		<input checked="" type="checkbox"/>
DTSW030	Warm Roof Ridge Detail Mono-Ridge Mansard Roof , Unventilated • <i>Mono Ridge Mansard Roof Detail</i>		<input checked="" type="checkbox"/>
DTSW031	Warm Roof Ridge Detail Mono-Ridge Mansard Roof With Universal Ridge Vent • <i>Mono Ridge Mansard Roof Detail</i>		<input checked="" type="checkbox"/>
DTSW035	Warm Roof Valley Details • <i>Valley Detail using Lead on Ply Layboards</i> • <i>GRP Valley Detail</i>		<input checked="" type="checkbox"/>
DTSW040	Warm Roof Roof Ventilator • <i>Long Section through Roof Ventilator</i> • <i>Cross-Section Through Roof Ventilator</i>		<input checked="" type="checkbox"/>
DTSW050	Warm Roof Verge Detail using Decra Barge Cover • <i>Barge Detail</i> • <i>Isometric View</i> • <i>Barge Isometric Detail</i>		
DTSW051	Warm Roof Verge Detail using Decra Cloaked Verge Cap • <i>Barge Detail</i> • <i>Isometric View</i> • <i>Barge Isometric Detail</i>		<input checked="" type="checkbox"/>
DTSW052	Warm Roof Abutment Details with Secret Gutter • <i>Abutment detail with secret gutter detail at crown abutting vertical service</i> • <i>Abutment detail with secret gutter detail at valley abutting vertical surface</i>		

DTSW054	Warm Roof Abutment Details Without Side Flashing <ul style="list-style-type: none"> • <i>Abutment detail without side flashing detail at crown abutting vertical surface</i> • <i>Abutment detail without side flashing detail at valley abutting vertical surface</i> 		<input checked="" type="checkbox"/>
DTSW055	Warm Roof Raking Verge Detail <ul style="list-style-type: none"> • <i>Raking Verge Detail</i> • <i>Raking Verge Detail with Gutter</i> • <i>Cutaway Isometric to Raking Verge</i> 		<input checked="" type="checkbox"/>
DTSW056	Warm Roof Top Edge Abutment Details (Ventilated) <ul style="list-style-type: none"> • <i>Top Edge Abutment Detail, Using Universal Vent Unit</i> 		<input checked="" type="checkbox"/>
DTSW057	Warm Roof <ul style="list-style-type: none"> • <i>Flat roof top edge abutment detail</i> 		<input checked="" type="checkbox"/>
DTSW060	Warm Roof Mansard Roof Detail <ul style="list-style-type: none"> • <i>Mansard using Lead Flashing</i> • <i>Mansard using Top Course</i> 		<input checked="" type="checkbox"/>
DTSW061	Warm Roof Change in Pitch Details <ul style="list-style-type: none"> • <i>Detail at Change in Roof Pitch</i> 		<input checked="" type="checkbox"/>
DTSW070	Warm Roof Velux Rooflight Details <ul style="list-style-type: none"> • <i>Typical Section</i> • <i>Aluminium Soaker Isometric</i> • <i>Typical Cross Section</i> 		<input checked="" type="checkbox"/>

10° roof pitch minimum
24° roof pitch illustrated

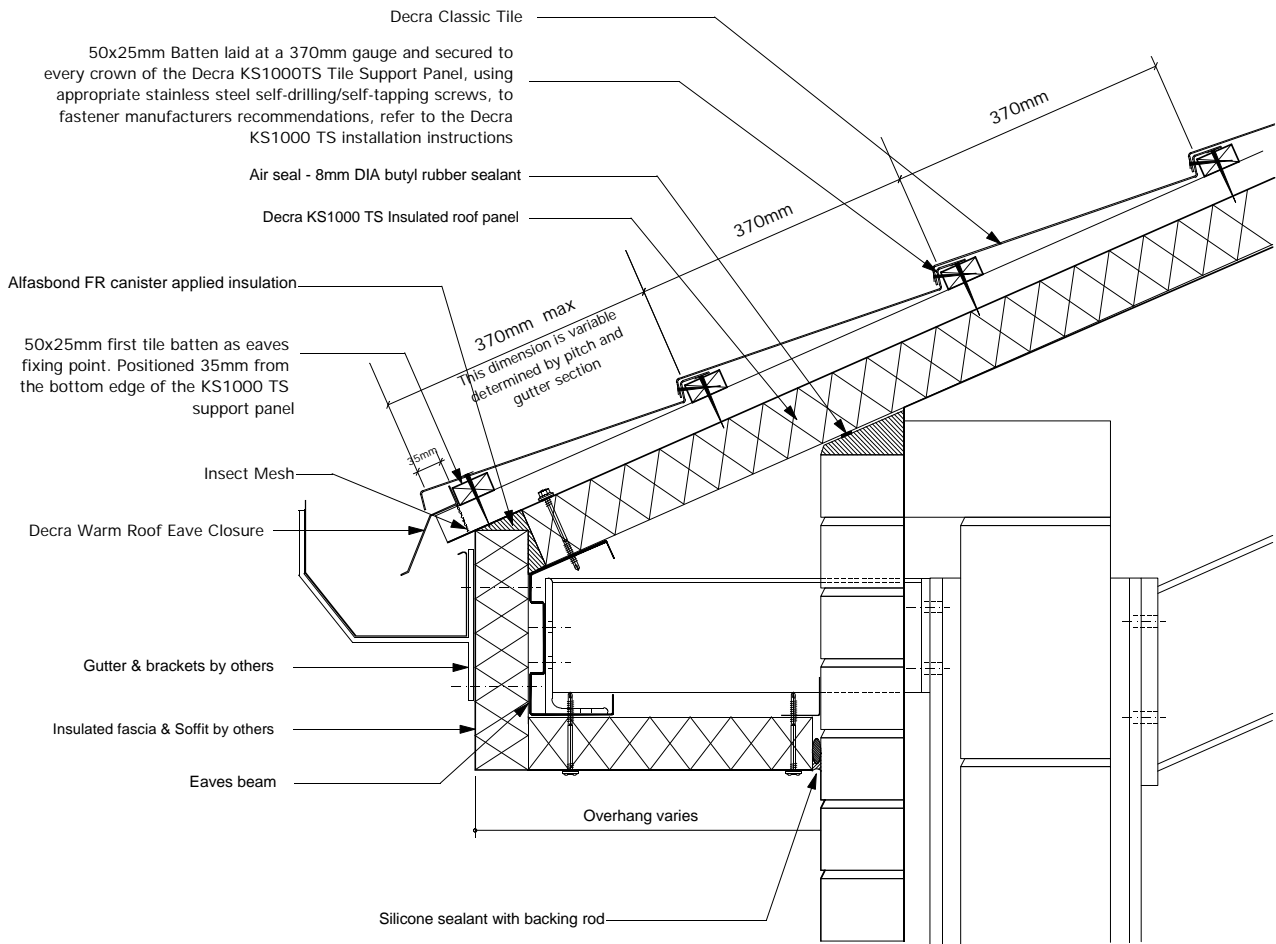

Warm Roof Eaves Detail
Scale 1:10

Notes:

This detail is to be read in conjunction with the instructions for the Decra KS1000 TS tile support system.

On eaves course of tile, the tiles are fixed vertically through the high point of the tile into the batten directly behind the fascia with Decra Nails. The nail heads to be covered with a finishing kit (supplied by Decra).



TS003

Decra[®]
Roof Systems Limited

A member of the Icopal Group



Unit 4
Crompton Fields
Crompton Way
Crawley
West Sussex
RH10 9QB

telephone: (01293) 545058/9
fax: (01293) 562709

email: technical@decra.co.uk
web-Site: <http://www.decra.co.uk>

The copyright of this drawing and detail information belongs to Decra Roof Systems Limited. Reproduction or amendment outwith the terms of the licensing agreement by other parties is expressly forbidden.

DECRA CLASSIC

CONTENT **WARM ROOF EAVES DETAIL
EAVES OVERHANG WITH
INSULATED FASCIA AND SOFFIT**

DRAWING SCALE **1:10** DATE **04/11/03**

DRAWING NO **DTSW010** REVISION

10° roof pitch minimum
24° roof pitch illustrated

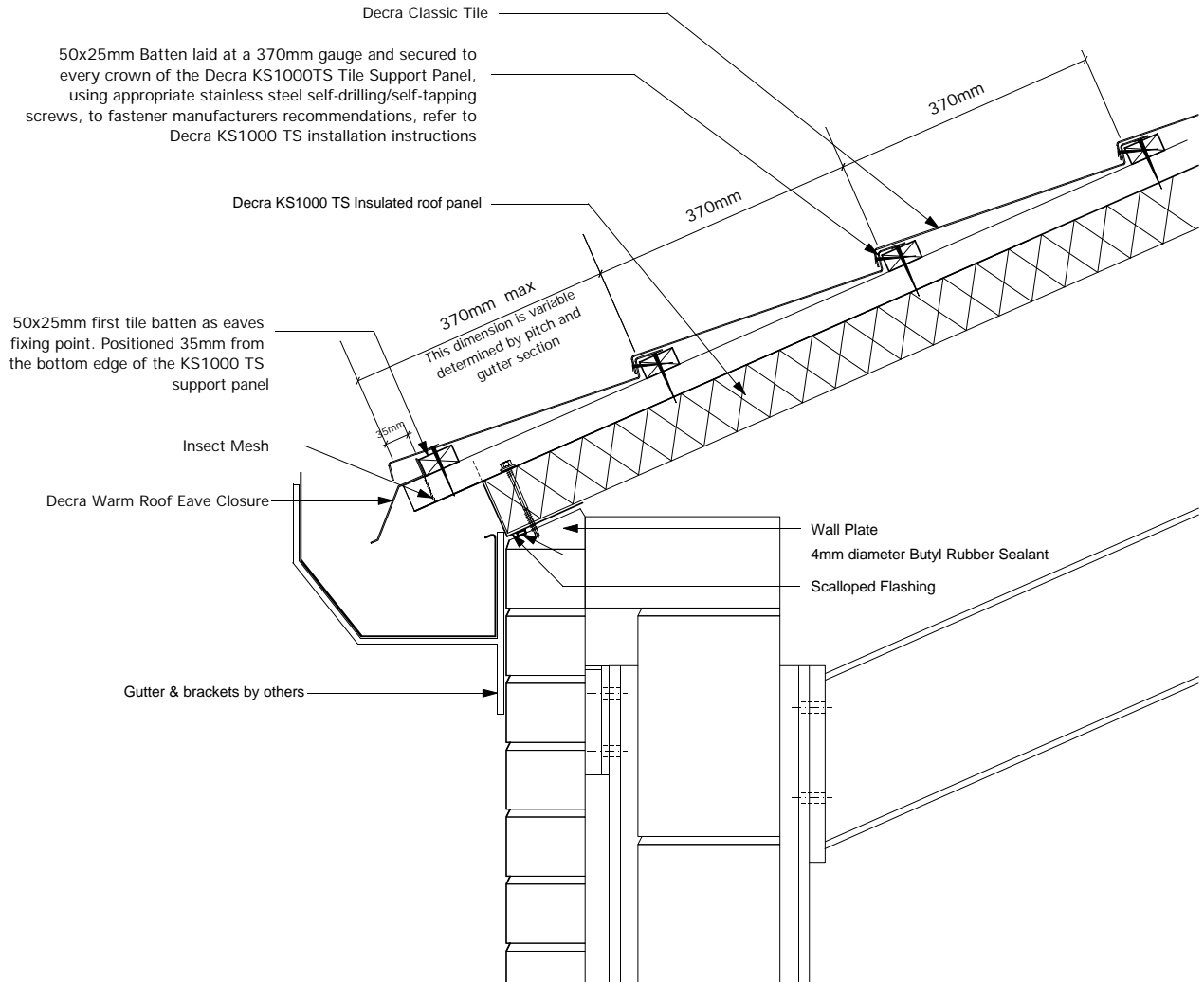

Warm Roof Eaves Detail
Scale 1:10

Notes:

This detail is to be read in conjunction with the instructions for the Decra KS1000 TS tile support system.

On eaves course of tile, the tiles are fixed vertically through the high point of the tile into the batten directly behind the fascia with Decra Nails. The nail heads to be covered with a finishing kit (supplied by Decra).



TS010

Decra®
Roof Systems Limited

A member of the Icopal Group



Unit 4
Crompton Fields
Crompton Way
Crawley
West Sussex
RH10 9QB

telephone: (01293) 545058/9
fax: (01293) 562709

email: technical@decra.co.uk
web-Site: <http://www.decra.co.uk>

The copyright of this drawing and detail information belongs to Decra Roof Systems Limited. Reproduction or amendment outwith the terms of the licensing agreement by other parties is expressly forbidden.

DECRA CLASSIC

CONTENT **WARM ROOF EAVES DETAIL
NO EAVES OVERHANG**

DRAWING SCALE **1:10**

DATE **04/11/03**

DRAWING NO **DTSW011**

REVISION

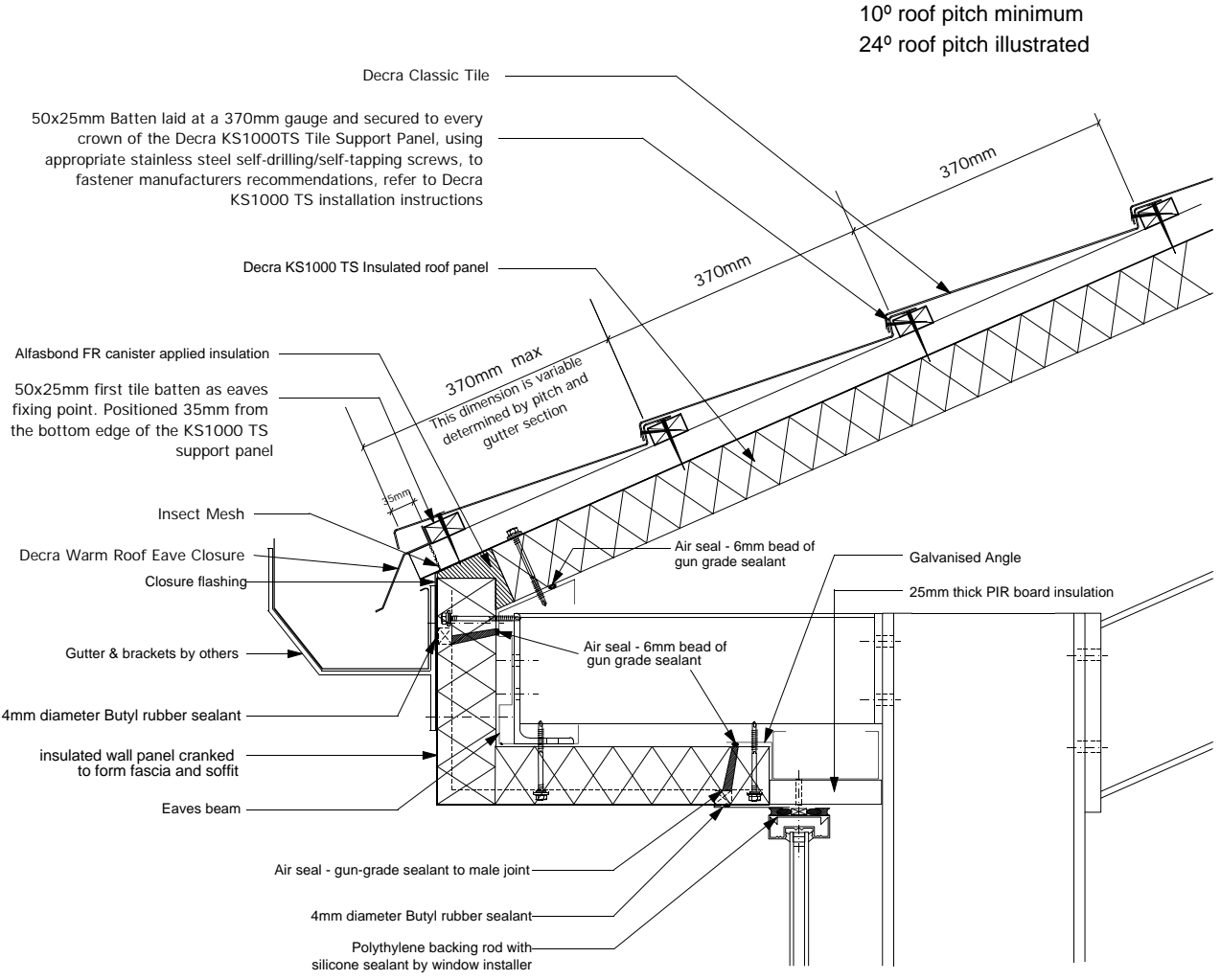

Warm Roof Eaves Detail
Scale 1:10

Notes:

This detail is to be read in conjunction with the instructions for the Decra KS1000 TS tile support system.

On eaves course of tile, the tiles are fixed vertically through the high point of the tile into the batten directly behind the fascia with Decra Nails. The nail heads to be covered with a finishing kit (supplied by Decra).



TS011

Decra[®]
Roof Systems Limited
A member of the Icopal Group



Unit 4
Crompton Fields
Crompton Way
Crawley
West Sussex
RH10 9QB

telephone: (01293) 545058/9
fax: (01293) 562709
email: technical@decra.co.uk
web-Site: <http://www.decra.co.uk>

The copyright of this drawing and detail information belongs to Decra Roof Systems Limited. Reproduction or amendment outwith the terms of the licensing agreement by other parties is expressly forbidden.

DECRA CLASSIC		
CONTENT	WARM ROOF EAVES DETAIL EAVES OVERHANG OVER DOOR OR WINDOW OPENING	
DRAWING SCALE	1:10	DATE 04/11/03
DRAWING NO	DTSW012	REVISION

10° roof pitch minimum
24° roof pitch illustrated

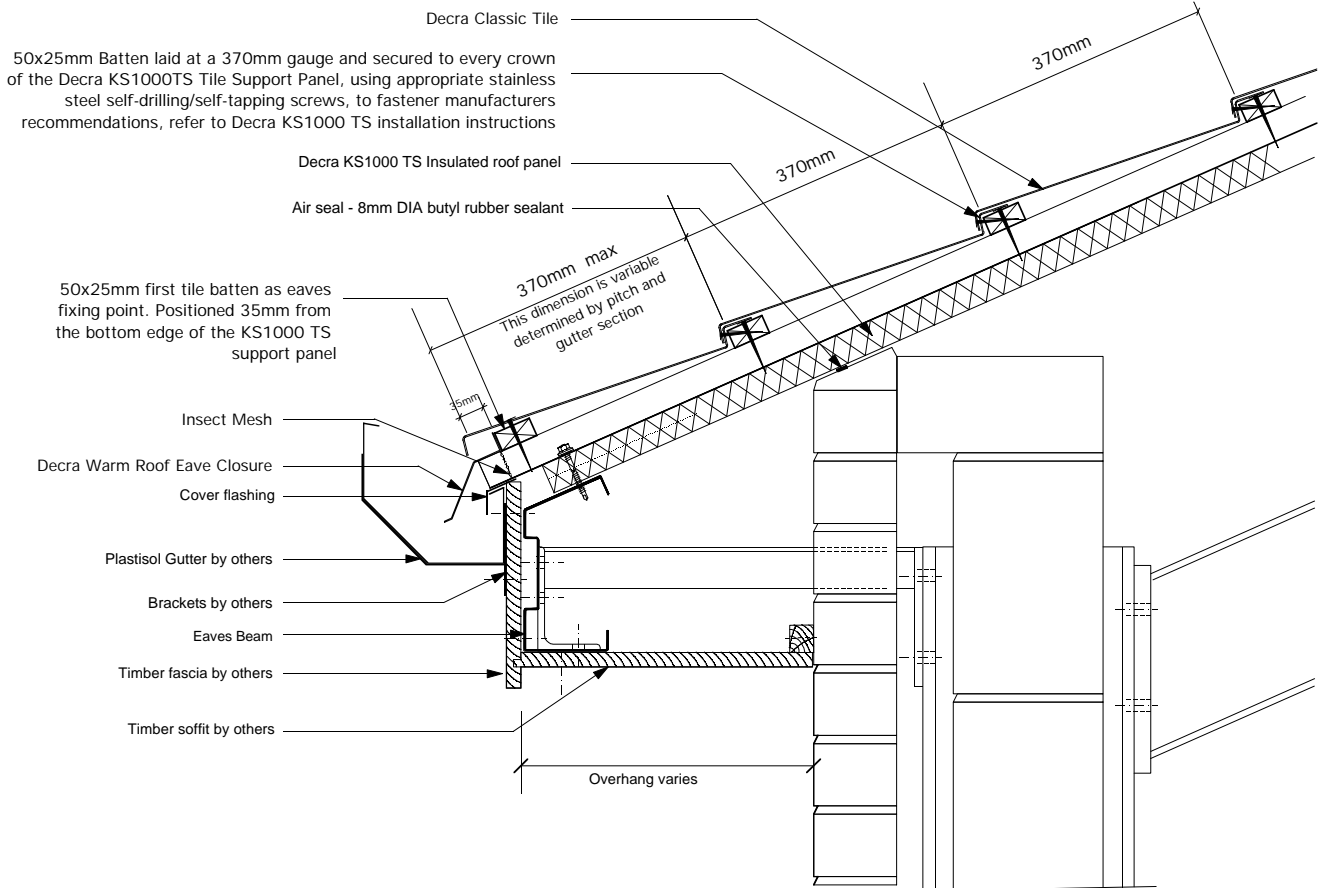

Warm Roof Eaves Detail
Scale 1:10

Notes:

This detail is to be read in conjunction with the instructions for the Decra KS1000 TS tile support system.

On eaves course of tile, the tiles are fixed vertically through the high point of the tile into the batten directly behind the fascia with Decra Nails. The nail heads to be covered with a finishing kit (supplied by Decra).



Decra[®]
Roof Systems Limited

A member of the Icopal Group



Unit 4
Crompton Fields
Crompton Way
Crawley
West Sussex
RH10 9QB

telephone: (01293) 545058/9

fax: (01293) 562709

email: technical@decra.co.uk

web-Site: <http://www.decra.co.uk>

The copyright of this drawing and detail information belongs to Decra Roof Systems Limited. Reproduction or amendment outwith the terms of the licensing agreement by other parties is expressly forbidden.

DECRA CLASSIC

CONTENT **WARM ROOF EAVES DETAIL
EAVES GUTTER AND BRACKET
FOR GUTTER CALCULATION**

DRAWING SCALE **1:10**

DATE **04/11/03**

DRAWING NO **DTSW013**

REVISION

10° roof pitch minimum
24° roof pitch illustrated

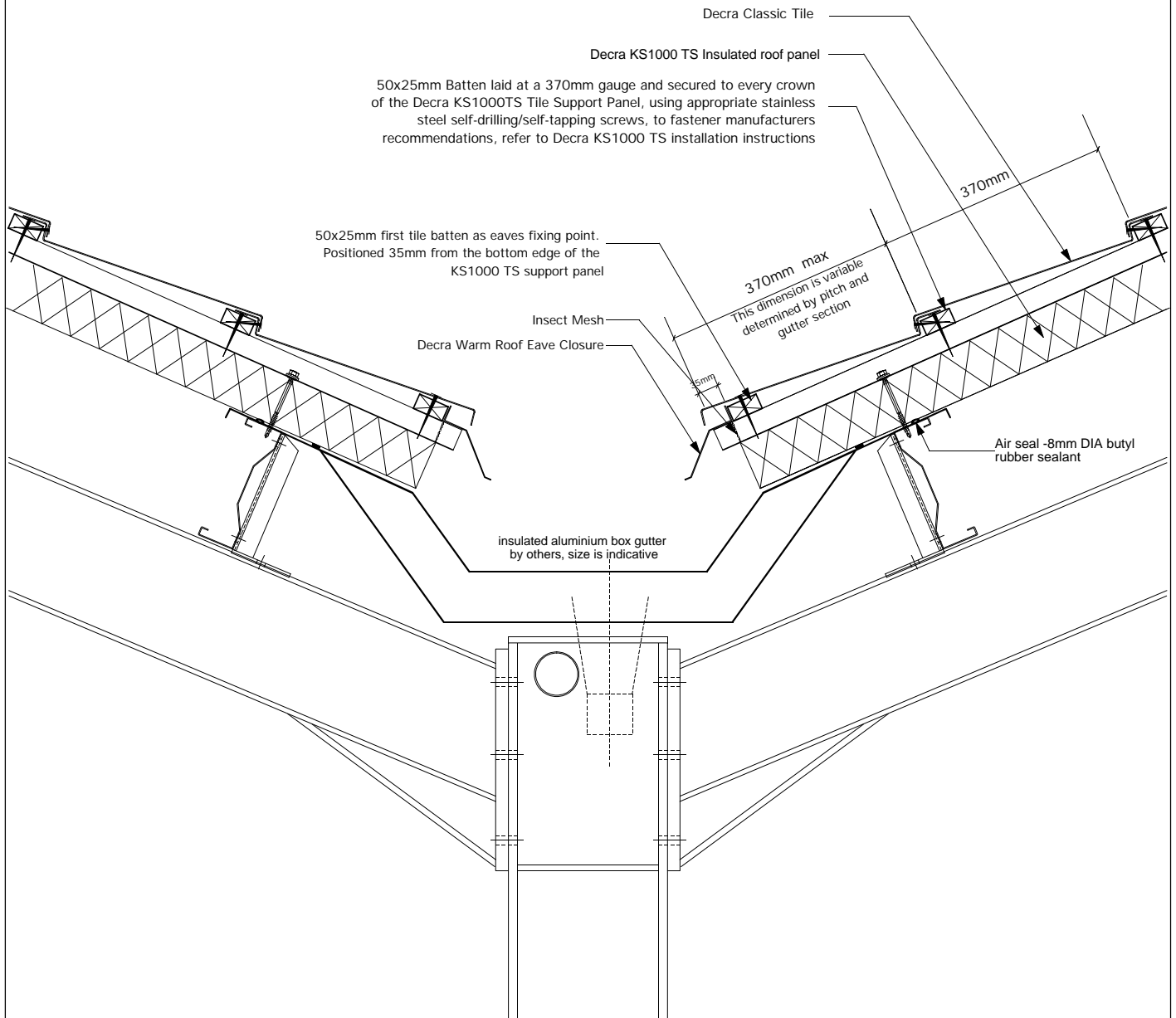

Warm Roof Eaves Detail at internal box gutter
Scale 1:10

Notes:

This detail is to be read in conjunction with the instructions for the Decra KS1000 TS tile support system.

On eaves course of tile, the tiles are fixed vertically through the high point of the tile into the batten directly behind the fascia with Decra Nails. The nail heads to be covered with a finishing kit (supplied by Decra).



TS009

Decra®
Roof Systems Limited

A member of the Icopal Group



Unit 4
Crompton Fields
Crompton Way
Crawley
West Sussex
RH10 9QB

telephone: (01293) 545058/9
fax: (01293) 562709

email: technical@decra.co.uk
web-Site: <http://www.decra.co.uk>

The copyright of this drawing and detail information belongs to Decra Roof Systems Limited. Reproduction or amendment outwith the terms of the licensing agreement by other parties is expressly forbidden.

DECRA CLASSIC

**WARM ROOF EAVES DETAIL
INTERNAL BOX GUTTER**

CONTENT	WARM ROOF EAVES DETAIL INTERNAL BOX GUTTER	
DRAWING SCALE	1:10	DATE 04/11/03
DRAWING NO	DTSW014	REVISION

10° roof pitch minimum
24° roof pitch illustrated

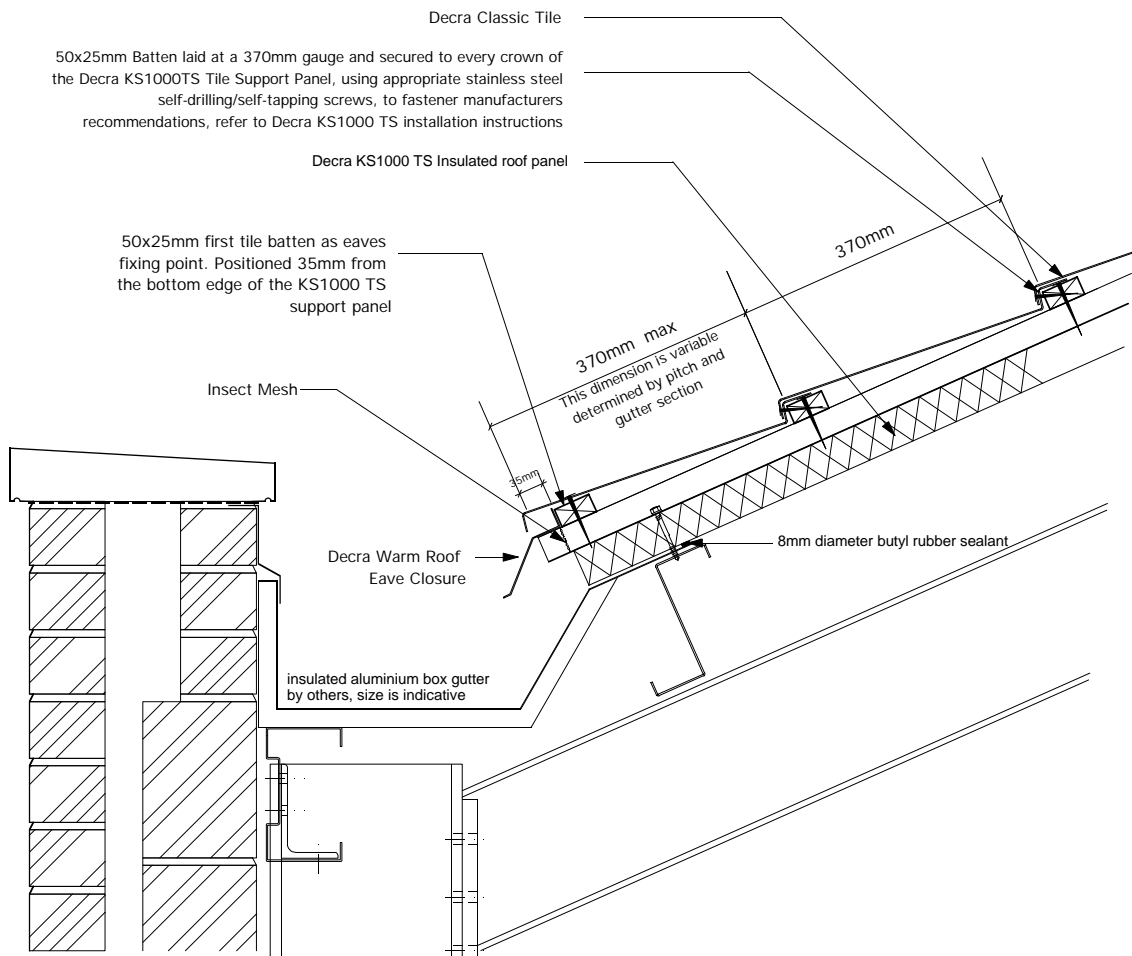

Warm Roof Eaves Detail
Scale 1:10

Notes:

This detail is to be read in conjunction with the instructions for the Decra KS1000 TS tile support system.

On eaves course of tile, the tiles are fixed vertically through the high point of the tile into the batten directly behind the fascia with Decra Nails. The nail heads to be covered with a finishing kit (supplied by Decra).



TS018

Decra[®]
Roof Systems Limited

A member of the Icopal Group



Unit 4
Crompton Fields
Crompton Way
Crawley
West Sussex
RH10 9QB

telephone: (01293) 545058/9
fax: (01293) 562709

email: technical@decra.co.uk
web-Site: <http://www.decra.co.uk>

The copyright of this drawing and detail information belongs to Decra Roof Systems Limited. Reproduction or amendment outwith the terms of the licensing agreement by other parties is expressly forbidden.

DECRA CLASSIC

CONTENT

**WARM ROOF EAVES DETAIL
PARAPET BOX GUTTER**

DRAWING SCALE

1:10

DATE

04/11/03

DRAWING NO

DTSW015

REVISION

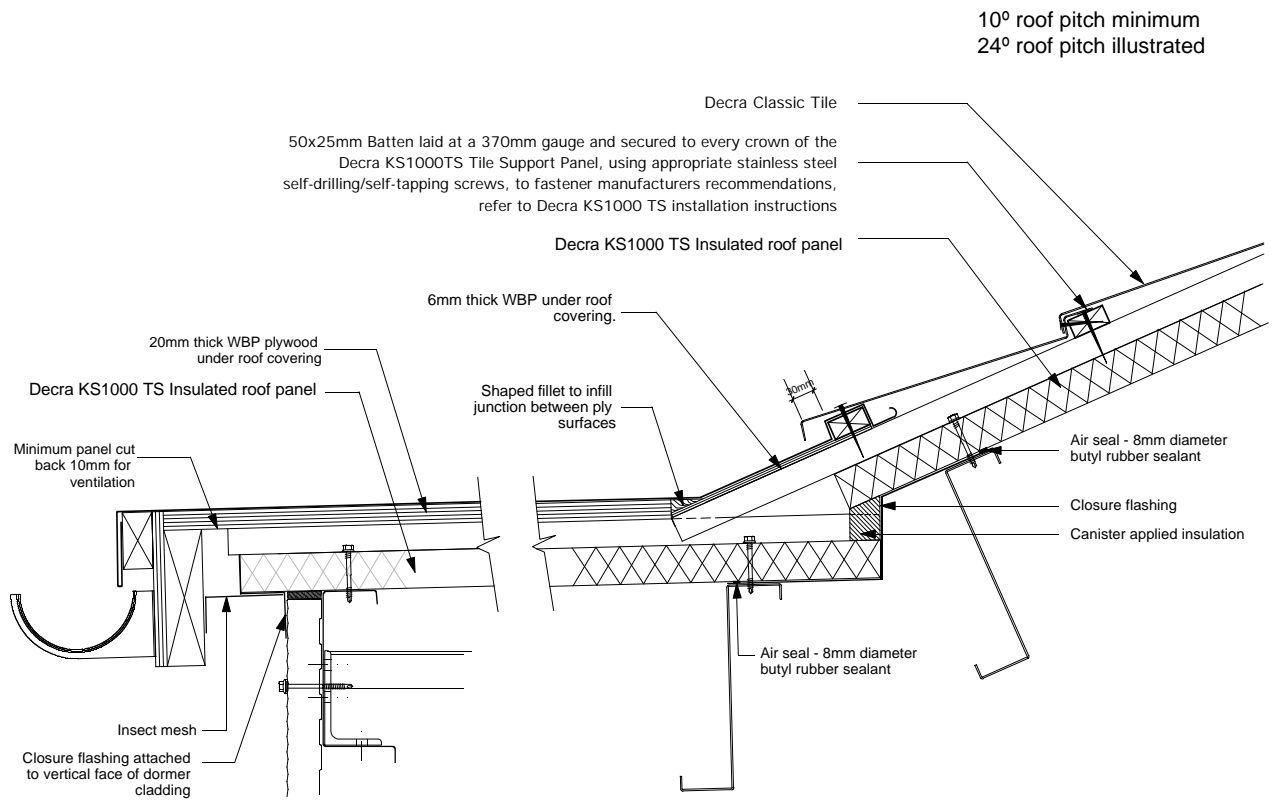

Warm Roof Eaves Detail at dormer window head

Scale 1:10

Notes:

This detail is to be read in conjunction with the instructions for the Decra KS1000 TS tile support system.

On eaves course of tile, the tiles are fixed vertically through the high point of the tile into the batten directly behind the fascia with Decra Nails. The nail heads to be covered with a finishing kit (supplied by Decra).



TS020

Decra[®]
Roof Systems Limited

A member of the Icopal Group



Unit 4
Crompton Fields
Crompton Way
Crawley
West Sussex
RH10 9QB

telephone: (01293) 545058/9

fax: (01293) 562709

email: technical@decra.co.uk

web-Site: <http://www.decra.co.uk>

The copyright of this drawing and detail information belongs to Decra Roof Systems Limited. Reproduction or amendment outwith the terms of the licensing agreement by other parties is expressly forbidden.

DECRA CLASSIC

CONTENT

**WARM ROOF EAVES DETAIL
AT DORMER WINDOW HEAD**

DRAWING SCALE

1:10

DATE

04/11/03

DRAWING NO

DTSW016

REVISION

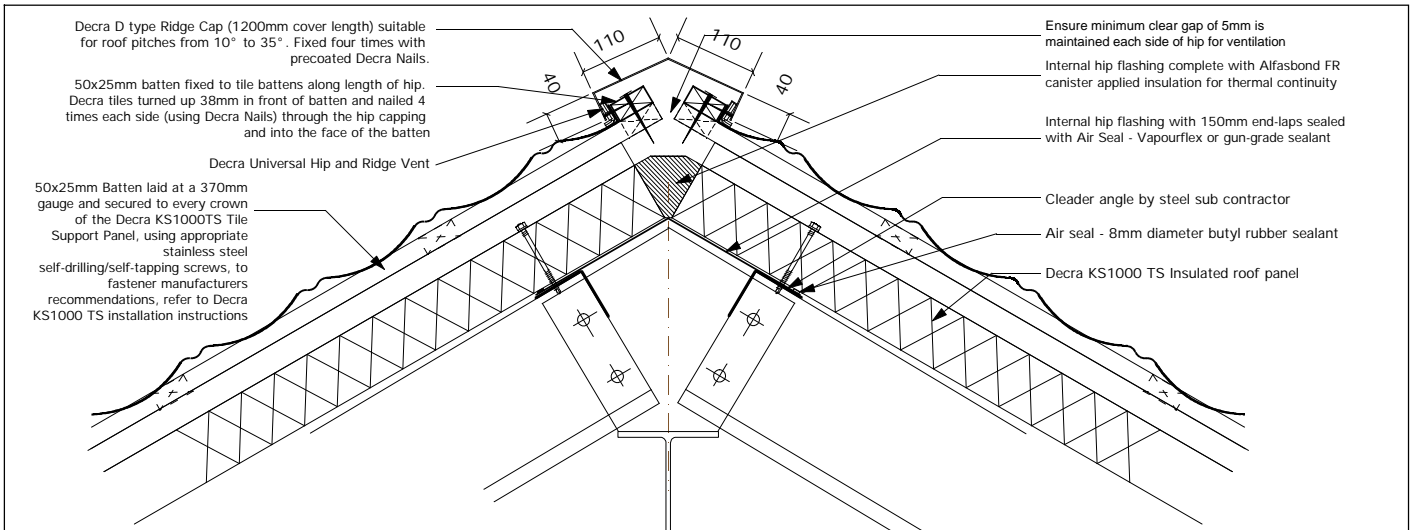

Decra D type Ridge Cap (1200mm cover length) suitable for roof pitches from 10° to 35°. Fixed four times with pre-coated Decra Nails.

50x25mm batten fixed to tile battens along length of hip. Decra tiles turned up 38mm in front of batten and nailed 4 times each side (using Decra Nails) through the hip capping and into the face of the batten

Ensure minimum clear gap of 5mm is maintained each side of hip for ventilation

Internal hip flashing complete with Alfasbond FR canister applied insulation for thermal continuity

Internal hip flashing with 150mm end-laps sealed with Air Seal - Vapourflex or gun-grade sealant

Decra Universal Hip and Ridge Vent

50x25mm Batten laid at a 370mm gauge and secured to every crown of the Decra KS1000TS Tile Support Panel, using appropriate stainless steel self-drilling/self-tapping screws, to fastener manufacturers recommendations, refer to Decra KS1000 TS installation instructions

Cleader angle by steel sub contractor

Air seal - 8mm diameter butyl rubber sealant

Decra KS1000 TS Insulated roof panel

Hip Detail Using Decra 'D' Ridge

Scale 1:10

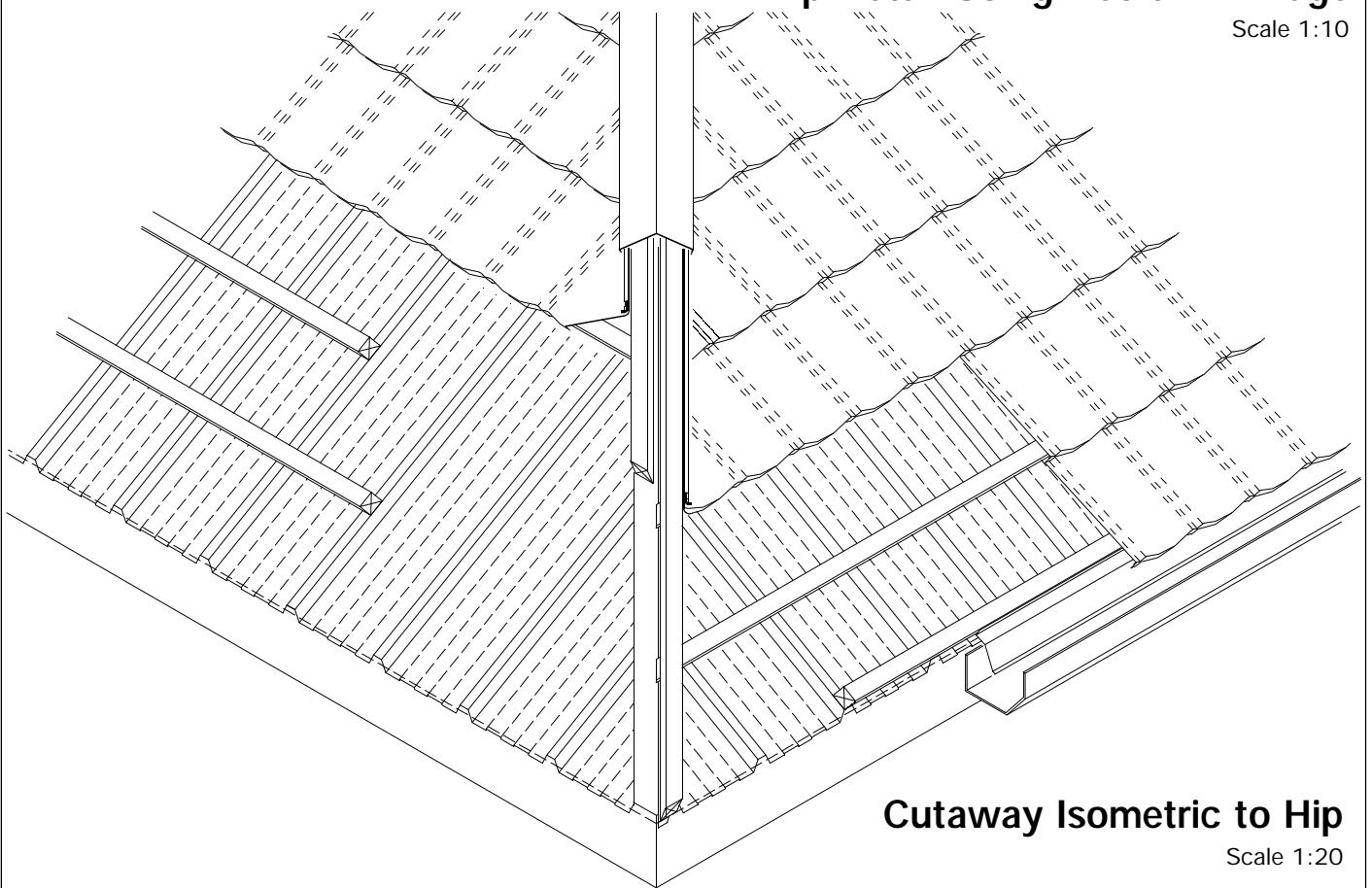

Cutaway Isometric to Hip

Scale 1:20

Notes:

This detail is to be read in conjunction with the instructions for the Decra KS1000 TS tile support system.

Decra 'D' Ridge Hip End Closure Units are available

TS004

Decra[®]
Roof Systems Limited

A member of the Icopal Group



Unit 4
Crompton Fields
Crompton Way
Crawley
West Sussex
RH10 9QB

telephone: (01293) 545058/9
fax: (01293) 562709

email: technical@decra.co.uk
web-Site: <http://www.decra.co.uk>

The copyright of this drawing and detail information belongs to Decra Roof Systems Limited. Reproduction or amendment outwith the terms of the licensing agreement by other parties is expressly forbidden.

DECRA CLASSIC

CONTENT

**WARM ROOF HIP DETAIL
USING VENTILATED 'D' HIP RIDGE**

DRAWING SCALE **1:10**

DATE **04/11/03**

DRAWING NO **DTSW020**

REVISION

10° minimum
24° illustrated

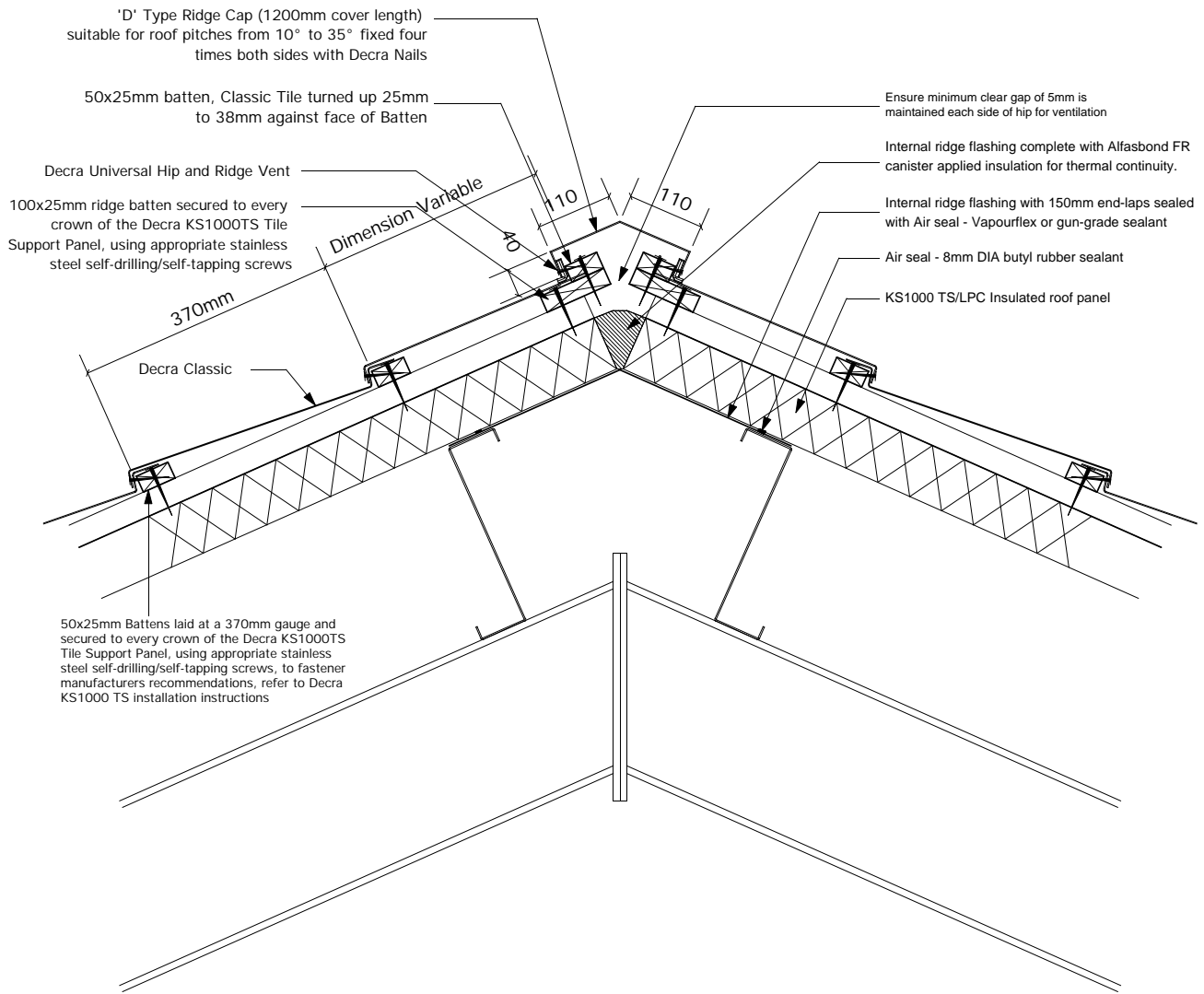

Vented 'D' Ridge Detail
Scale 1:10

Notes:

This detail is to be read in conjunction with the instructions for the Decra KS1000 TS tile support system.

TS002

Decra®
Roof Systems Limited

A member of the Icopal Group



Unit 4
Crompton Fields
Crompton Way
Crawley
West Sussex
RH10 9QB

telephone: (01293) 545058/9
fax: (01293) 562709

email: technical@decra.co.uk
web-Site: <http://www.decra.co.uk>

The copyright of this drawing and detail information belongs to Decra Roof Systems Limited. Reproduction or amendment outwith the terms of the licensing agreement by other parties is expressly forbidden.

DECRA CLASSIC

CONTENT **WARM ROOF RIDGE DETAIL
VENTILATED 'D' RIDGE
USING UNIVERSAL 'D' RIDGE VENTILATOR**

DRAWING SCALE **1:10** DATE **04/11/03**

DRAWING NO **DTSW021** REVISION

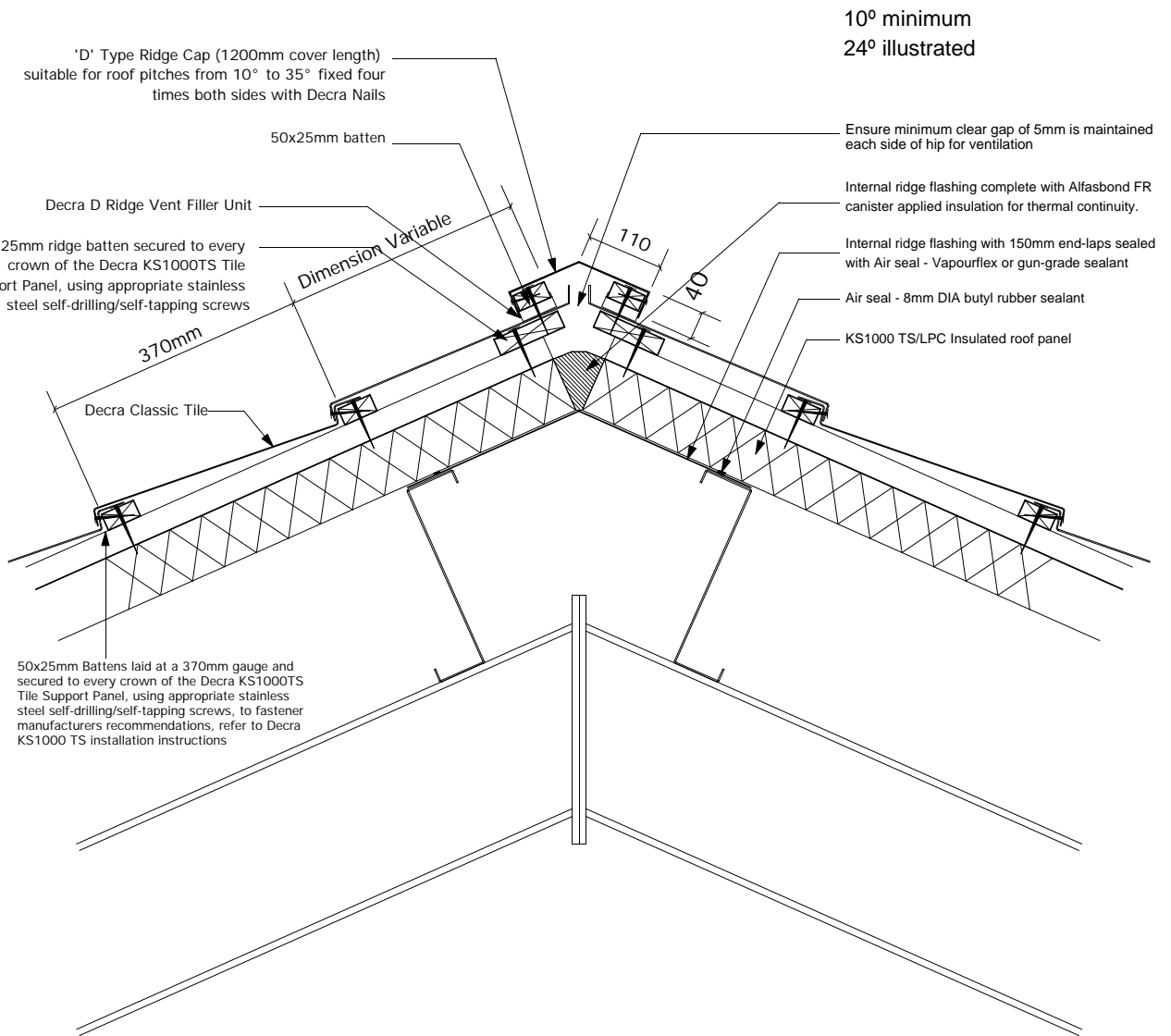

Vented 'D' Ridge Detail
Scale 1:10

Notes:

This detail is to be read in conjunction with the
instructions for the Decra KS1000 TS tile support
system.

TS002

Decra®
Roof Systems Limited

A member of the Icopal Group



Unit 4
Crompton Fields
Crompton Way
Crawley
West Sussex
RH10 9PX

telephone: (01293) 545058/9
fax: (01293) 562709

email: technical@decra.co.uk
web-Site: <http://www.decra.co.uk>

The copyright of this drawing and
detail information belongs to Decra
Roof Systems Limited. Reproduction
or amendment outwith the terms of
the licensing agreement by other
parties is expressly forbidden.

DECRA CLASSIC

CONTENT **WARM ROOF RIDGE DETAIL
VENTILATED 'D' RIDGE
USING DECRA 'D' RIDGE VENT FILLER UNIT**

DRAWING SCALE **1:10**

DATE **04/11/03**

DRAWING NO **DTSW022**

REVISION

10° minimum
24° illustrated

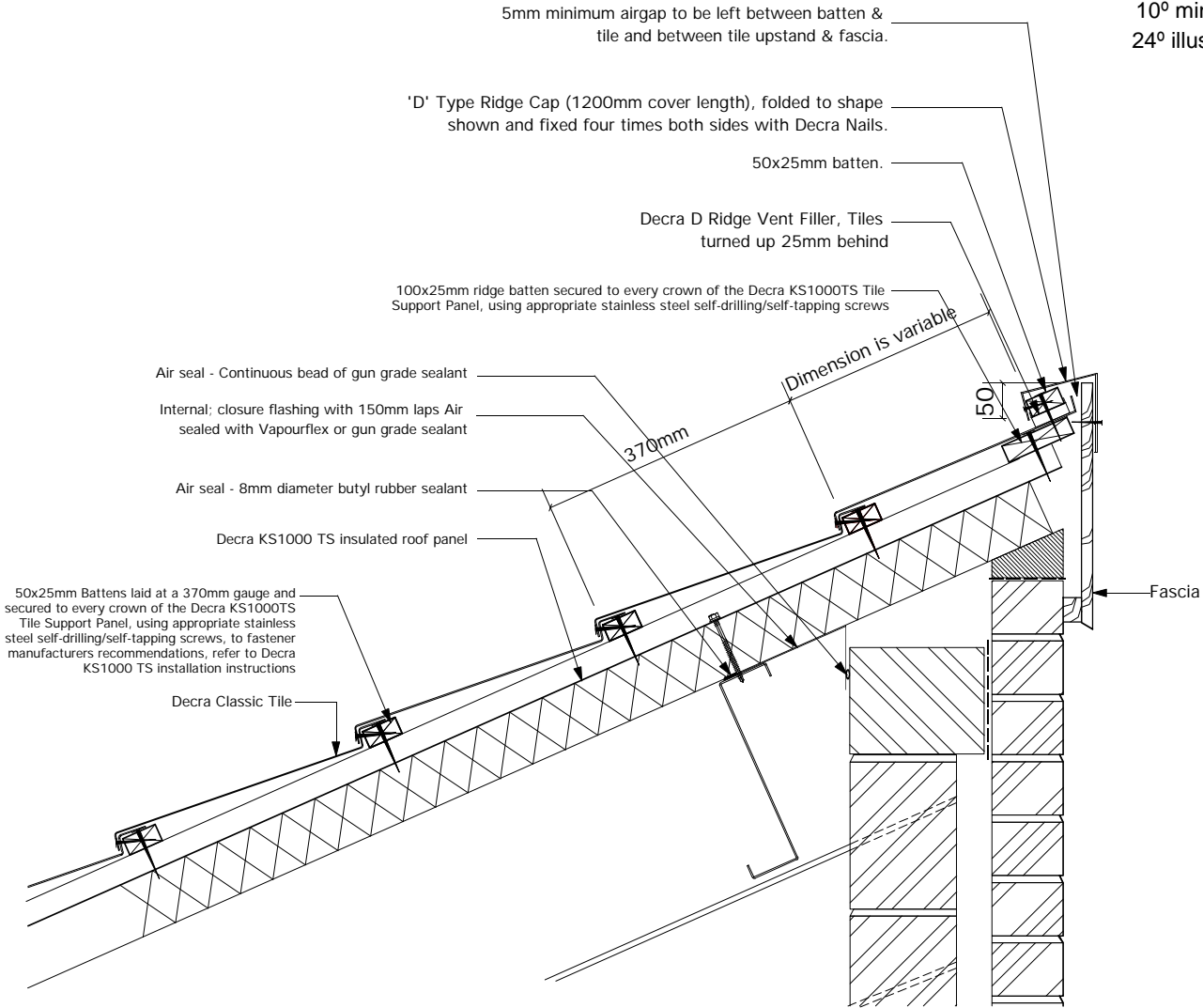

Mono Ridge Detail
Scale 1:10

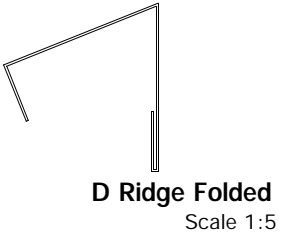

Notes:

This detail is to be read in conjunction with the instructions for the Decra KS1000 TS tile support system.

TS007

Decra[®]
Roof Systems Limited
A member of the Icopal Group



Unit 4
Crompton Fields
Crompton Way
Crawley
West Sussex
RH10 9QB

telephone: (01293) 545058/9
fax: (01293) 562709
email: technical@decra.co.uk
web-Site: <http://www.decra.co.uk>

The copyright of this drawing and detail information belongs to Decra Roof Systems Limited. Reproduction or amendment outwith the terms of the licensing agreement by other parties is expressly forbidden.

DECRA CLASSIC		
CONTENT		
WARM ROOF RIDGE DETAIL MONO-RIDGE WITH DECRA RIDGE VENT FILLER UNIT		
DRAWING SCALE	1:10	DATE 04/11/03
DRAWING NO	DTSW023	REVISION

10° minimum
24° illustrated

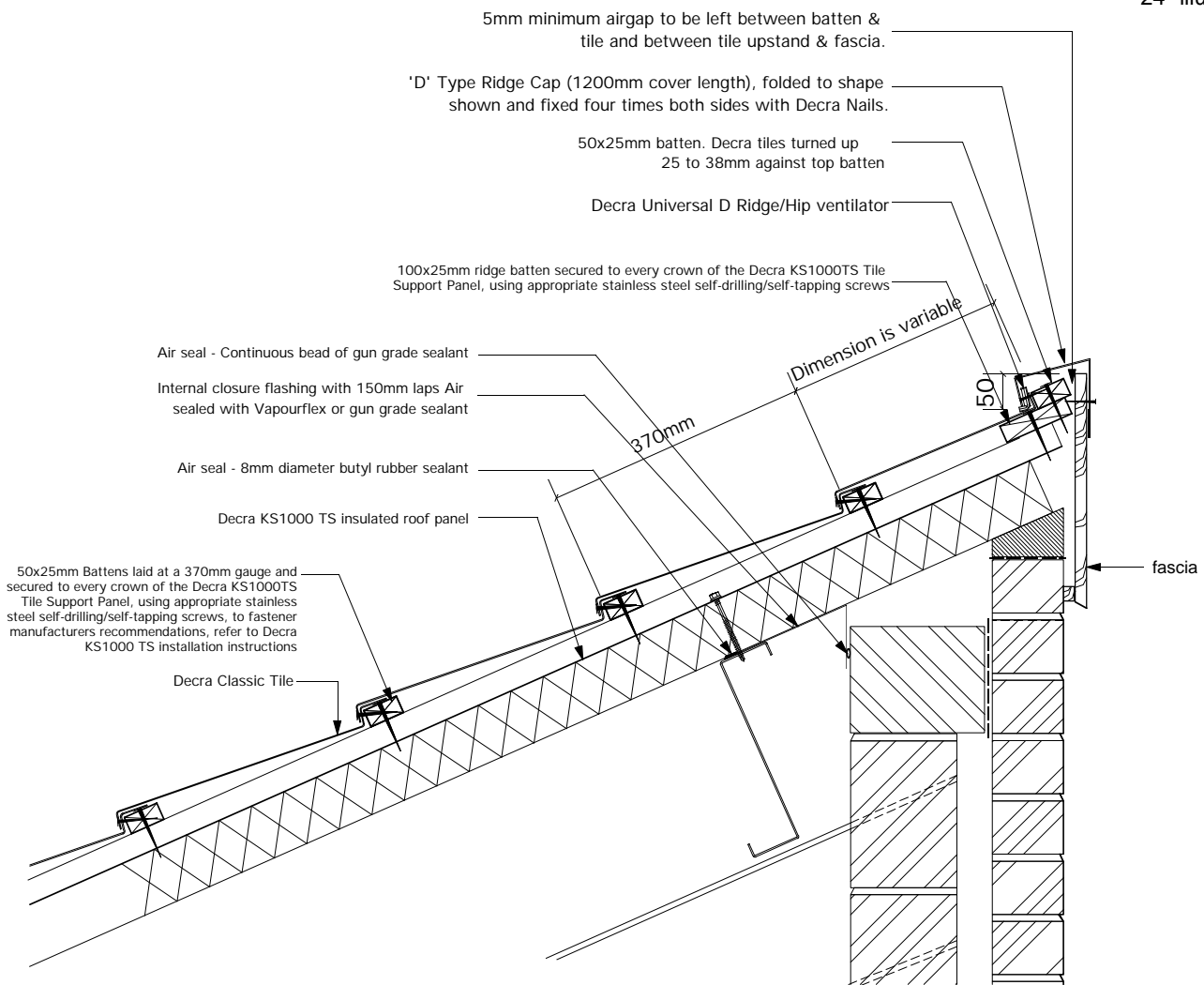

Mono Ridge Detail

Scale 1:10

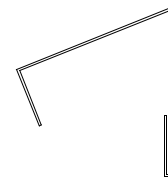

D Ridge Folded

Scale 1:5

Notes:

This detail is to be read in conjunction with the instructions for the Decra KS1000 TS tile support system.

TS007

Decra[®]
Roof Systems Limited

A member of the Icopal Group



Unit 4
Crompton Fields
Crompton Way
Crawley
West Sussex
RH10 9QB

telephone: (01293) 545058/9
fax: (01293) 562709

email: technical@decra.co.uk
web-Site: <http://www.decra.co.uk>

The copyright of this drawing and detail information belongs to Decra Roof Systems Limited. Reproduction or amendment outwith the terms of the licensing agreement by other parties is expressly forbidden.

DECRA CLASSIC

CONTENT

**WARM ROOF RIDGE DETAIL
MONO-RIDGE WITH DECRA UNIVERSAL
D RIDGE/HIP VENTILATOR**

DRAWING SCALE

1:10

DATE

04/11/03

DRAWING NO

DTSW024

REVISION

'D' Type Ridge Cap (1200mm cover length), folded to shape shown and fixed four times both sides with Decra Nails.

10° minimum
24° illustrated

50x25mm batten

100x25mm ridge batten secured to every crown of the Decra KS1000TS Tile Support Panel, using appropriate stainless steel self-drilling/self-tapping screws

Air seal - 8mm DIA butyl rubber sealant

Decra KS1000 TS insulated roof panel

Decra Classic Tile

50x25mm Battens laid at a 370mm gauge and secured to every crown of the Decra KS1000TS Tile Support Panel, using appropriate stainless steel self-drilling/self-tapping screws, to fastener manufacturers recommendations, refer to Decra KS1000 TS installation instructions

50

External Galv steel mono-ridge

Insect mesh

fascia

Min. 150mm lap

Alfasbond FR canister applied insulation

Internal mono ridge flashing complete with end-laps sealed with vapourflex or gun-grade sealant

Air seal - 8mm DIA butyl rubber sealant

insulated aluminium box gutter by others, size is indicative

Mono Ridge Mansard Roof Detail

Scale 1:10

Notes:

This detail is to be read in conjunction with the instructions for the Decra KS1000 TS tile support system.

TS008

Decra[®]
Roof Systems Limited

A member of the Icopal Group



Unit 4
Crompton Fields
Crompton Way
Crawley
West Sussex
RH10 9QB

telephone: (01293) 545058/9
fax: (01293) 562709

email: technical@decra.co.uk
web-Site: <http://www.decra.co.uk>

The copyright of this drawing and detail information belongs to Decra Roof Systems Limited. Reproduction or amendment outwith the terms of the licensing agreement by other parties is expressly forbidden.

DECRA CLASSIC

CONTENT

**WARM ROOF RIDGE DETAIL
MONO-RIDGE MANSARD ROOF**

DRAWING SCALE

1:10

DATE

04/11/03

DRAWING NO

DTSW030

REVISION

10° minimum
24° illustrated

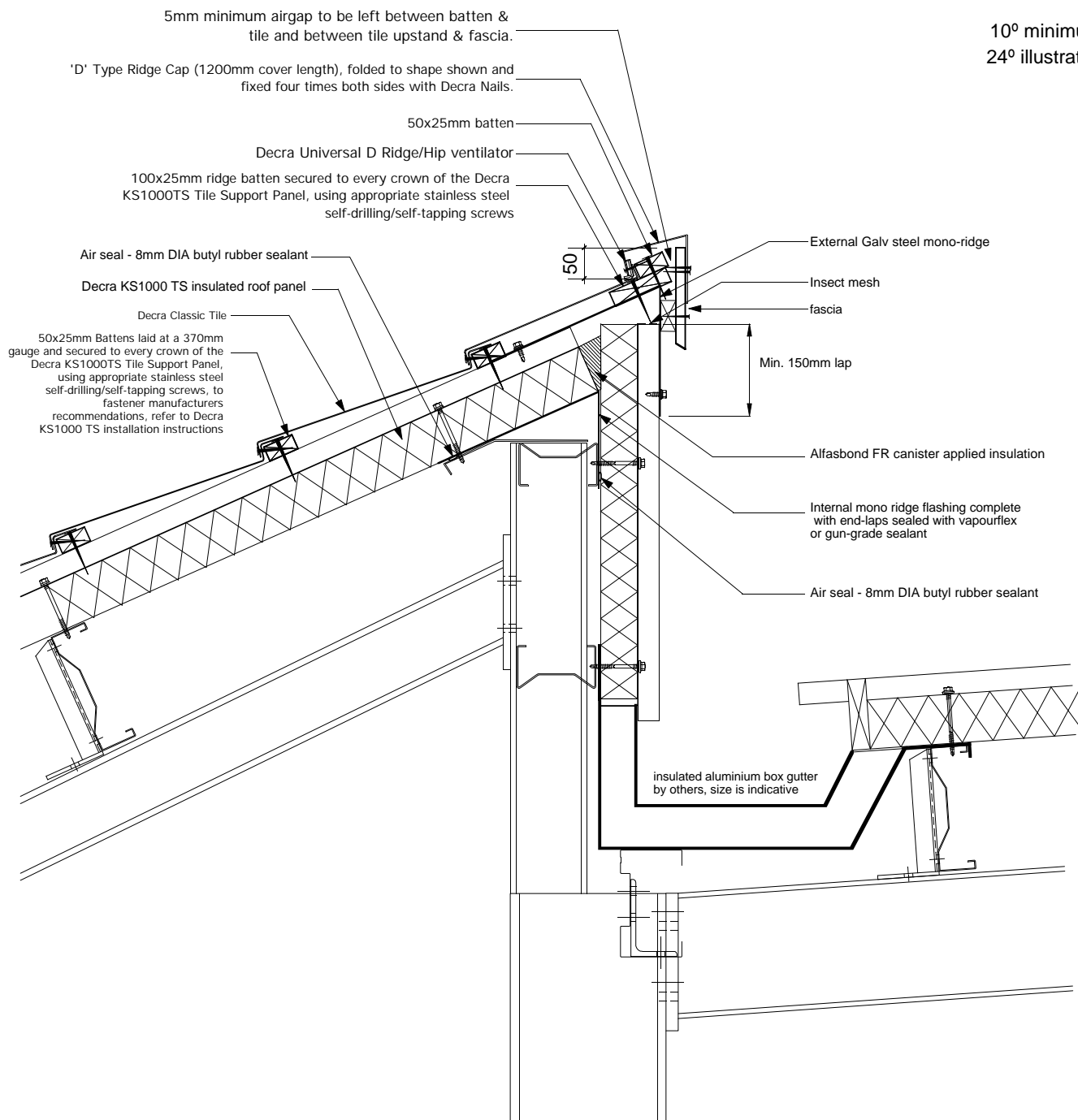

Mono Ridge Mansard Roof Detail
Scale 1:10

Notes:

This detail is to be read in conjunction with the instructions for the Decra KS1000 TS tile support system.

TS008

Decra®
Roof Systems Limited

A member of the Icopal Group



Unit 4
Crompton Fields
Crompton Way
Crawley
West Sussex
RH10 9QB

telephone: (01293) 545058/9
fax: (01293) 562709

email: technical@decra.co.uk
web-Site: <http://www.decra.co.uk>

The copyright of this drawing and detail information belongs to Decra Roof Systems Limited. Reproduction or amendment outwith the terms of the licensing agreement by other parties is expressly forbidden.

DECRA CLASSIC

CONTENT
**WARM ROOF RIDGE DETAIL
MONO-RIDGE MANSARD ROOF
WITH DECRA UNIVERSAL RIDGE VENT**

DRAWING SCALE
1:10

DATE
04/11/03

DRAWING NO
DTSW031

REVISION

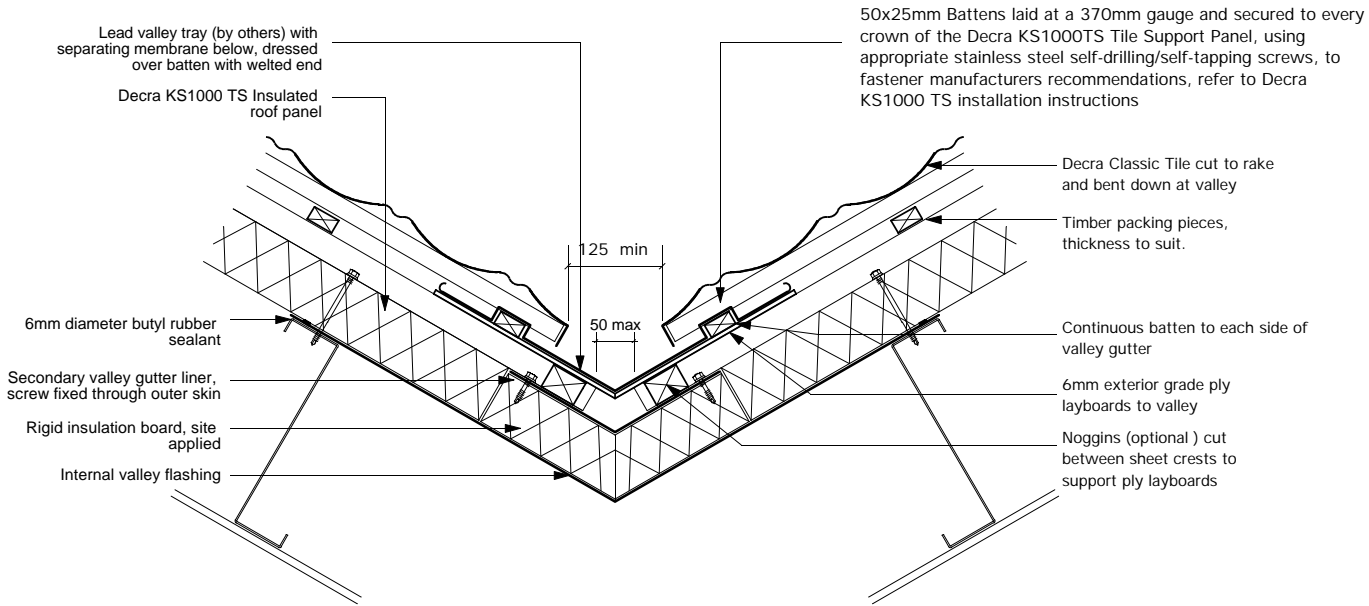

Valley Detail using lead on ply layboards

Scale 1:10

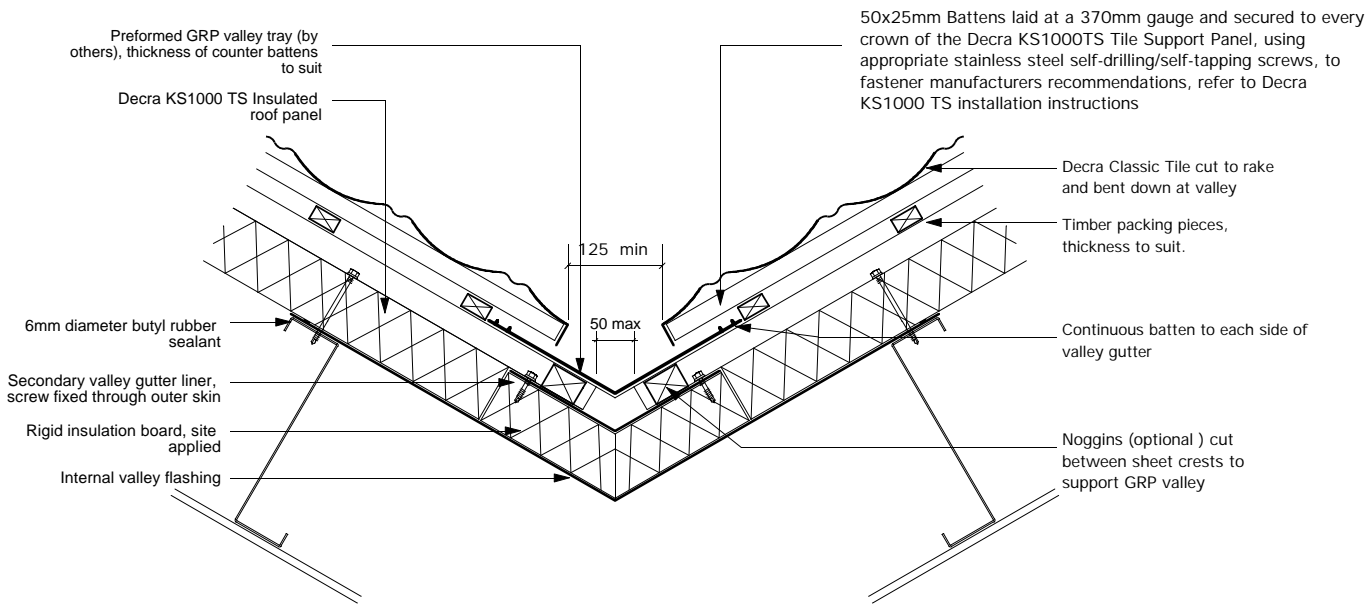

GRP Valley Detail

Scale 1:10

Notes:

This detail is to be read in conjunction with the instructions for the Decra KS1000 TS tile support system.

Valley gutter sizes to be adjusted as required to comply with calculated width requirements of Code Of Practice as set out in BS 5534: Part1

The timber packing pieces are used to raise the tiling battens above the level of the rafters to create an upstand for the valley tray, and should be reduced from minimum 19mm thick across three or more sheet crests to avoid a visible rise in the tiling.

TS---

Decra[®]
Roof Systems Limited
A member of the Icopal Group



Unit 4
Crompton Fields
Crompton Way
Crawley
West Sussex
RH10 9QB

telephone: (01293) 545058/9
fax: (01293) 562709
email: technical@decra.co.uk
web-Site: <http://www.decra.co.uk>

The copyright of this drawing and detail information belongs to Decra Roof Systems Limited. Reproduction or amendment outwith the terms of the licensing agreement by other parties is expressly forbidden.

DECRA CLASSIC		
CONTENT	WARM ROOF VALLEY DETAILS	
DRAWING SCALE	1:10	DATE 04/11/03
DRAWING NO	DTSW035	REVISION

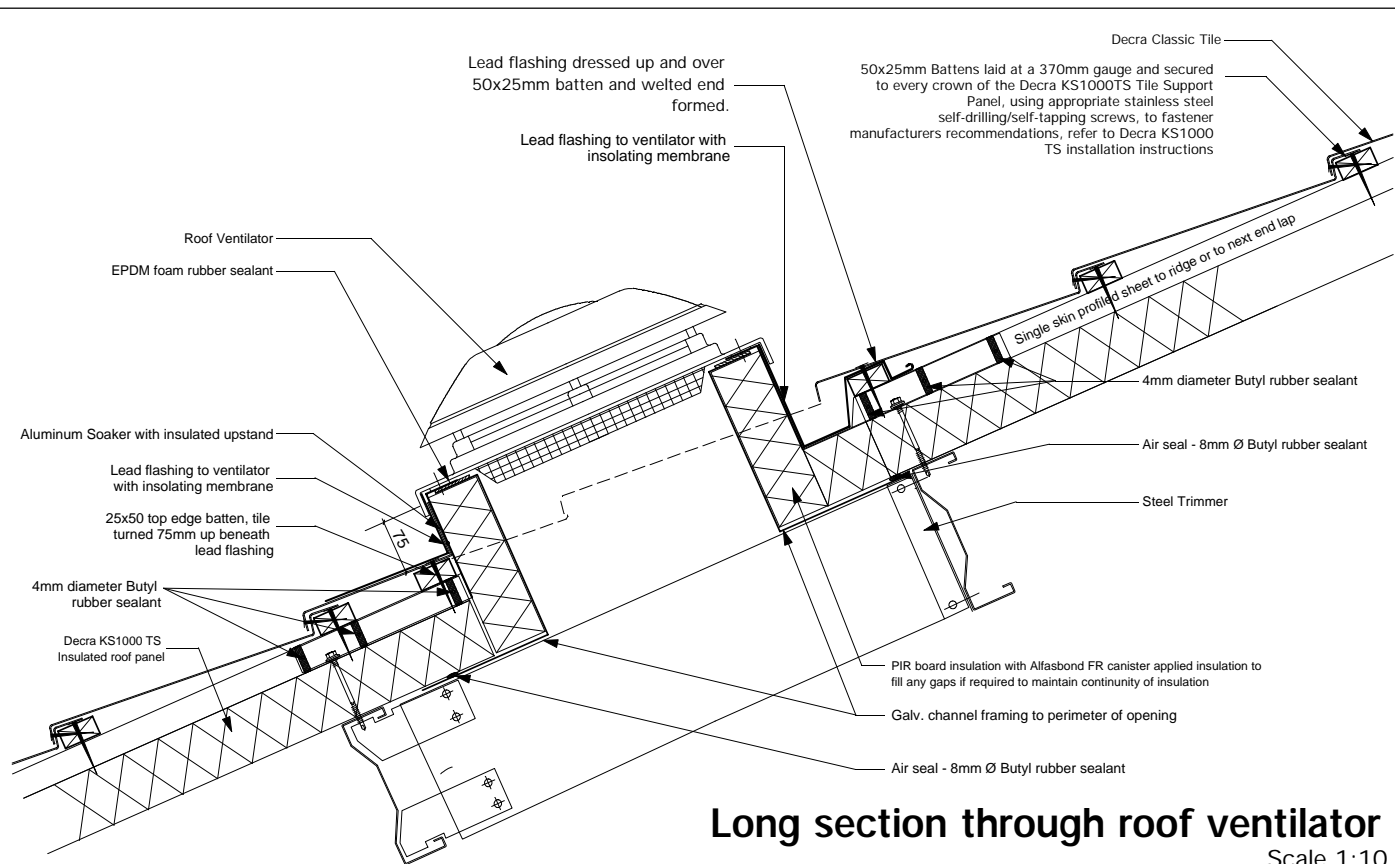

Long section through roof ventilator

Scale 1:10

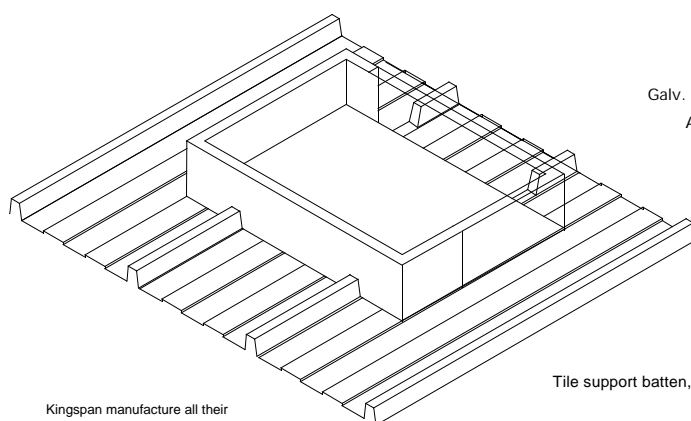

Kingspan manufacture all their upstands in aluminium and postpaint to matching roof colour.
Note: correct, width, length & upstand lip should be specified

Isometric of upstand flashing
not to scale

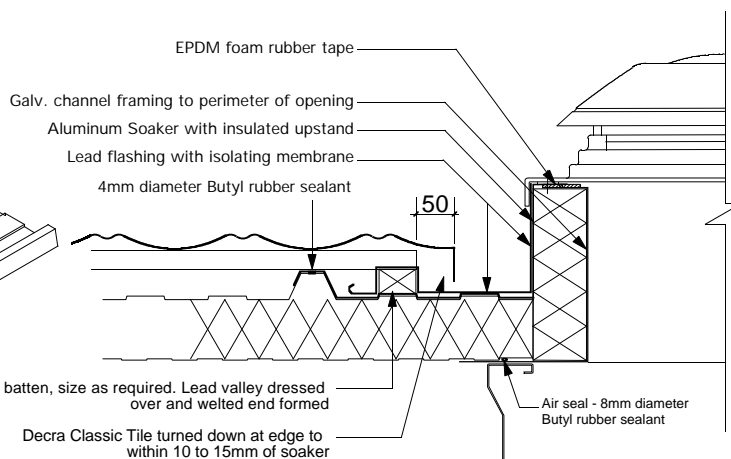

Cross-section through roof ventilator

Scale 1:10

Notes:

This detail is to be read in conjunction with the instructions for the Decra KS1000 TS tile support system.

TS014

Decra[®]
Roof Systems Limited

A member of the Icopal Group



Unit 4
Crompton Fields
Crompton Way
Crawley
West Sussex
RH10 9QB

telephone: (01293) 545058/9
fax: (01293) 562709

email: technical@decra.co.uk
web-Site: <http://www.decra.co.uk>

The copyright of this drawing and detail information belongs to Decra Roof Systems Limited. Reproduction or amendment outwith the terms of the licensing agreement by other parties is expressly forbidden.

DECRA CLASSIC

CONTENT

**WARM ROOF
ROOF VENTILATOR**

DRAWING SCALE

1:10

DATE

04/11/03

DRAWING NO

DTSW040

REVISION

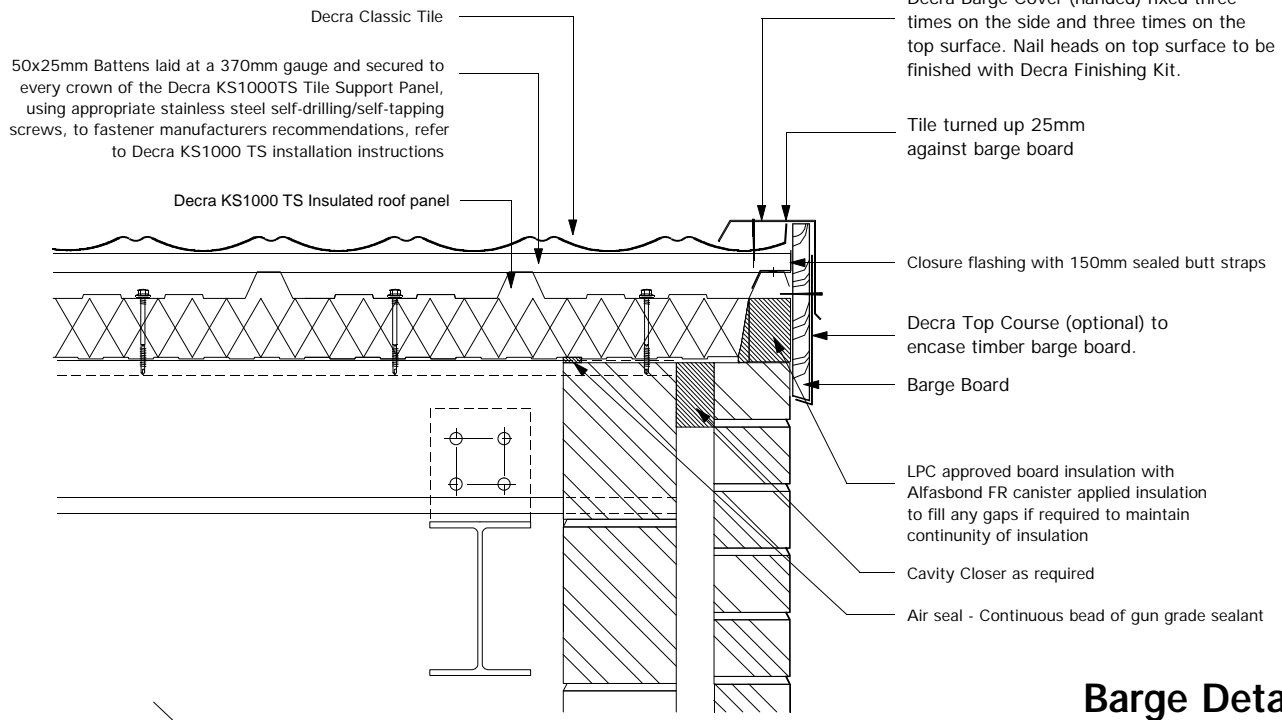

Barge Detail
Scale 1:10

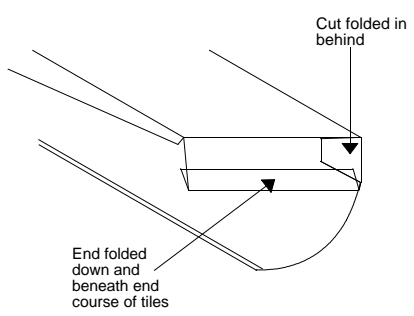
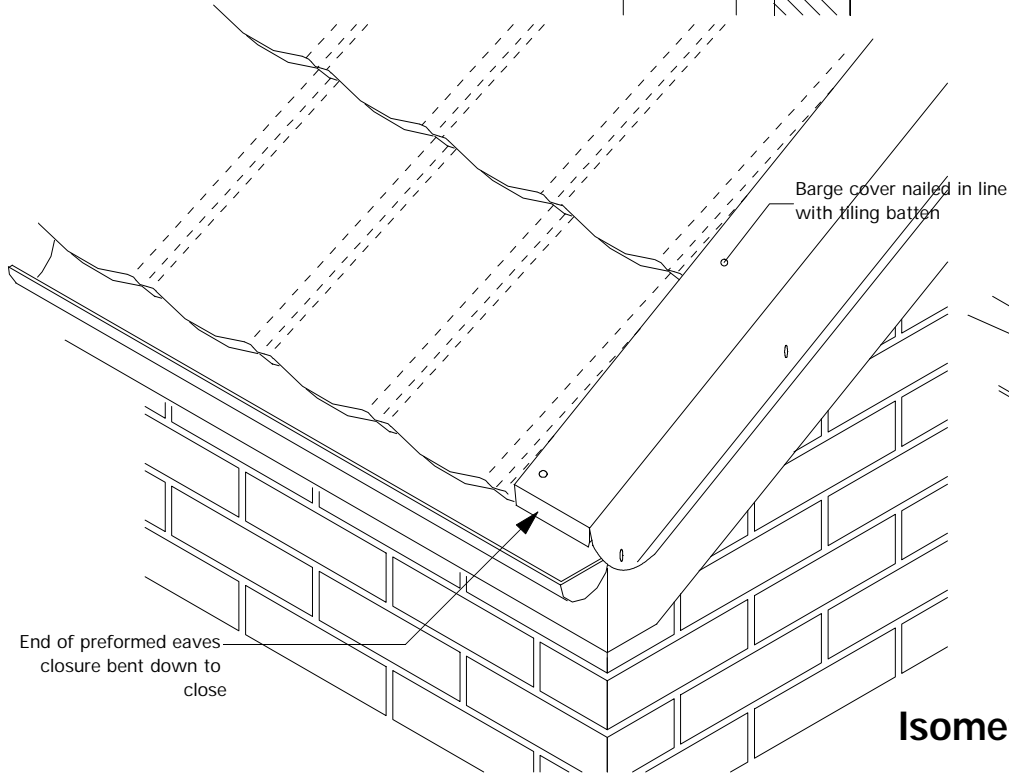

Isometric View
Scale 1:5

Isometric Detail at Gutter
Scale 1:10

Notes:

This detail is to be read in conjunction with the instructions for the Decra KS1000 TS tile support system.

TS006

Decra[®]
Roof Systems Limited
A member of the Icopal Group



Unit 4
Crompton Fields
Crompton Way
Crawley
West Sussex
RH10 9QB

telephone: (01293) 545058/9
fax: (01293) 562709
email: technical@decra.co.uk
web-Site: <http://www.decra.co.uk>

The copyright of this drawing and detail information belongs to Decra Roof Systems Limited. Reproduction or amendment outwith the terms of the licensing agreement by other parties is expressly forbidden.

DECRA CLASSIC		
CONTENT	WARM ROOF VERGE DETAIL	
DRAWING SCALE	1:10	DATE 04/11/03
DRAWING NO	DTSW050	REVISION

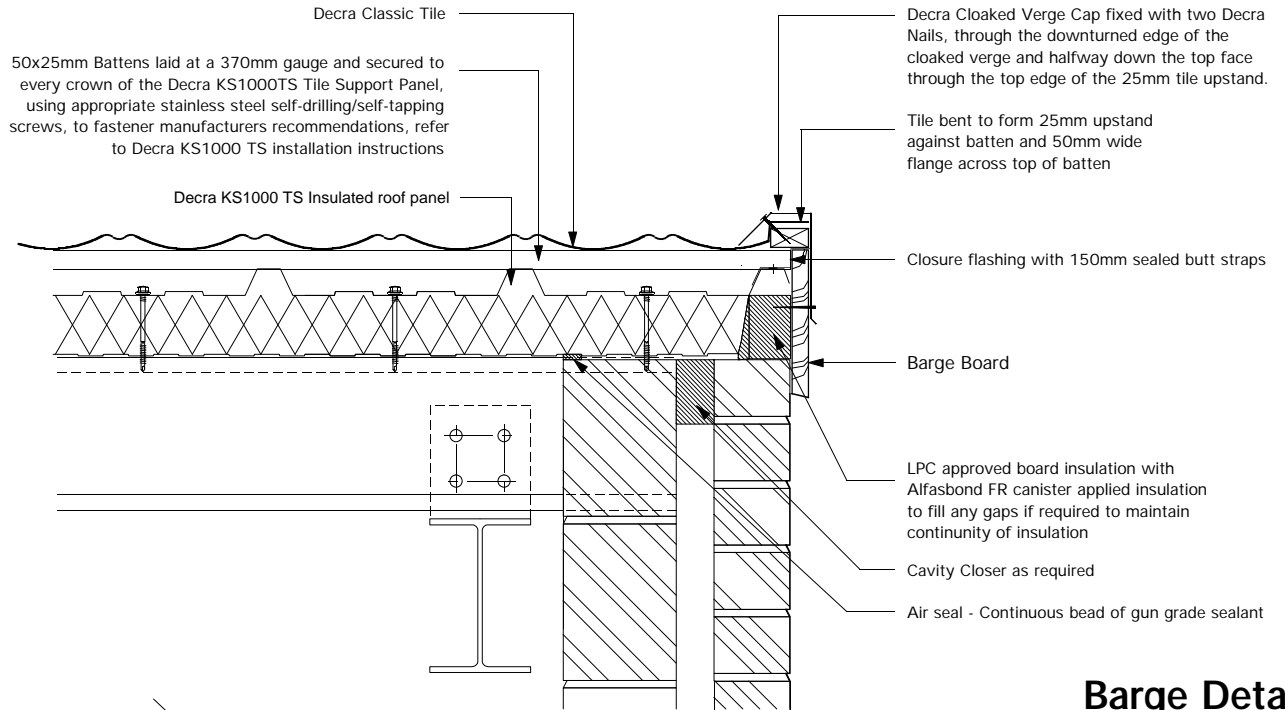

Barge Detail

Scale 1:10

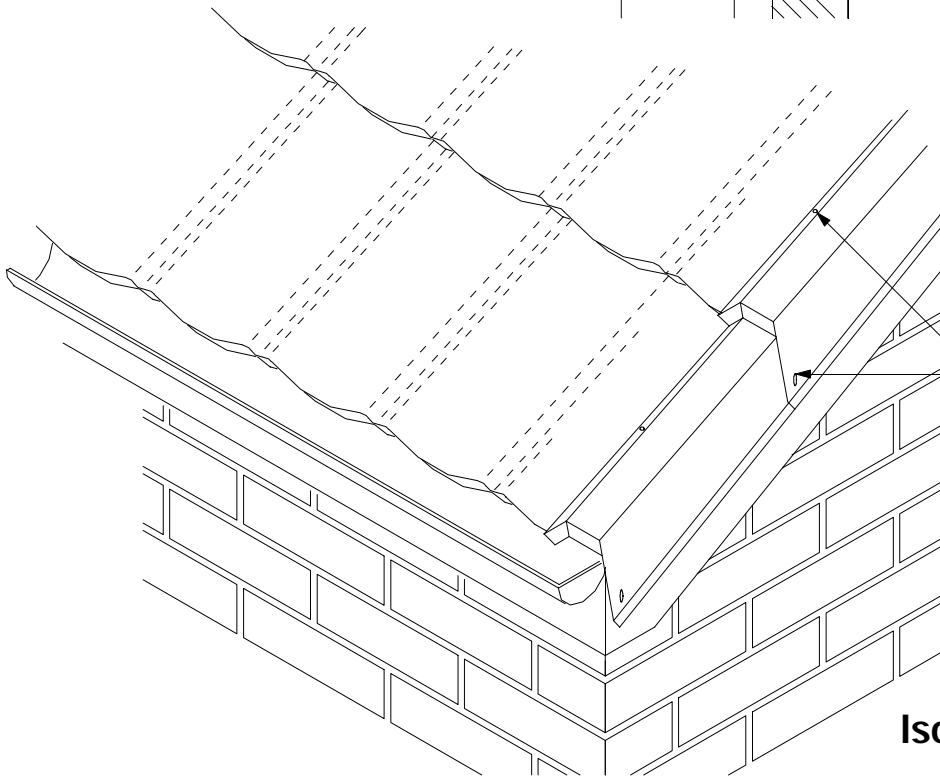

Decra Cloaked Verge Cap fixed with two Decra Nails, through the downturned edge of the cloaked verge and halfway down the top face through the top edge of the 25mm tile upstand.

Isometric Detail at Gutter

Scale 1:10

Notes:

This detail is to be read in conjunction with the instructions for the Decra KS1000 TS tile support system.

TS006

Decra[®]
Roof Systems Limited

A member of the Icopal Group



Unit 4
Crompton Fields
Crompton Way
Crawley
West Sussex
RH10 9QB

telephone: (01293) 545058/9
fax: (01293) 562709

email: technical@decra.co.uk
web-Site: <http://www.decra.co.uk>

The copyright of this drawing and detail information belongs to Decra Roof Systems Limited. Reproduction or amendment outwith the terms of the licensing agreement by other parties is expressly forbidden.

DECRA CLASSIC

CONTENT

**WARM ROOF
VERGE DETAIL USING
DECRA CLOAKED VERGE CAP**

DRAWING SCALE

1:10

DATE

04/11/03

DRAWING NO

DTSW051

REVISION

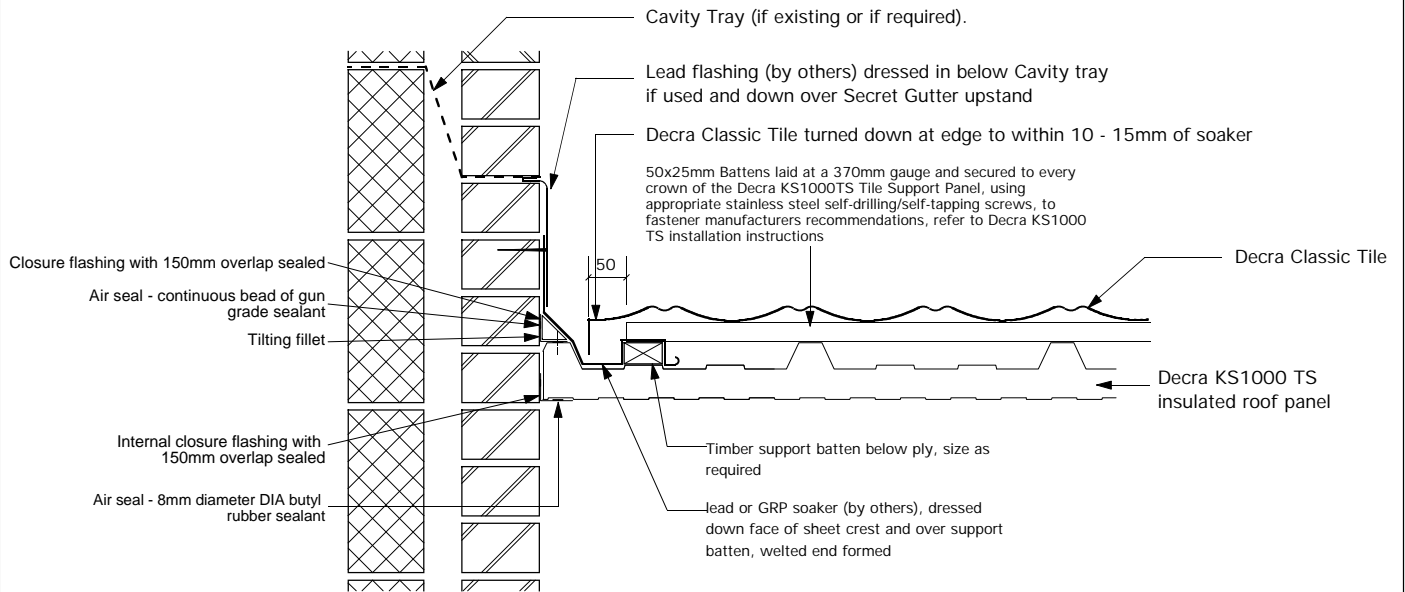

**Abutment Detail With Secret Gutter
Detail at Crown abutting vertical surface**
Scale 1:10

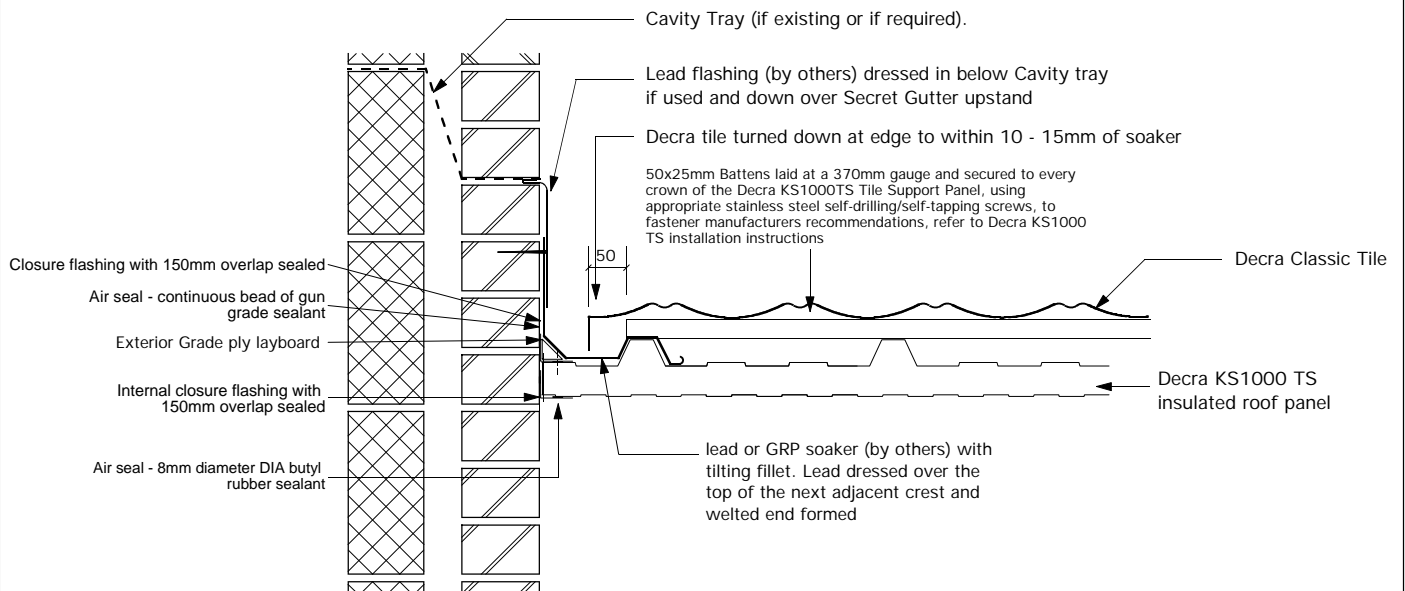

**Abutment Detail With Secret Gutter
Detail at Valley abutting vertical surface**
Scale 1:10

Notes:

This detail is to be read in conjunction with the instructions for the Decra KS1000 TS tile support system.

TS021

Decra[®]
Roof Systems Limited
A member of the Icopal Group



Unit 4
Crompton Fields
Crompton Way
Crawley
West Sussex
RH10 9QB

telephone: (01293) 545058/9
fax: (01293) 562709
email: technical@decra.co.uk
web-Site: <http://www.decra.co.uk>

The copyright of this drawing and detail information belongs to Decra Roof Systems Limited. Reproduction or amendment outwith the terms of the licensing agreement by other parties is expressly forbidden.

DECRA CLASSIC

CONTENT

**WARM ROOF
ABUTMENT DETAILS
WITH SECRET GUTTER**

DRAWING SCALE

1:10

DATE

04/11/03

DRAWING NO

DTSW052

REVISION

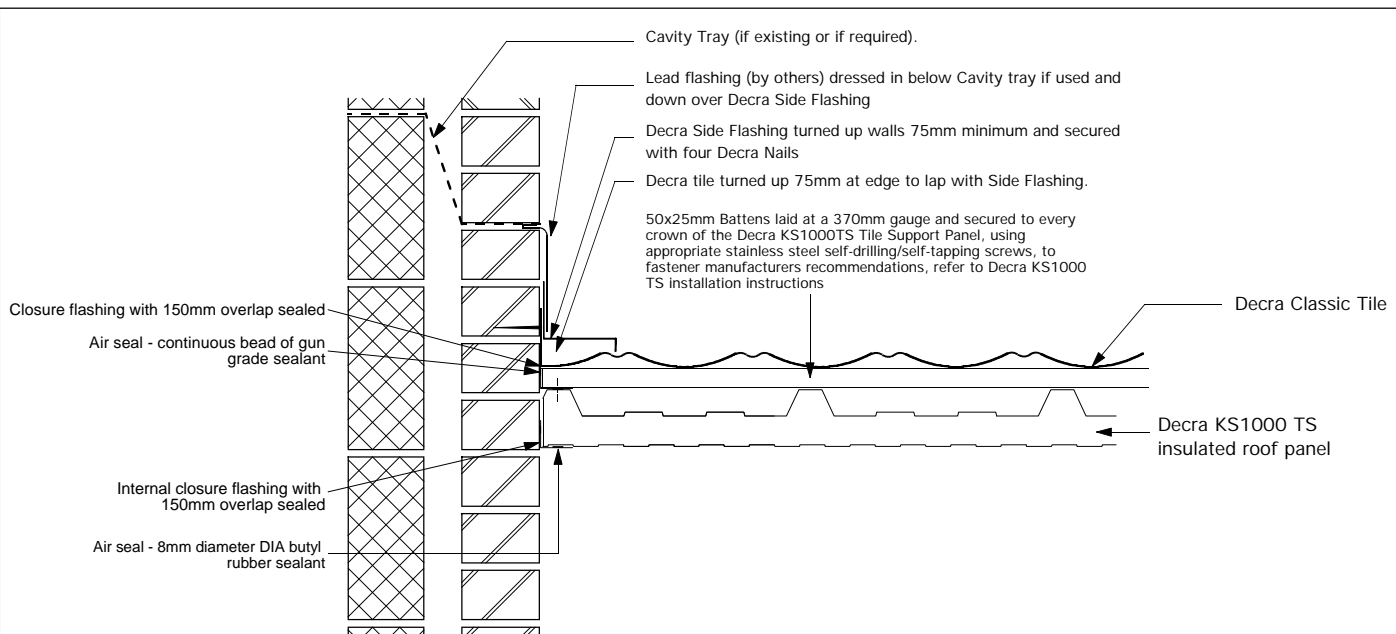

**Abutment Detail With Side Flashing
Detail at Crown abutting vertical surface**

Scale 1:10

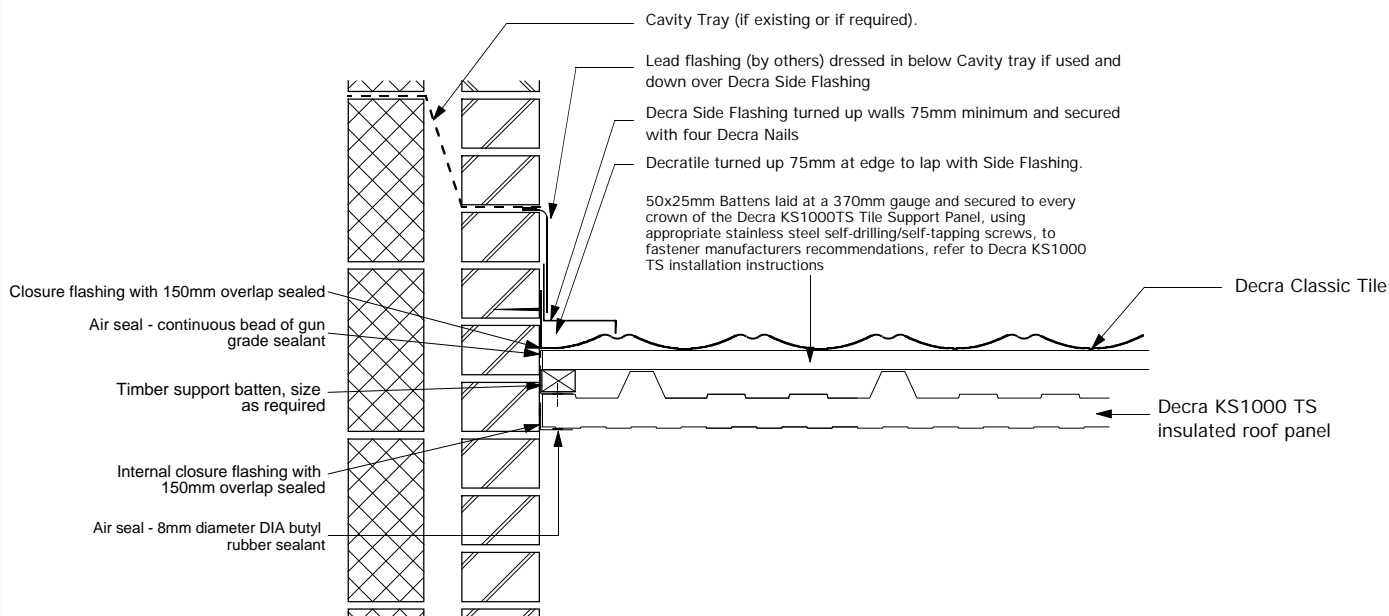

**Abutment Detail With Side Flashing
Detail at Valley abutting vertical surface**

Scale 1:10

Notes:

This detail is to be read in conjunction with the instructions for the Decra KS1000 TS tile support system.

TS021

Decra[®]
Roof Systems Limited

A member of the Icopal Group



Unit 4
Crompton Fields
Crompton Way
Crawley
West Sussex
RH10 9QB

telephone: (01293) 545058/9
fax: (01293) 562709

email: technical@decra.co.uk
web-Site: <http://www.decra.co.uk>

The copyright of this drawing and detail information belongs to Decra Roof Systems Limited. Reproduction or amendment outwith the terms of the licensing agreement by other parties is expressly forbidden.

DECRA CLASSIC

CONTENT

**WARM ROOF
ABUTMENT DETAILS
WITH DECRA SIDE FLASHING**

DRAWING SCALE

1:10

DATE

04/11/03

DRAWING NO

DTSW053

REVISION

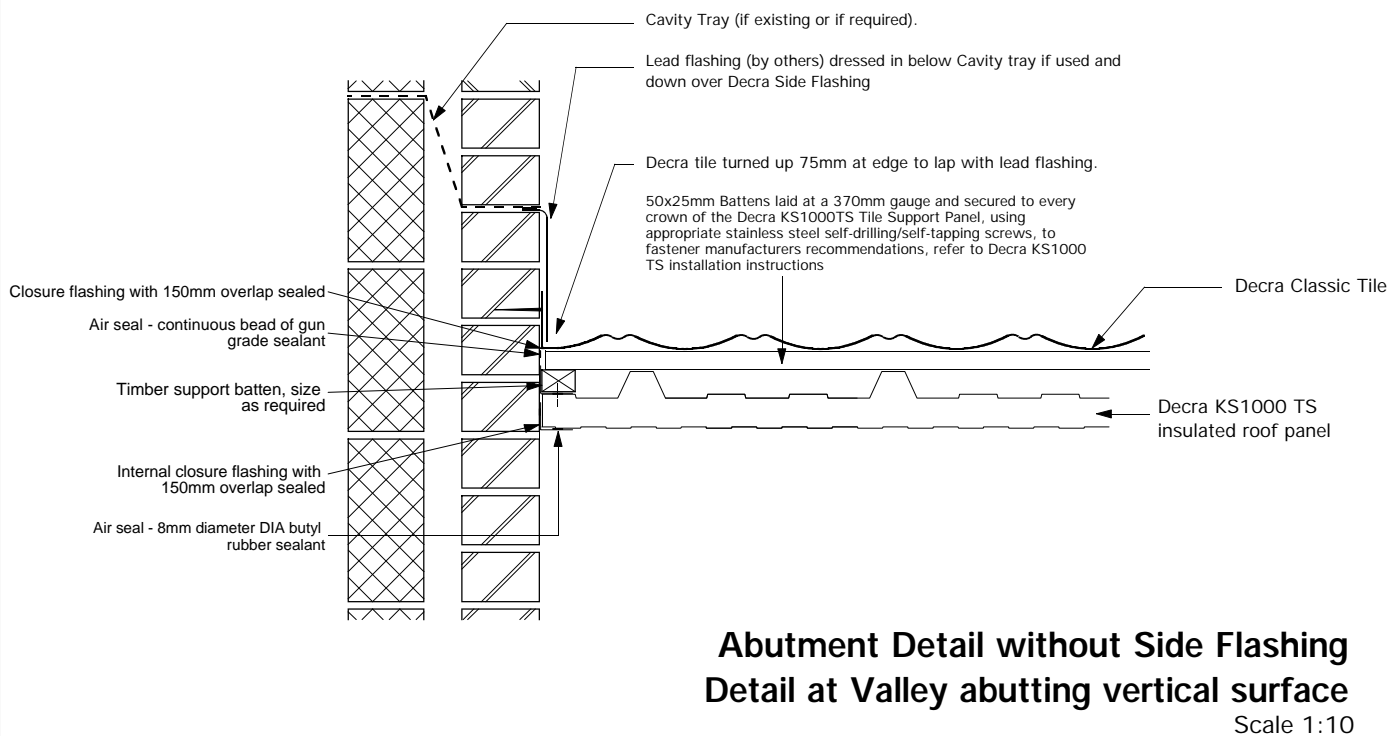
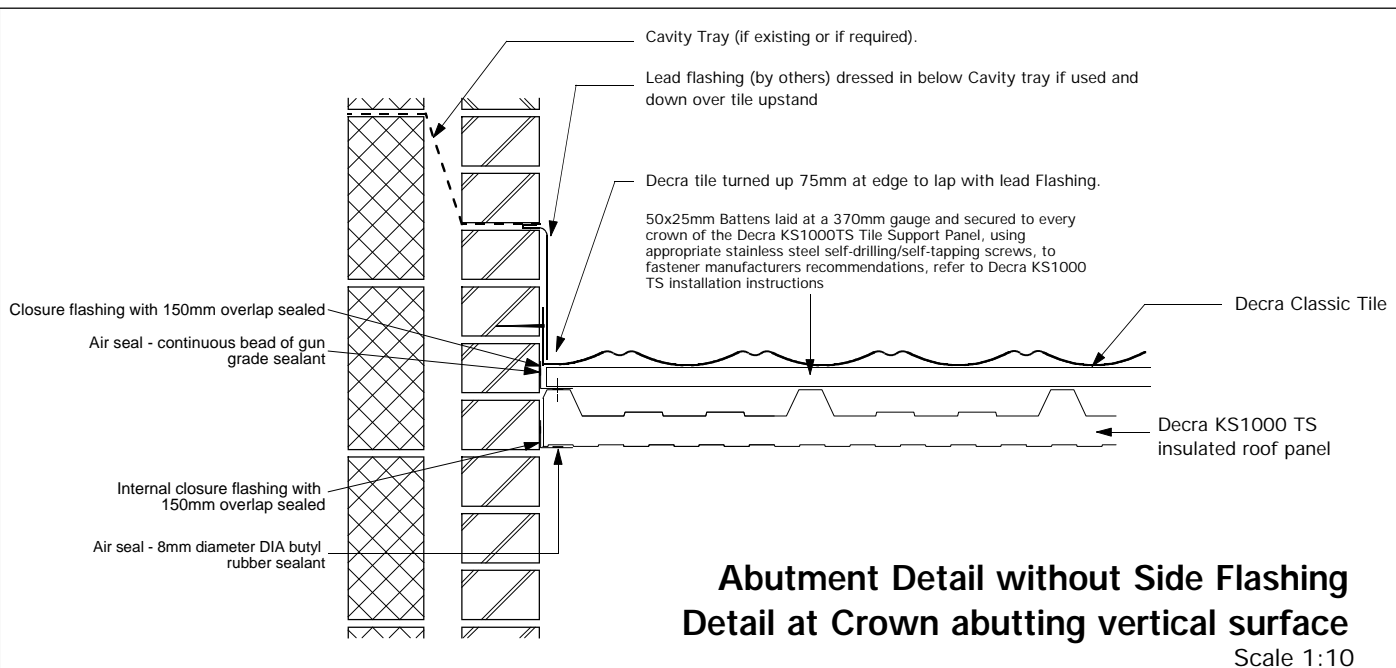

Notes:

This detail is to be read in conjunction with the instructions for the Decra KS1000 TS tile support system.

TS021

Decra[®]
 Roof Systems Limited

A member of the Icopal Group



Unit 4
 Crompton Fields
 Crompton Way
 Crawley
 West Sussex
 RH10 9QB

telephone: (01293) 545058/9
 fax: (01293) 562709

email: technical@decra.co.uk
 web-Site: <http://www.decra.co.uk>

The copyright of this drawing and detail information belongs to Decra Roof Systems Limited. Reproduction or amendment outwith the terms of the licensing agreement by other parties is expressly forbidden.

DECRA CLASSIC

CONTENT

**WARM ROOF
 ABUTMENT DETAILS
 WITHOUT SIDE FLASHING**

DRAWING SCALE

1:10

DATE

04/11/03

DRAWING NO

DTSW054

REVISION

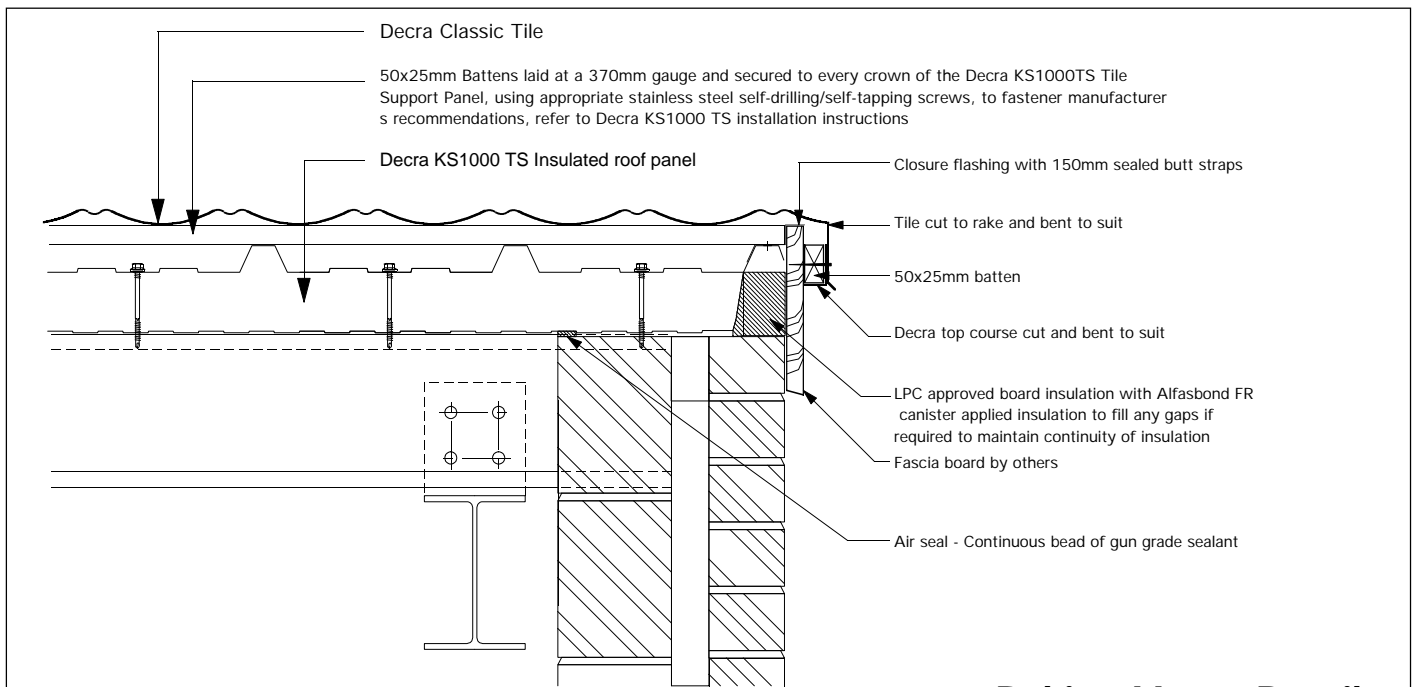

Raking Verge Detail
Scale 1:10

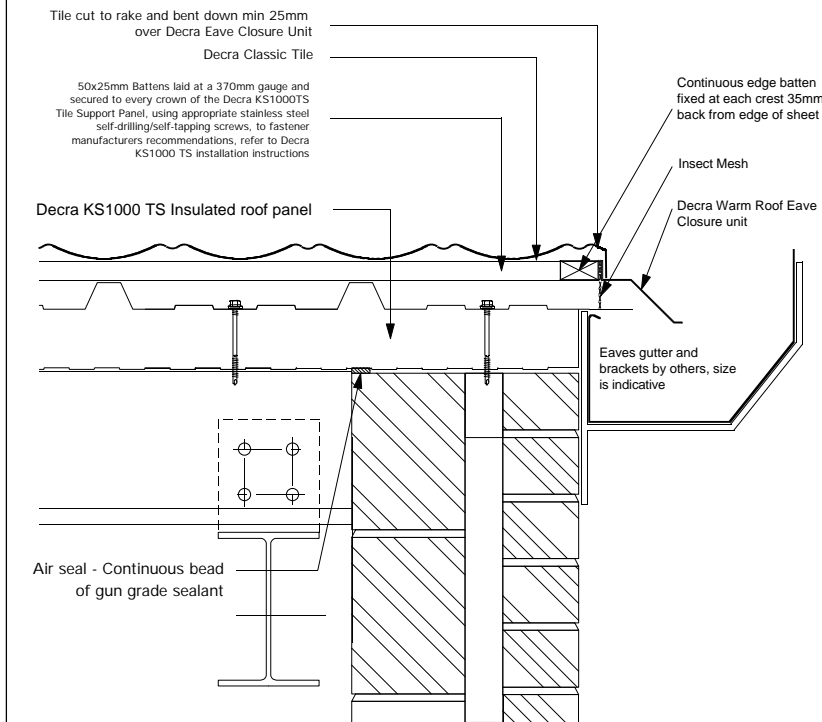

Raking Verge Detail with gutter
Scale 1:10

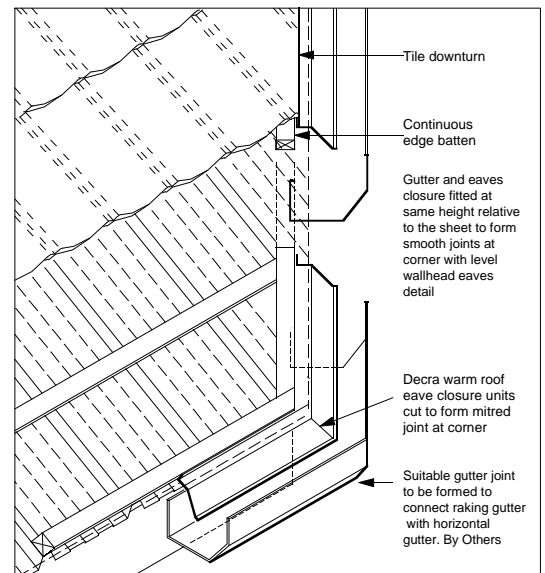

Cutaway Isometric to Raking Verge
Scale 1:20

Notes:

This detail is to be read in conjunction with the instructions for the Decra KS1000 TS tile support system.

Gutter sizes to be adjusted as required to comply with calculated width requirements of Code Of Practice as set out in BS 5534: Part1

TS006

Decra[®]
Roof Systems Limited

A member of the Icopal Group



Unit 4
Crompton Fields
Crompton Way
Crawley
West Sussex
RH10 9QB

telephone: (01293) 545058/9
fax: (01293) 562709

email: technical@decra.co.uk
web-Site: <http://www.decra.co.uk>

The copyright of this drawing and detail information belongs to Decra Roof Systems Limited. Reproduction or amendment outwith the terms of the licensing agreement by other parties is expressly forbidden.

DECRA CLASSIC

CONTENT

**WARM ROOF
RAKING VERGE DETAILS**

DRAWING SCALE

1:10

DATE

04/11/03

DRAWING NO

DTSW055

REVISION

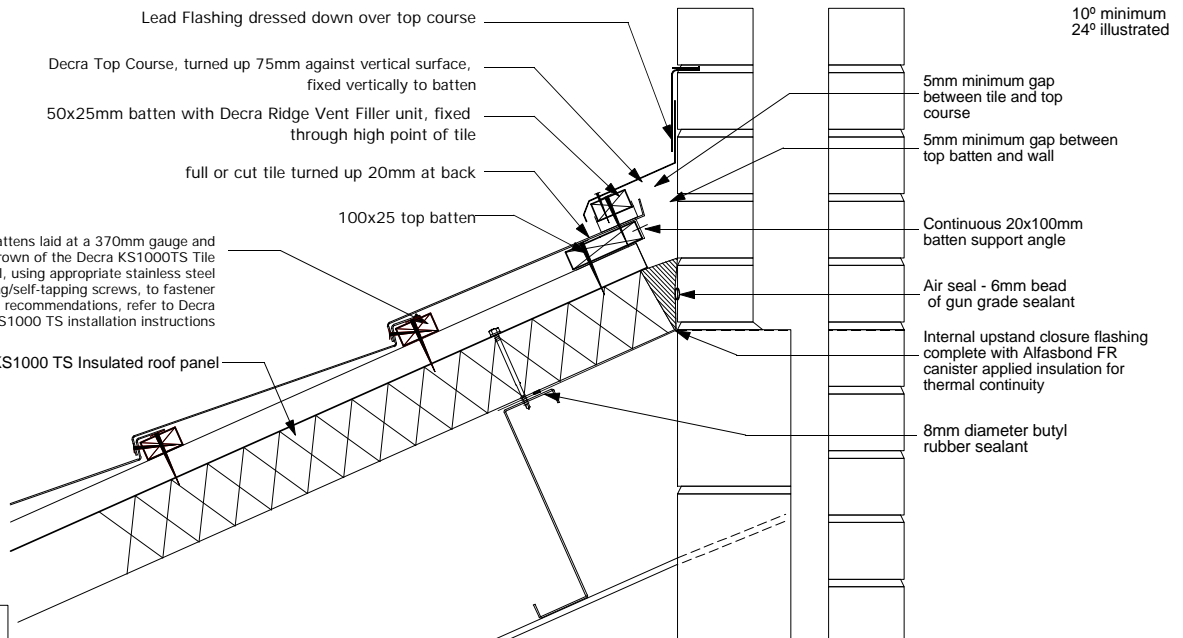

Top Edge Abutment Detail, using Vent Filler Unit

Scale 1:10

Decra D Ridge into top course - formed on site

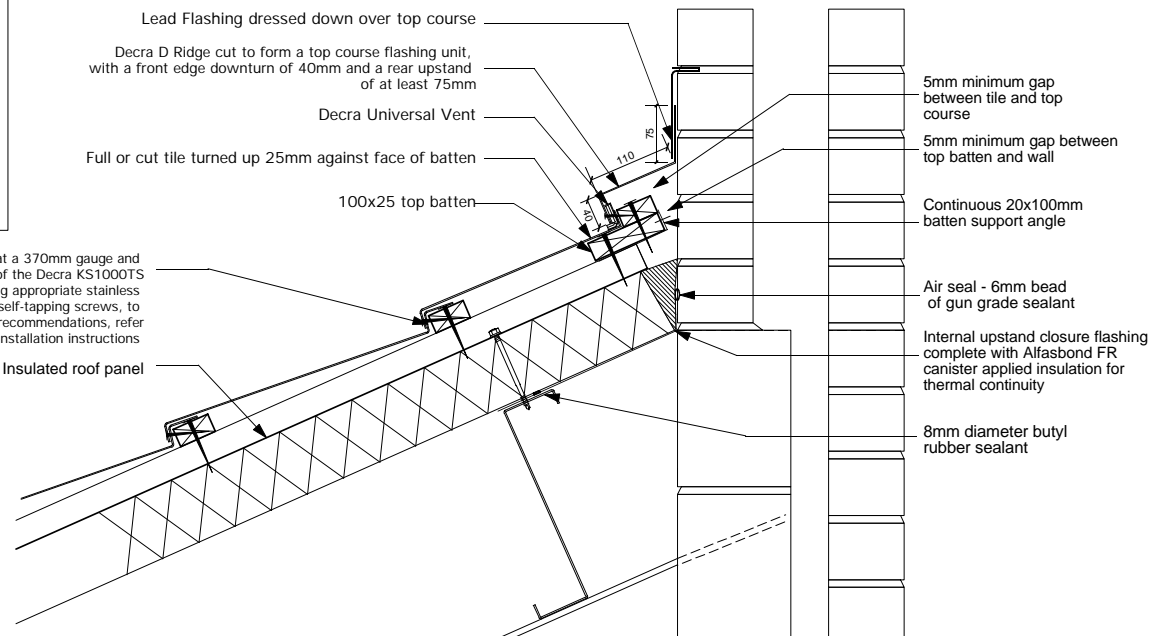
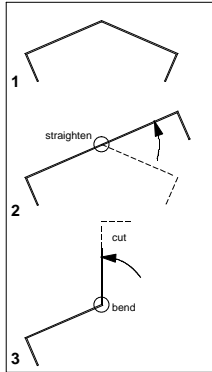

Top Edge Abutment Detail, using Universal Vent Unit

Scale 1:10

Notes:

This detail is to be read in conjunction with the instructions for the Decra KS1000 TS tile support system.

TS016

Decra[®]
Roof Systems Limited

A member of the Icopal Group



Unit 4
Crompton Fields
Crompton Way
Crawley
West Sussex
RH10 9QB

telephone: (01293) 545058/9
fax: (01293) 562709

email: technical@decra.co.uk
web-Site: <http://www.decra.co.uk>

The copyright of this drawing and detail information belongs to Decra Roof Systems Limited. Reproduction or amendment outwith the terms of the licensing agreement by other parties is expressly forbidden.

DECRA CLASSIC

CONTENT

WARM ROOF
TOP EDGE ABUTMENT DETAILS
(VENTILATED)

DRAWING SCALE

1:10

DATE

04/11/03

DRAWING NO

DTSW056

REVISION

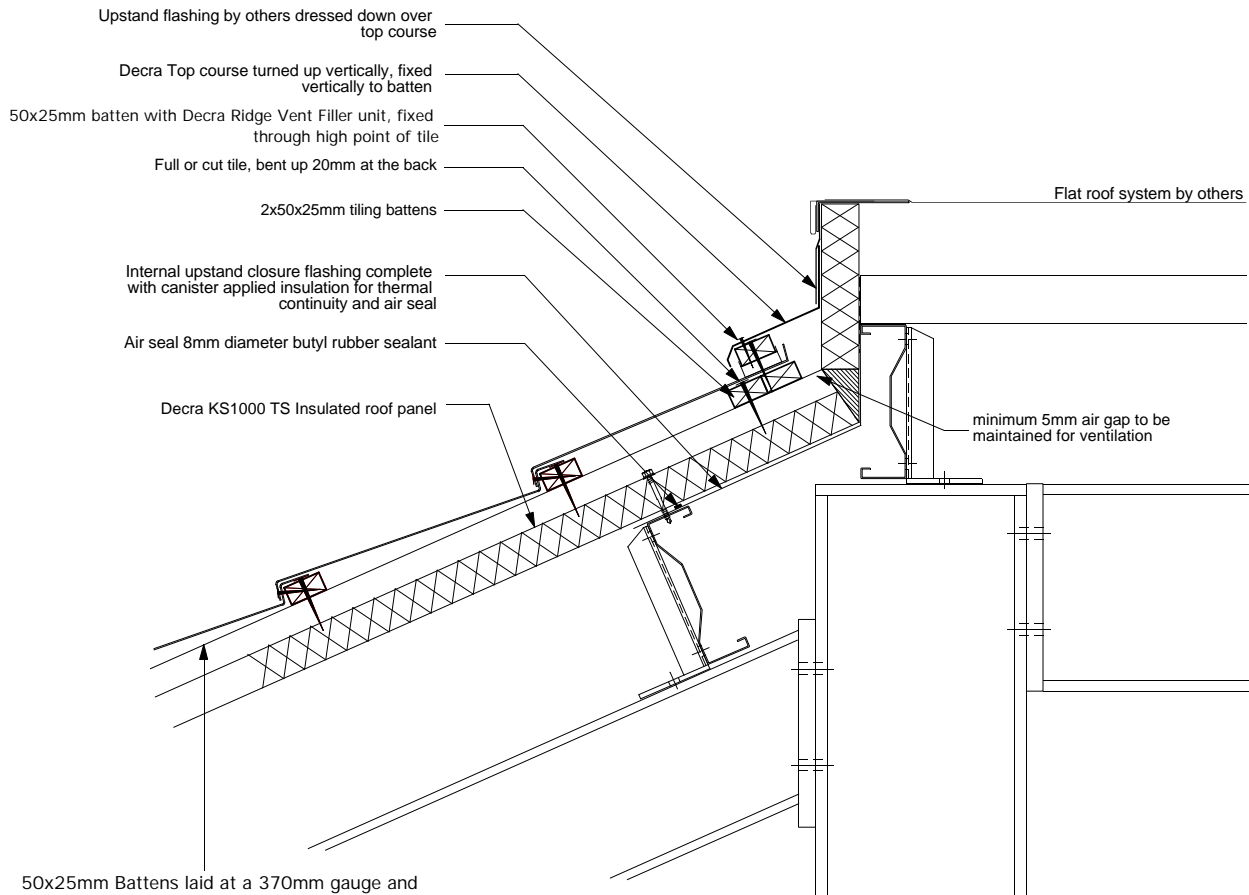

50x25mm Battens laid at a 370mm gauge and secured to every crown of the Decra KS1000TS Tile Support Panel, using appropriate stainless steel self-drilling/self-tapping screws, to fastener manufacturers recommendations, refer to Decra KS1000 TS installation instructions

Flat Roof Top Edge Abutment Detail
Scale 1:10

Notes:

This detail is to be read in conjunction with the instructions for the Decra KS1000 TS tile support system.

TS019

Decra[®]
Roof Systems Limited

A member of the Icopal Group



Unit 4
Crompton Fields
Crompton Way
Crawley
West Sussex
RH10 9QB

telephone: (01293) 545058/9
fax: (01293) 562709

email: technical@decra.co.uk
web-Site: <http://www.decra.co.uk>

The copyright of this drawing and detail information belongs to Decra Roof Systems Limited. Reproduction or amendment outwith the terms of the licensing agreement by other parties is expressly forbidden.

DECRA CLASSIC

CONTENT

**WARM ROOF
FLAT ROOF TOP EDGE ABUTMENT DETAIL**

DRAWING SCALE

1:10

DATE

04/11/03

DRAWING NO

DTSW057

REVISION

50x25mm Battens laid at a 370mm gauge and secured to every crown of the Decra KS1000TS Tile Support Panel, using appropriate stainless steel self-drilling/self-tapping screws, to fastener manufacturers recommendations, refer to Decra KS1000 TS installation instructions

- 8mm diameter rubber sealant
- internal closure flashing
- Canister applied insulation
- Lead Flashing (by others)
- Decra KS1000 TS Insulated roof panel
- Decra Classic Tile
- 8mm diameter rubber sealant

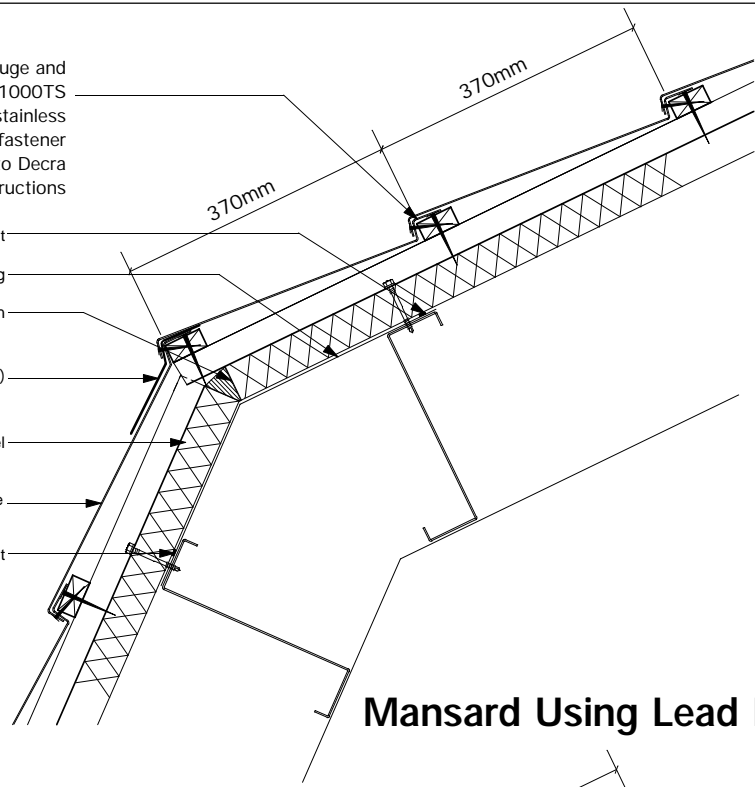

Mansard Using Lead Flashing

Scale 1:10

50x25mm Battens laid at a 370mm gauge and secured to every crown of the Decra KS1000TS Tile Support Panel, using appropriate stainless steel self-drilling/self-tapping screws, to fastener manufacturers recommendations, refer to Decra KS1000 TS installation instructions

- Decra nails fixed vertically through high point of tile to have finishing kit applied to head.
- Nosing of main roof tile to sit close to top course.
- If this dimension is over 150mm Decra tiles to be used.
- Decra top course bent to suit spacing of tile batten at change of pitch.
- Decra Classic Tile
- 8mm diameter rubber sealant
- Decra KS1000 TS Insulated roof panel

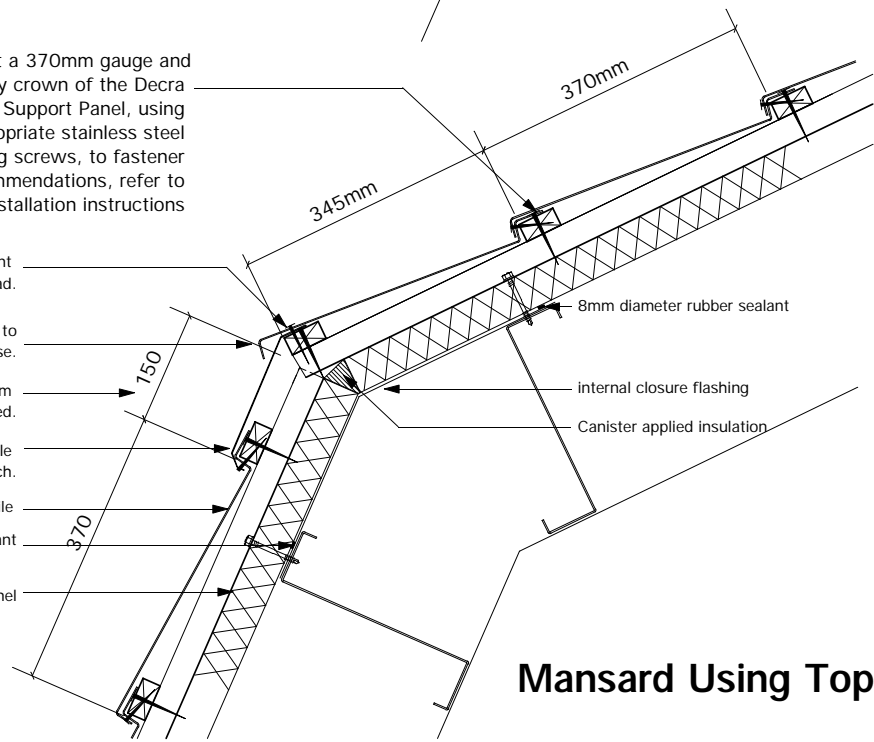

Mansard Using Top Course

Scale 1:10

Notes:

This detail is to be read in conjunction with the instructions for the Decra KS1000 TS tile support system.

TS022

Decra[®]
Roof Systems Limited

A member of the Icopal Group



Unit 4
Crompton Fields
Crompton Way
Crawley
West Sussex
RH10 9QB

telephone: (01293) 545058/9
fax: (01293) 562709

email: technical@decra.co.uk
web-Site: <http://www.decra.co.uk>

The copyright of this drawing and detail information belongs to Decra Roof Systems Limited. Reproduction or amendment outwith the terms of the licensing agreement by other parties is expressly forbidden.

DECRA CLASSIC

CONTENT

WARM ROOF
MANSARD ROOF DETAILS

DRAWING SCALE

1:10

DATE

04/11/03

DRAWING NO

DTSW060

REVISION

50x25mm Battens laid at a 370mm gauge and secured to every crown of the Decra KS1000TS Tile Support Panel, using appropriate stainless steel self-drilling/self-tapping screws, to fastener manufacturers recommendations, refer to Decra KS1000 TS installation instructions

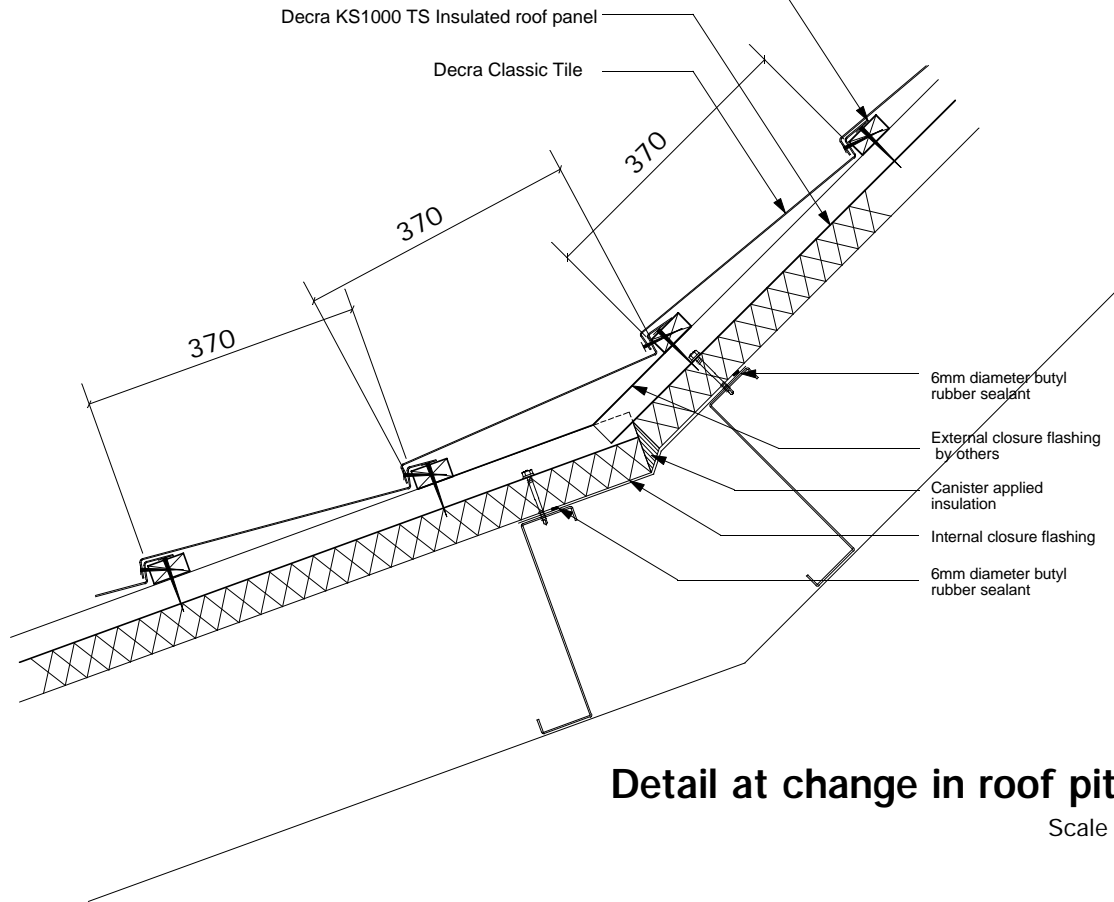

Detail at change in roof pitch
Scale 1:10

Notes:

This detail is to be read in conjunction with the instructions for the Decra KS1000 TS tile support system.

TS---

Decra[®]
Roof Systems Limited
A member of the Icopal Group



Unit 4
Crompton Fields
Crompton Way
Crawley
West Sussex
RH10 9QB

telephone: (01293) 545058/9
fax: (01293) 562709
email: technical@decra.co.uk
web-Site: <http://www.decra.co.uk>

The copyright of this drawing and detail information belongs to Decra Roof Systems Limited. Reproduction or amendment outwith the terms of the licensing agreement by other parties is expressly forbidden.

DECRA CLASSIC

CONTENT

**WARM ROOF
CHANGE IN PITCH DETAILS**

DRAWING SCALE **1:10**

DATE **04/11/03**

DRAWING NO **DTSW061**

REVISION

VELUX - EDH FLASHING

15° minimum - Velux rooflights cannot be fitted below this pitch
24° illustrated

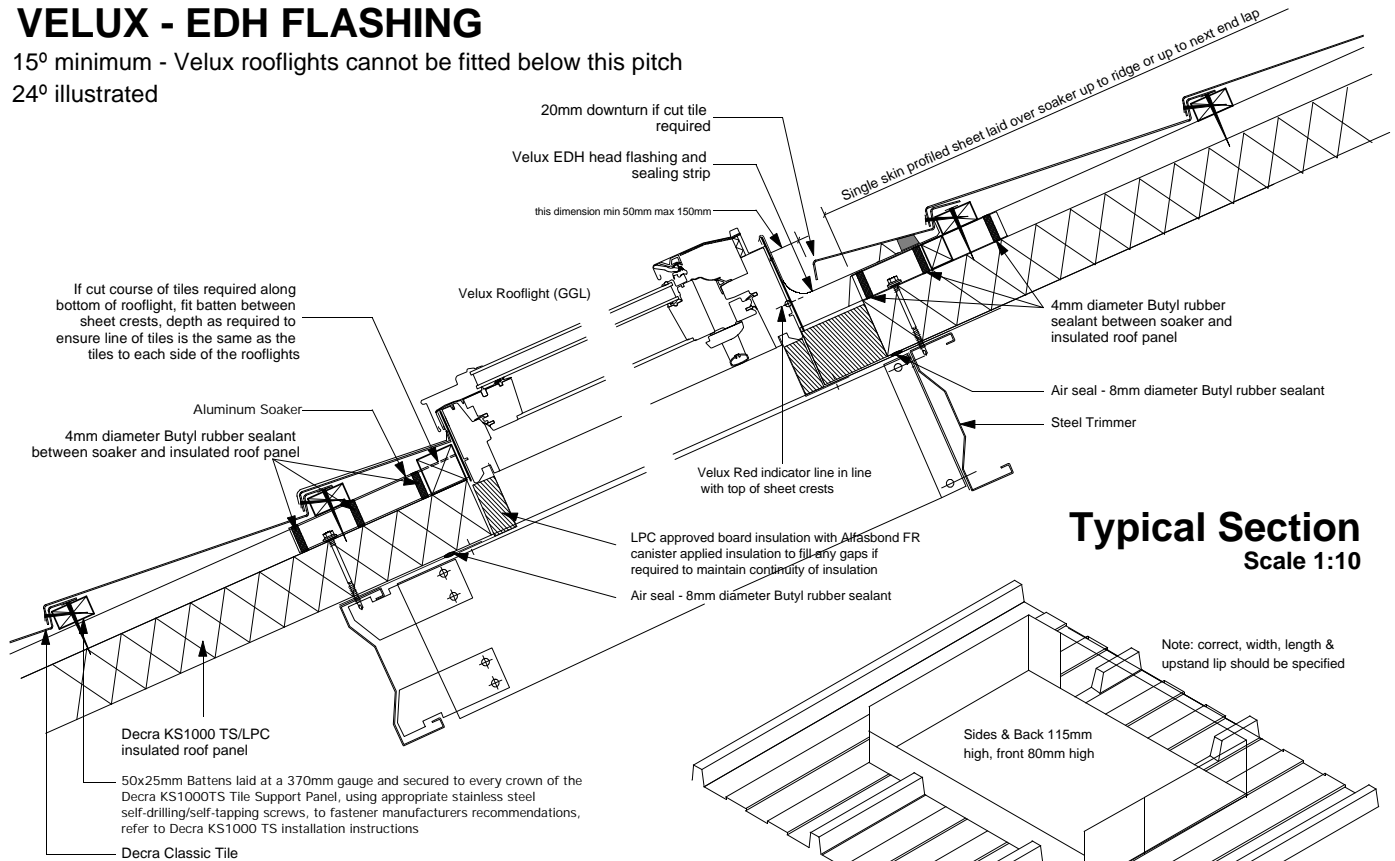

Typical Section
Scale 1:10

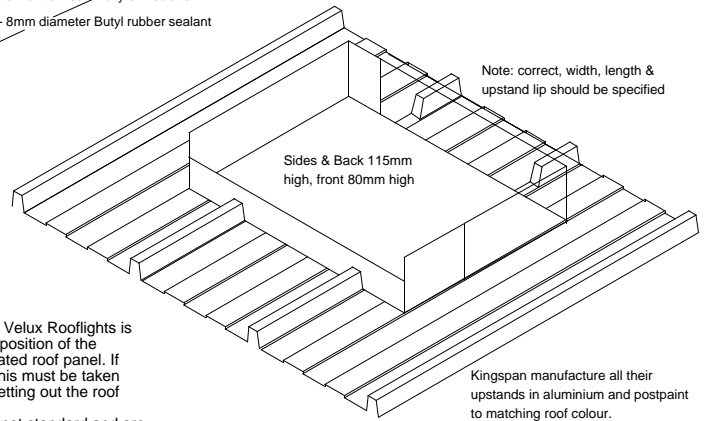

Aluminium soaker isometric
not to scale

Important Note:
The position of the Velux Rooflights is determined by the position of the crests on the insulated roof panel. If location is critical this must be taken account of when setting out the roof panels. Flashing sizes are not standard and are manufactured to order to suit the opening required for the size of rooflight.

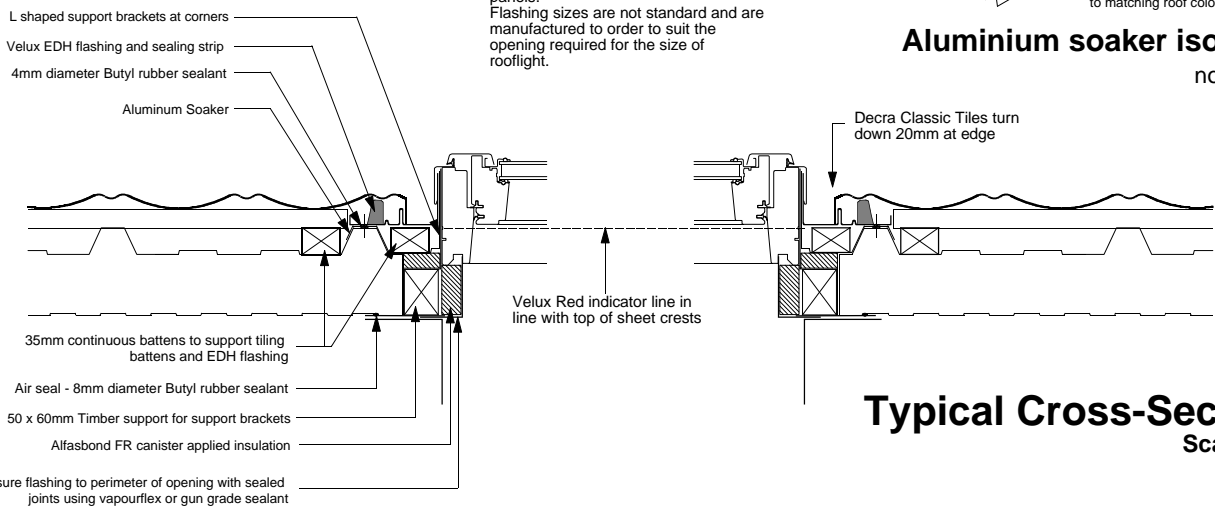

Typical Cross-Section
Scale 1:10

Notes:

15° minimum roof pitch for Velux GGL Rooflights.
Velux Type EDH flashings must be used
The use of the following rooflights are to be strongly recommended for improved fitting in conjunction with Decra Classic Tiles: GGL206, GGL306, GGL410, GGL606, Special sizes complying with overall external frame heights of 1180mmx1600mm.

Velux Rooflight profiles and details courtesy of, and copyright to, Velux.
This detail is to be read in conjunction with Velux installation and design instructions.
Design and installation must ensure that ventilation of roofspace requirements are adhered to. Detail shown may not suit all types of roof construction where ventilation is concerned.

This detail is to be read in conjunction with the instructions for the Decra KS1000 TS tile support system.

This detail to be read in conjunction with Acrobat files for velux installation instructions in the information section on the Decra Technical Services CD

TS015

Decra[®]
Roof Systems Limited
A member of the Icopal Group



Unit 4
Crompton Fields
Crompton Way
Crawley
West Sussex
RH10 9QB

telephone: (01293) 545058/9
fax: (01293) 562709
email: technical@decra.co.uk
web-Site: <http://www.decra.co.uk>

The copyright of this drawing and detail information belongs to Decra Roof Systems Limited. Reproduction or amendment outwith the terms of the licensing agreement by other parties is expressly forbidden.

DECRA CLASSIC

CONTENT

WARM ROOF
VELUX ROOFLIGHT DETAILS

DRAWING SCALE

1:10

DATE

04/11/03

DRAWING NO

DTSW070

REVISION