

## Decra Plus

Drawing no	Description	Shown In Decra Brochure	Most Commonly Used Detail
DPSW010	Warm Roof Eaves Detail Eaves Overhang With Insulated Fascia and Soffit • <i>Warm Roof Eaves Detail</i>		<input checked="" type="checkbox"/>
DPSTW011	Warm roof Eaves Detail No Eaves Overhang • <i>Warm Roof Eaves Detail</i>		<input checked="" type="checkbox"/>
DPSW012	Warm Roof Eaves Detail Eaves Overhang Over Door or Window Opening • <i>Warm Roof Eaves Detail</i>		<input checked="" type="checkbox"/>
DPSW013	Warm Roof Eaves Detail Eaves Gutter and Bracket for Gutter Calculation • <i>Warm Roof Eaves Detail</i>		<input checked="" type="checkbox"/>
DPSW014	Warm Roof Eaves Detail Internal Box Gutter • <i>Warm Roof Eaves Detail at Internal Box Gutter</i>		<input checked="" type="checkbox"/>
DPSW015	Warm Roof Eaves Detail Parapet Box Gutter • <i>Warm Roof Eaves Detail</i>		<input checked="" type="checkbox"/>
DPSW016	Warm Roof Eaves Detail at Dormer Window Head • <i>Warm Roof Eaves Detail at Dormer Window Head</i>		<input checked="" type="checkbox"/>
DPSW020	Warm Roof Hip Detail Using Ventilated 'D' Hip Ridge • <i>Hip detail Using 'D' Ridge</i> • <i>Cutaway Isometric to Hip</i>		<input checked="" type="checkbox"/>
DPSW021	Warm Roof Ridge Detail Ventilated 'D' Ridge Using Universal 'D' Ridge Ventilator • <i>Vented 'D' Ridge Detail</i>		<input checked="" type="checkbox"/>
DPSW024	Warm Roof Ridge Detail Mono Ridge Mansard Roof • <i>Mono Ridge Mansard Roof Detail</i>		<input checked="" type="checkbox"/>
DPSW030	Warm Roof Ridge Detail Using Ridge Barge Cap Using Universal 'D' Ridge Ventilator • <i>Mono Ridge Detail</i>		<input checked="" type="checkbox"/>
DPSW031	Warm Roof Ridge Detail mono Ridge Mansard Roof With Universal Ridge Vent • <i>Mono Ridge Mansard Roof Detail</i>		<input checked="" type="checkbox"/>
DPSW035	Warm Roof Valley Detail • <i>Mono Ridge Detail</i>		<input checked="" type="checkbox"/>
DPSW030	Warm Roof Ridge Detail Mono-Ridge Mansard Roof • <i>Mono Ridge Mansard Roof Detail</i>		<input checked="" type="checkbox"/>
DPSW031	Warm Roof Ridge Detail Mono-Ridge Mansard Roof With Universal Ridge Vent • <i>Mono Ridge Mansard Roof Detail</i>		<input checked="" type="checkbox"/>
DPSW035	Warm Roof Valley Details • <i>Valley Detail using Lead on Ply Layboards</i> • <i>GRP Valley Detail</i>		<input checked="" type="checkbox"/>
DPSW040	Warm Roof Roof Ventilator • Long Section through Roof Ventilator • Cross-Section Through Roof Ventilator		<input checked="" type="checkbox"/>
DPSW050	Warm Roof Verge Detail • <i>Barge Detail</i> • <i>Isometric Detail at Gutter</i>		<input checked="" type="checkbox"/>
DPSW051	Warm Roof Detail Verge Detail Using D Box Barge • <i>Barge Detail</i> • <i>Isometric Detail at Gutter</i>		<input checked="" type="checkbox"/>
DPSW052	Warm Roof Abutment Details with Secret Gutter • <i>Abutment Detail with Secret Gutter Detail at Crown Abutting Vertical Surface</i> • <i>Abutment Detail with Secret Gutter Detail at Valley Abutting Vertical Surface</i>		
DPSW053	Warm Roof Abutment Details with Side Flashing • <i>Abutment Detail with Side Flashing detail at Crown Asbutting Vertical Surface</i> • <i>Abutment Detail with Side Flashing Detail at Valley Abutting Vertical Surface</i>		<input checked="" type="checkbox"/>

DPSW054	Warm Roof Abutment Details Without Side Flashing <ul style="list-style-type: none"> <li>• <i>Abutment Detail without Side Flashing detail at Crown Asbutting Vertical Surface</i></li> <li>• <i>Abutment Detail without Side Flashing Detail at Valley Abutting Vertical Surface</i></li> </ul>		<input checked="" type="checkbox"/>
DPSW055	Warm Roof Raking Verge Detail <ul style="list-style-type: none"> <li>• <i>Raking Verge Detail</i></li> <li>• <i>Raking Verge Detail with Gutter</i></li> </ul>		
DPSW056	Warm Roof Top edge Abutment Details (ventilated) <ul style="list-style-type: none"> <li>• <i>Top Edge Abutment detail, using Vent Unit</i></li> </ul>		<input checked="" type="checkbox"/>
DPSW057	Warm Roof Top edge Abutment Detail <ul style="list-style-type: none"> <li>• <i>Flat Roof Top edge Abutment Detail</i></li> </ul>		<input checked="" type="checkbox"/>
DPSW060	Warm Roof Mansard Roof Detail <ul style="list-style-type: none"> <li>• <i>Mansard Using Lead Flashing</i></li> <li>• <i>Mansard Using Top Course</i></li> </ul>		<input checked="" type="checkbox"/>
DPSW061	Warm Roof Change in Pitch Details <ul style="list-style-type: none"> <li>• <i>Detail at Change in Roof Pitch</i></li> </ul>		<input checked="" type="checkbox"/>
DPSW070	Warm Roof Velux Rooflight Details <ul style="list-style-type: none"> <li>• <i>Typical Section</i></li> <li>• <i>Aluminium Soaker Isometric</i></li> <li>• <i>Typical Cross Section</i></li> </ul>		<input checked="" type="checkbox"/>

10° roof pitch minimum  
24° roof pitch illustrated

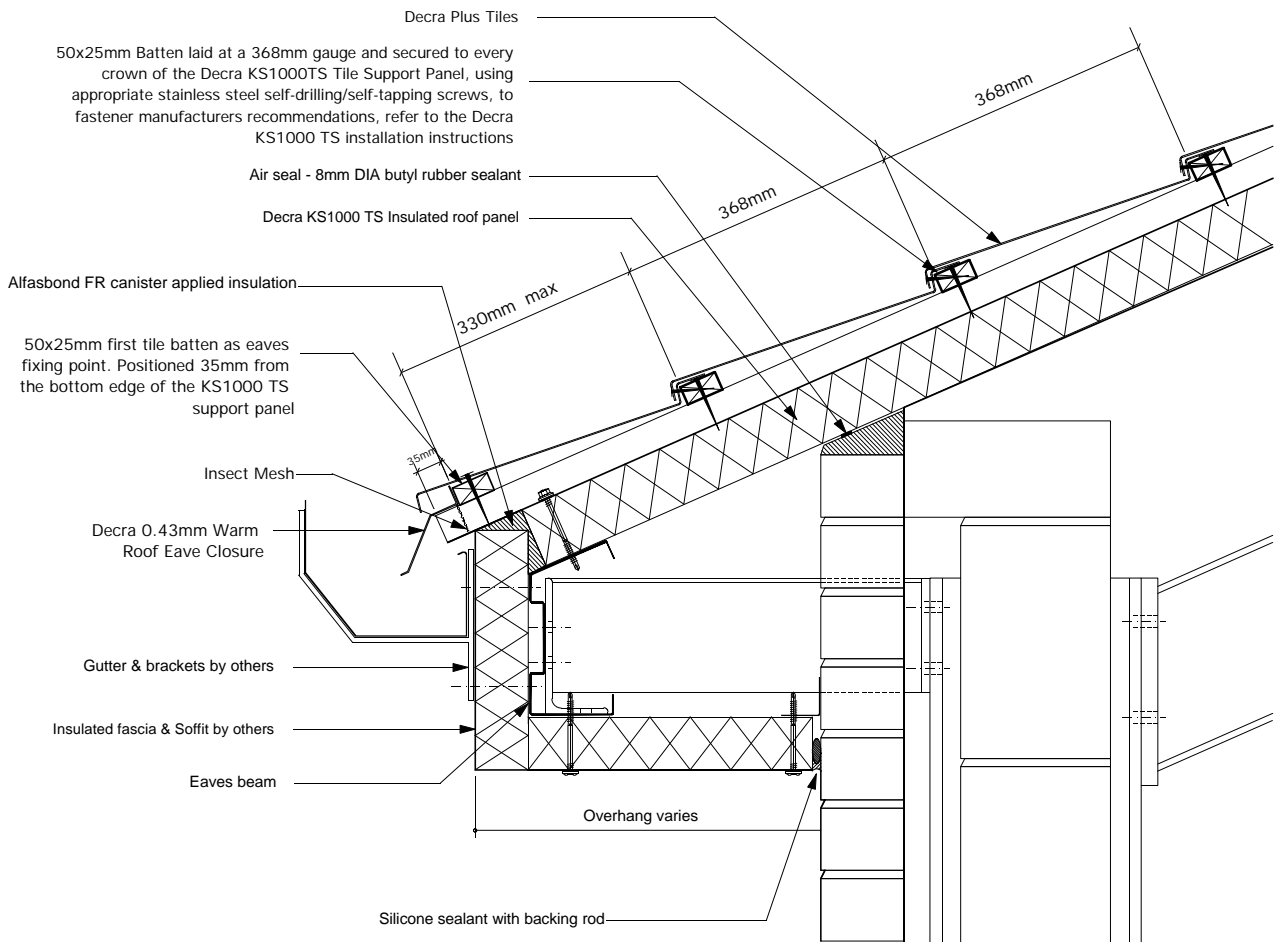

**Warm Roof Eaves Detail**  
Scale 1:10

**Notes:**

This detail is to be read in conjunction with the instructions for the Decra KS1000 TS tile support system.

On eaves course of tile, the tiles are fixed vertically through the high point of the tile into the fascia board or batten directly behind the fascia with pre-coated Decra Plus Fixing Nails or Decra Plus Fixing Screws. The nail/screw heads to be covered with a finishing kit (supplied by Decra).

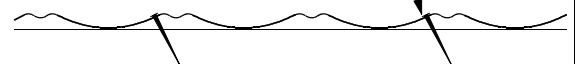

TS003

**Decra®**  
Roof Systems Limited

A member of the Icopal Group



Unit 4  
Crompton Fields  
Crompton Way  
Crawley  
West Sussex  
RH10 9QB

telephone: (01293) 545058/9  
fax: (01293) 562709

email: [technical@decra.co.uk](mailto:technical@decra.co.uk)  
web-Site: <http://www.decra.co.uk>

The copyright of this drawing and detail information belongs to Decra Roof Systems Limited. Reproduction or amendment outwith the terms of the licensing agreement by other parties is expressly forbidden.

**DECRA PLUS**

CONTENT **WARM ROOF EAVES DETAIL  
EAVES OVERHANG WITH  
INSULATED FASCIA AND SOFFIT**

DRAWING SCALE **1:10**

DATE **12/01/04**

DRAWING NO **DPSW010**

REVISION

10° roof pitch minimum  
24° roof pitch illustrated

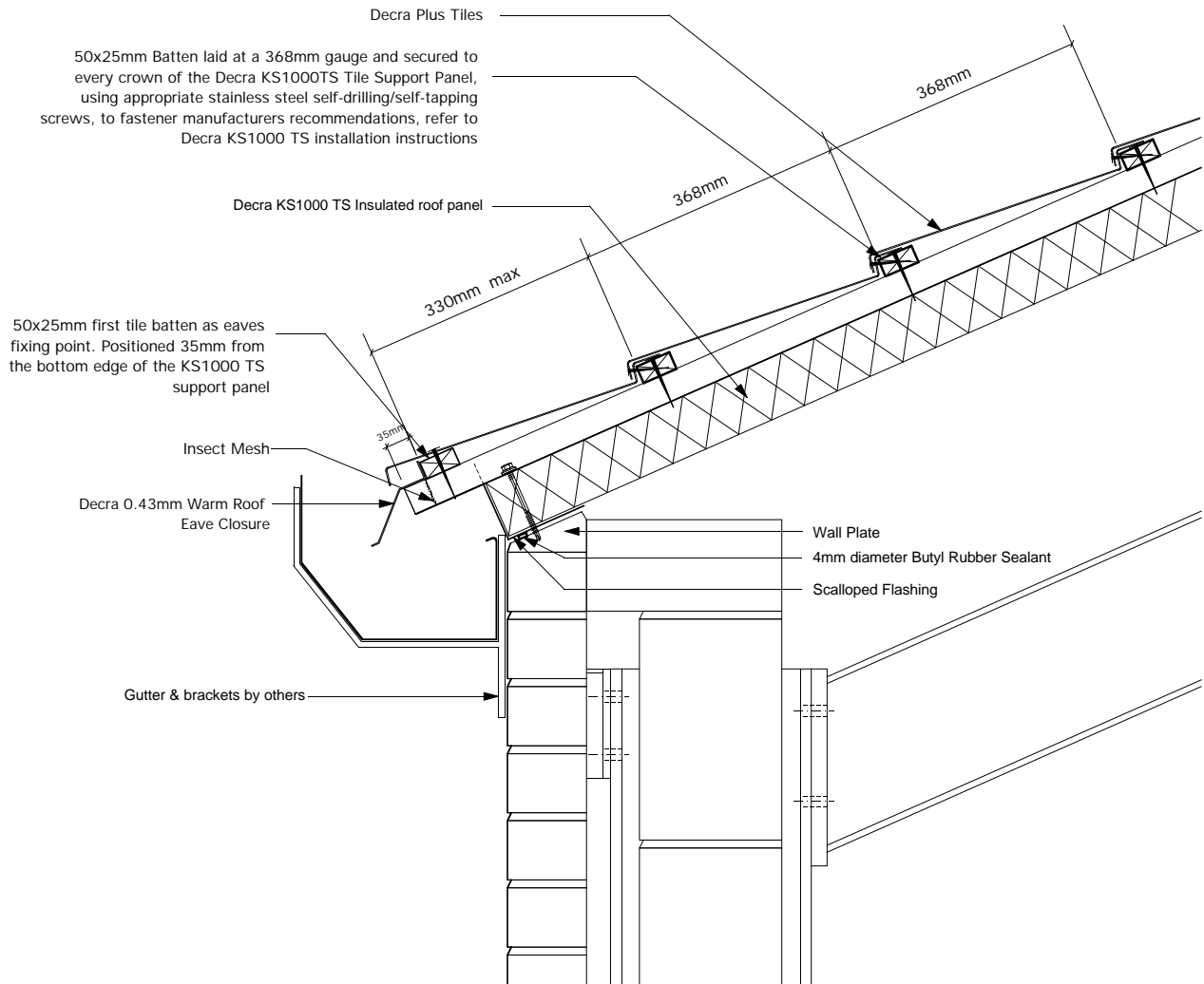

**Warm Roof Eaves Detail**  
Scale 1:10

**Notes:**

This detail is to be read in conjunction with the instructions for the Decra KS1000 TS tile support system.

On eaves course of tile, the tiles are fixed vertically through the high point of the tile into the fascia board or batten directly behind the fascia with pre-coated Decra Plus Fixing Nails or Decra Plus Fixing Screws. The nail/screw heads to be covered with a finishing kit (supplied by Decra).

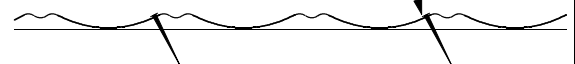

TS010

**Decra®**  
Roof Systems Limited

A member of the Icopal Group



Unit 4  
Crompton Fields  
Crompton Way  
Crawley  
West Sussex  
RH10 9QB

telephone: (01293) 545058/9  
fax: (01293) 562709

email: [technical@decra.co.uk](mailto:technical@decra.co.uk)  
web-Site: <http://www.decra.co.uk>

The copyright of this drawing and detail information belongs to Decra Roof Systems Limited. Reproduction or amendment outwith the terms of the licensing agreement by other parties is expressly forbidden.

**DECRA PLUS**

CONTENT **WARM ROOF EAVES DETAIL  
NO EAVES OVERHANG**

DRAWING SCALE **1:10**

DATE **12/01/04**

DRAWING NO **DPSW011**

REVISION

10° roof pitch minimum  
24° roof pitch illustrated

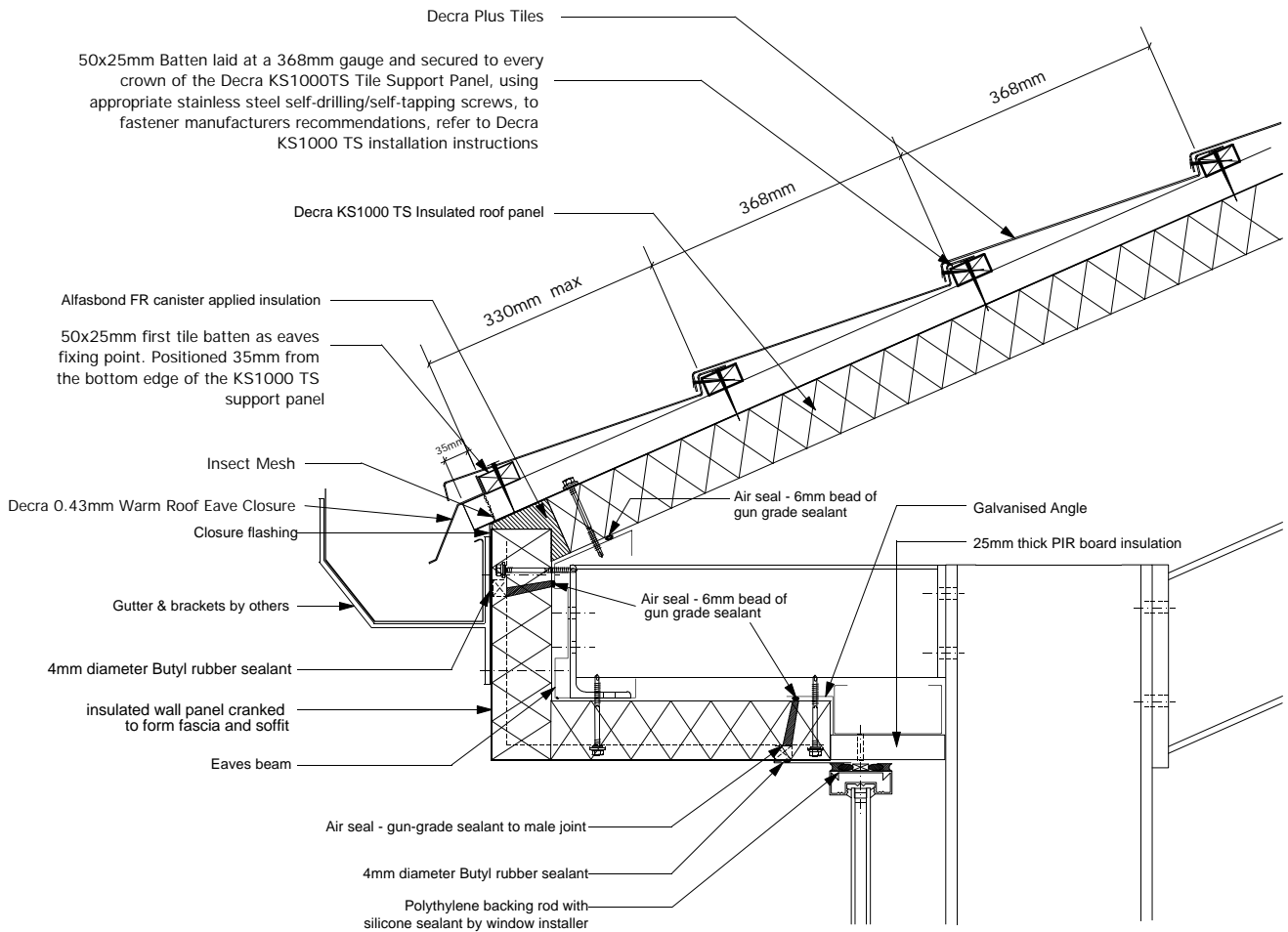

**Warm Roof Eaves Detail**  
Scale 1:10

This detail is to be read in conjunction with the instructions for the Decra KS1000 TS tile support system.

On eaves course of tile, the tiles are fixed vertically through the high point of the tile into the fascia board or batten directly behind the fascia with pre-coated Decra Plus Fixing Nails or Decra Plus Fixing Screws. The nail/screw heads to be covered with a finishing kit (supplied by Decra).

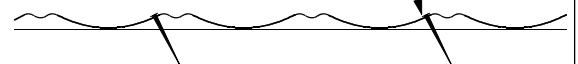

TS011

**Decra®**  
Roof Systems Limited

A member of the Icopal Group



Unit 4  
Crompton Fields  
Crompton Way  
Crawley  
West Sussex  
RH10 9QB

telephone: (01293) 545058/9

fax: (01293) 562709

email: [technical@decra.co.uk](mailto:technical@decra.co.uk)

web-Site: <http://www.decra.co.uk>

**DECRA PLUS**

CONTENT **WARM ROOF EAVES DETAIL  
EAVES OVERHANG OVER  
DOOR OR WINDOW OPENING**

DRAWING SCALE **1:10**

DATE **12/01/04**

DRAWING NO **DPSW012**

REVISION

The copyright of this drawing and detail information belongs to Decra Roof Systems Limited. Reproduction or amendment outwith the terms of the licensing agreement by other parties is expressly forbidden.

10° roof pitch minimum  
24° roof pitch illustrated

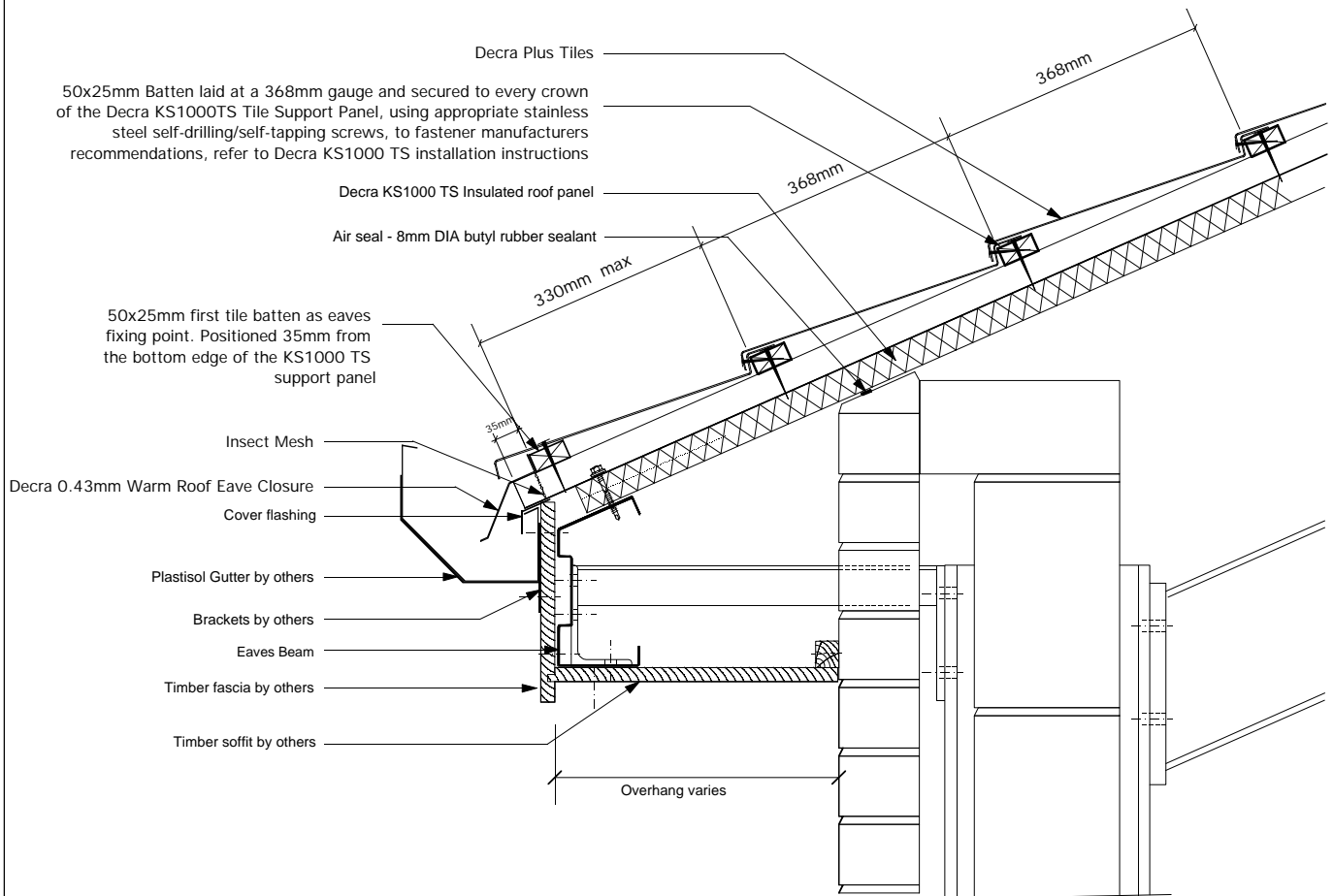

**Warm Roof Eaves Detail**  
Scale 1:10

**Notes:**

This detail is to be read in conjunction with the instructions for the Decra KS1000 TS tile support system.

On eaves course of tile, the tiles are fixed vertically through the high point of the tile into the fascia board or batten directly behind the fascia with pre-coated Decra Plus Fixing Nails or Decra Plus Fixing Screws. The nail/screw heads to be covered with a finishing kit (supplied by Decra).

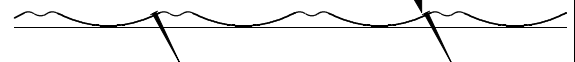

**Decra**<sup>®</sup>  
Roof Systems Limited

A member of the Icopal Group



Unit 4  
Crompton Fields  
Crompton Way  
Crawley  
West Sussex  
RH10 9QB

telephone: (01293) 545058/9

fax: (01293) 562709

email: [technical@decra.co.uk](mailto:technical@decra.co.uk)

web-Site: <http://www.decra.co.uk>

**DECRA PLUS**

CONTENT **WARM ROOF EAVES DETAIL  
EAVES GUTTER AND BRACKET  
FOR GUTTER CALCULATION**

DRAWING SCALE **1:10**

DATE **12/01/04**

DRAWING NO **DPSW013**

REVISION

The copyright of this drawing and detail information belongs to Decra Roof Systems Limited. Reproduction or amendment outwith the terms of the licensing agreement by other parties is expressly forbidden.

10° roof pitch minimum  
24° roof pitch illustrated

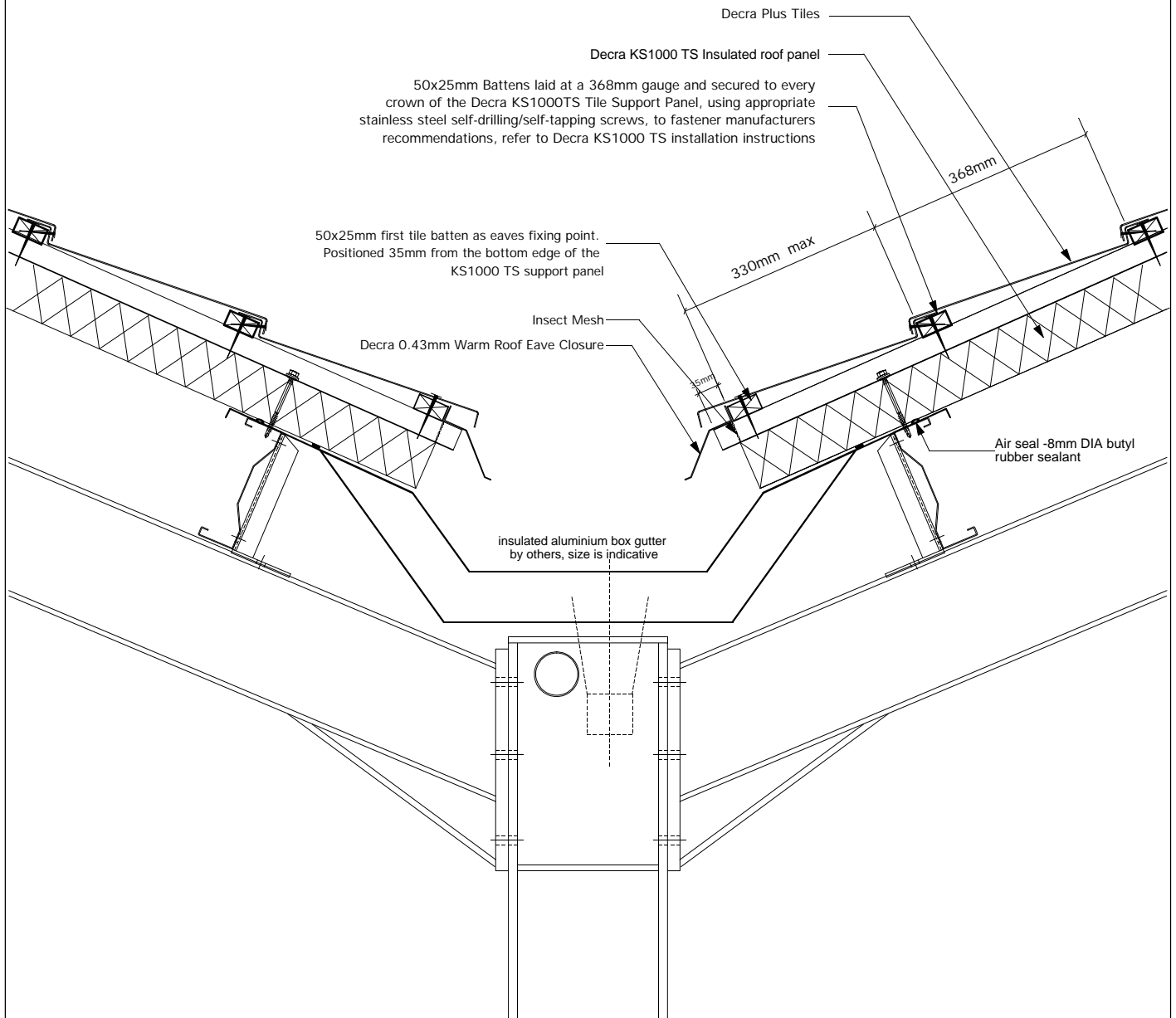

**Warm Roof Eaves Detail at internal box gutter**  
Scale 1:10

**Notes:**

This detail is to be read in conjunction with the instructions for the Decra KS1000 TS tile support system.

On eaves course of tile, the tiles are fixed vertically through the high point of the tile into the fascia board or batten directly behind the fascia with precoated Decra Plus Fixing Nails or Decra Plus Fixing Screws. The nail/screw heads to be covered with a finishing kit (supplied by Decra).

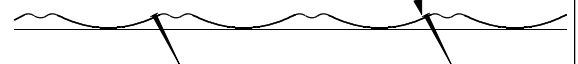

TS009

**Decra®**  
Roof Systems Limited

A member of the Icopal Group



Unit 4  
Crompton Fields  
Crompton Way  
Crawley  
West Sussex  
RH10 9QB

telephone: (01293) 545058/9  
fax: (01293) 562709

email: [technical@decra.co.uk](mailto:technical@decra.co.uk)  
web-Site: <http://www.decra.co.uk>

The copyright of this drawing and detail information belongs to Decra Roof Systems Limited. Reproduction or amendment outwith the terms of the licensing agreement by other parties is expressly forbidden.

**DECRA PLUS**

CONTENT

**WARM ROOF EAVES DETAIL  
INTERNAL BOX GUTTER**

DRAWING SCALE

**1:10**

DATE

**12/01/04**

DRAWING NO

**DPSW014**

REVISION

10° roof pitch minimum  
24° roof pitch illustrated

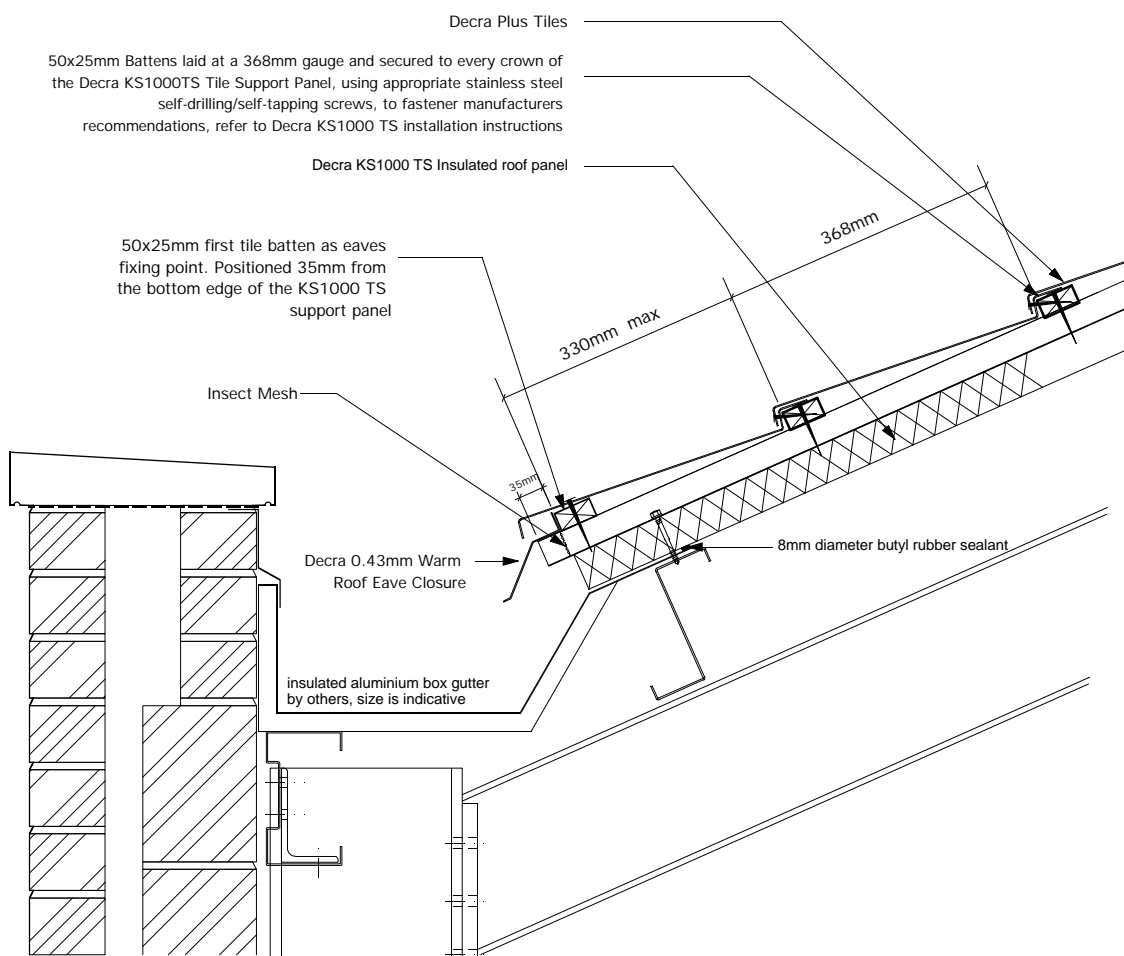

## Warm Roof Eaves Detail

Scale 1:10

### Notes:

This detail is to be read in conjunction with the instructions for the Decra KS1000 TS tile support system.

On eaves course of tile, the tiles are fixed vertically through the high point of the tile into the fascia board or batten directly behind the fascia with pre-coated Decra Plus Fixing Nails or Decra Plus Fixing Screws. The nail/screw heads to be covered with a finishing kit (supplied by Decra).

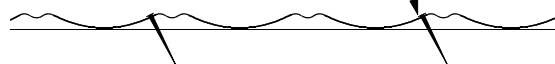

TS018

**Decra**<sup>®</sup>  
Roof Systems Limited

A member of the Icopal Group



Unit 4  
Crompton Fields  
Crompton Way  
Crawley  
West Sussex  
RH10 9QB

telephone: (01293) 545058/9  
fax: (01293) 562709

email: [technical@decra.co.uk](mailto:technical@decra.co.uk)  
web-Site: <http://www.decra.co.uk>

**DECRA PLUS**

CONTENT

**WARM ROOF EAVES DETAIL  
PARAPET BOX GUTTER**

DRAWING SCALE

**1:10**

DATE

**12/01/04**

DRAWING NO

**DPSW015**

REVISION

The copyright of this drawing and detail information belongs to Decra Roof Systems Limited. Reproduction or amendment outwith the terms of the licensing agreement by other parties is expressly forbidden.

10° roof pitch minimum  
24° roof pitch illustrated

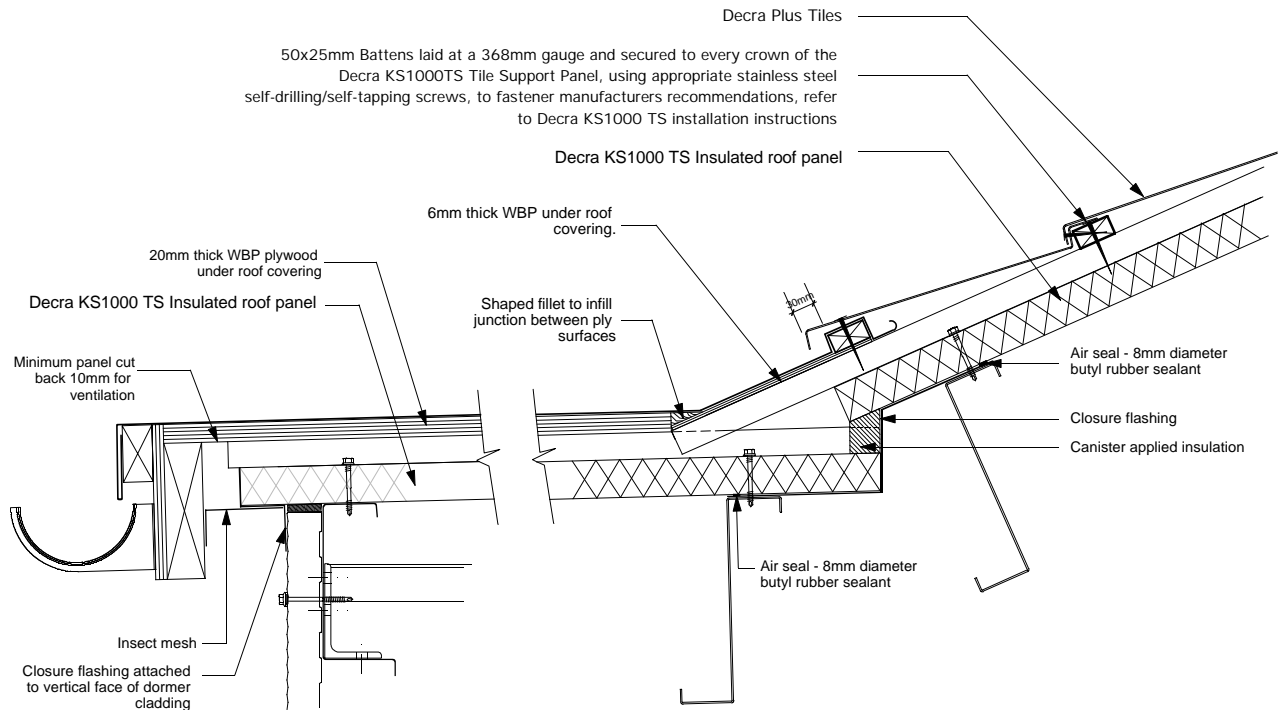

## Warm Roof Eaves Detail at dormer window head

Scale 1:10

### Notes:

This detail is to be read in conjunction with the instructions for the Decra KS1000 TS tile support system.

On eaves course of tile, the tiles are fixed vertically through the high point of the tile into the fascia board or batten directly behind the fascia with pre-coated Decra Plus Fixing Nails or Decra Plus Fixing Screws. The nail/screw heads to be covered with a finishing kit (supplied by Decra).

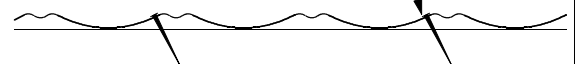

TS020

**Decra**<sup>®</sup>  
Roof Systems Limited

A member of the Icopal Group



Unit 4  
Crompton Fields  
Crompton Way  
Crawley  
West Sussex  
RH10 9QB

telephone: (01293) 545058/9

fax: (01293) 562709

email: [technical@decra.co.uk](mailto:technical@decra.co.uk)

web-Site: <http://www.decra.co.uk>

**DECRA PLUS**

CONTENT

**WARM ROOF EAVES DETAIL  
AT DORMER WINDOW HEAD**

DRAWING SCALE

**1:10**

DATE

**12/01/04**

DRAWING NO

**DPSW016**

REVISION

The copyright of this drawing and detail information belongs to Decra Roof Systems Limited. Reproduction or amendment outwith the terms of the licensing agreement by other parties is expressly forbidden.

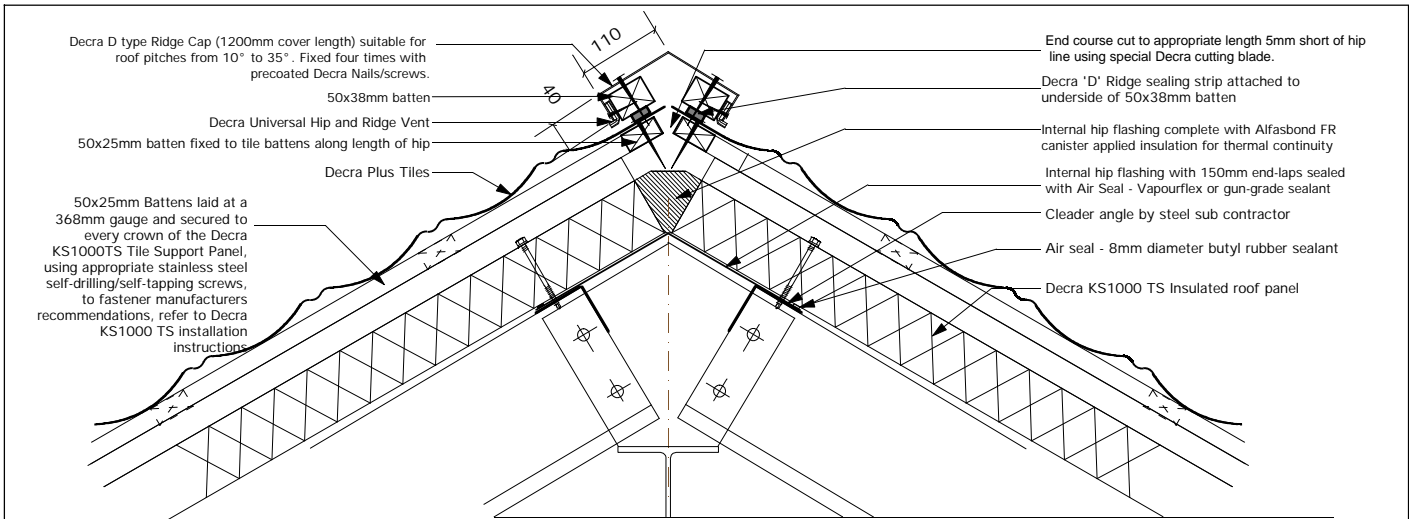

### Hip Detail Using Decra 'D' Ridge

Scale 1:10

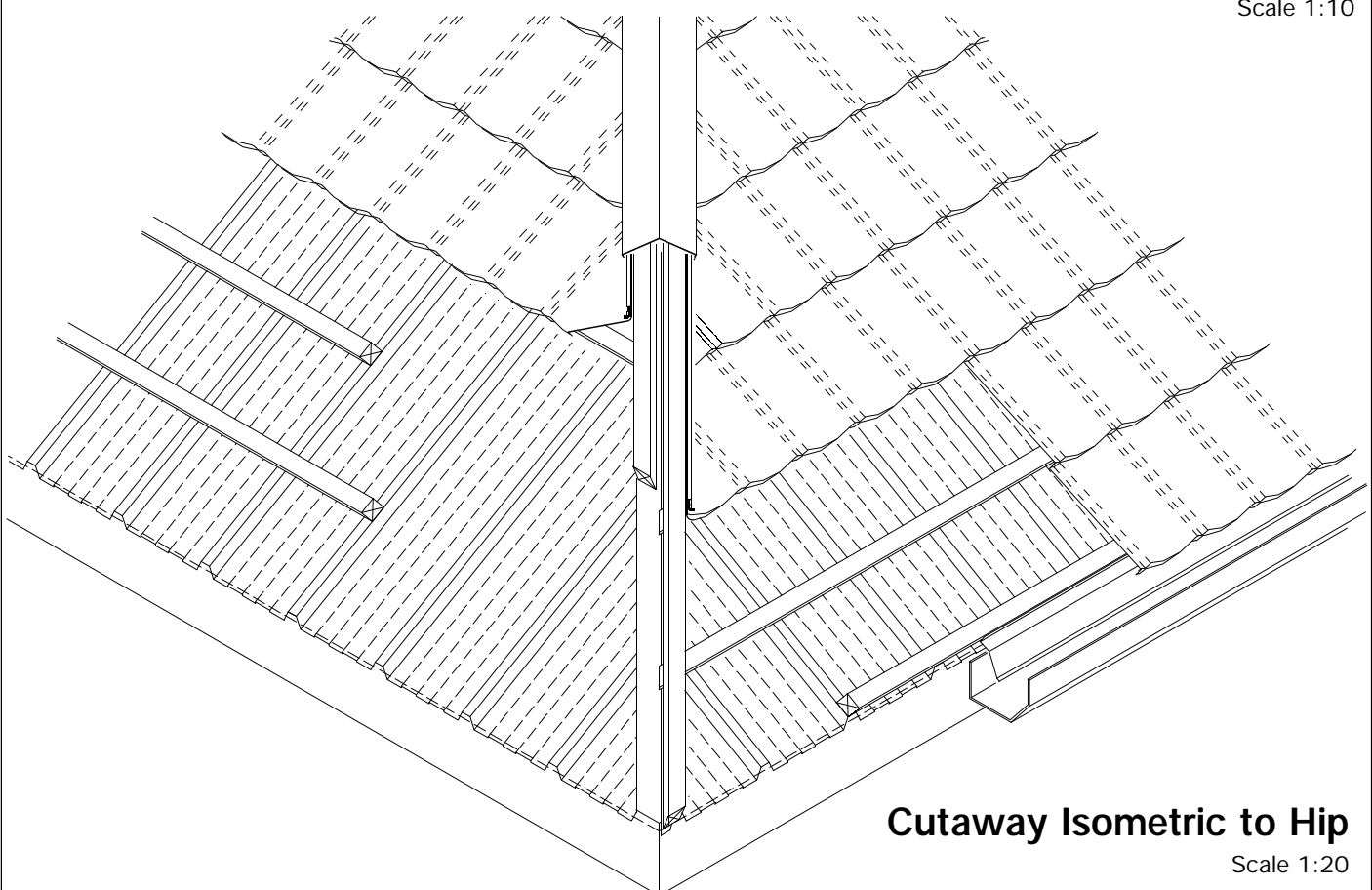

### Cutaway Isometric to Hip

Scale 1:20

**Notes:**

This detail is to be read in conjunction with the instructions for the Decra KS1000 TS tile support system.

*Decra 'D' Ridge Hip End Closure Units are available*

TS004

**Decra**<sup>®</sup>  
Roof Systems Limited  
A member of the Icopal Group



Unit 4  
Crompton Fields  
Crompton Way  
Crawley  
West Sussex  
RH10 9QB

telephone: (01293) 545058/9  
fax: (01293) 562709  
email: [technical@decra.co.uk](mailto:technical@decra.co.uk)  
web-Site: <http://www.decra.co.uk>

The copyright of this drawing and detail information belongs to Decra Roof Systems Limited. Reproduction or amendment outwith the terms of the licensing agreement by other parties is expressly forbidden.

<b>DECRA PLUS</b>		
CONTENT	<b>WARM ROOF HIP DETAIL USING VENTILATED 'D' HIP RIDGE</b>	
DRAWING SCALE	<b>1:10</b>	DATE <b>12/01/04</b>
DRAWING NO	<b>DPSW020</b>	REVISION

10° minimum  
24° illustrated

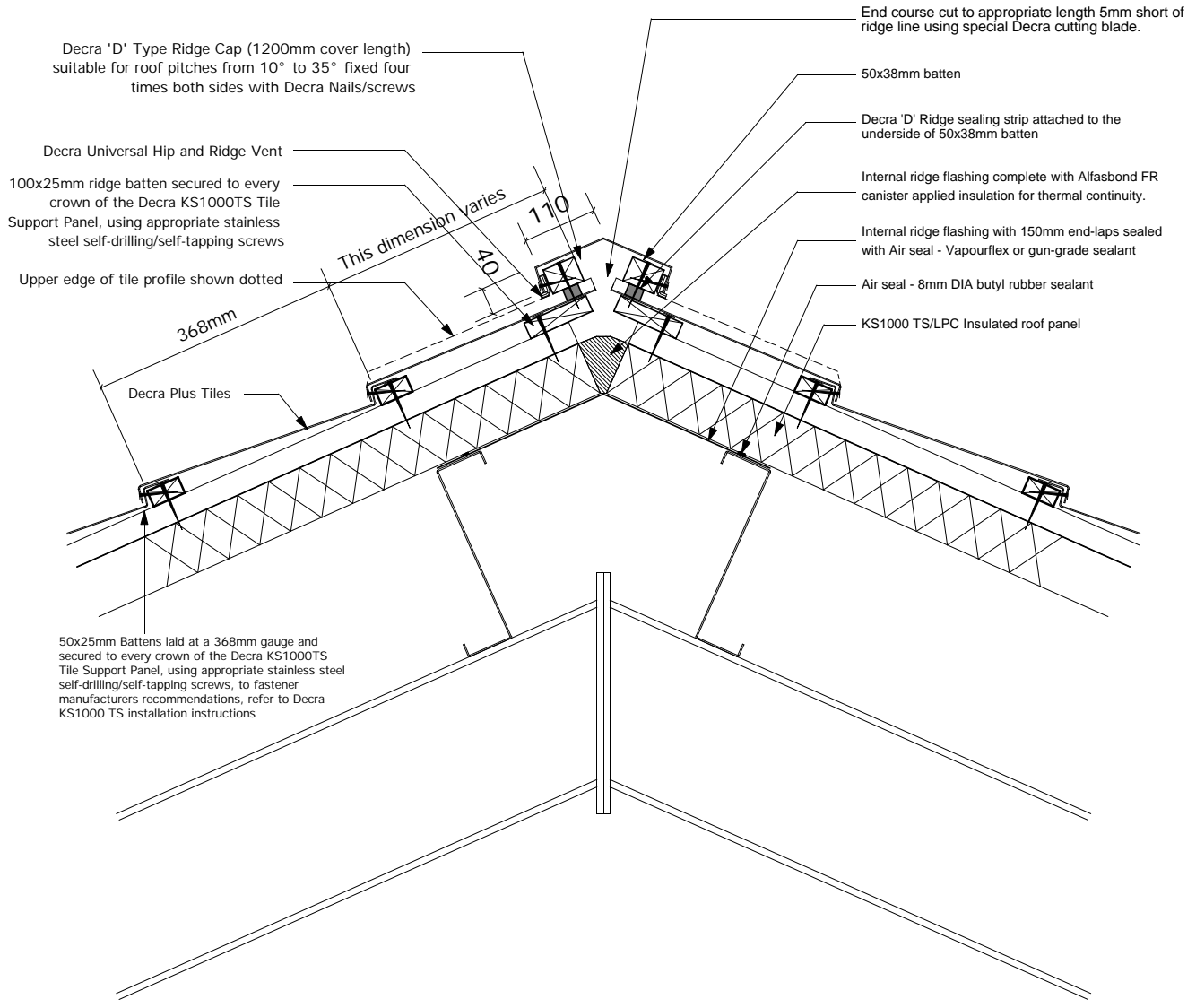

**Vented 'D' Ridge Detail**  
Scale 1:10

**Notes:**

This detail is to be read in conjunction with the instructions for the Decra KS1000 TS tile support system.

*Preformed Decra D Ridge end closure units are available*

TS002

**Decra®**  
Roof Systems Limited  
A member of the Icopal Group



Unit 4  
Crompton Fields  
Crompton Way  
Crawley  
West Sussex  
RH10 9QB

telephone: (01293) 545058/9  
fax: (01293) 562709  
email: [technical@decra.co.uk](mailto:technical@decra.co.uk)  
web-Site: <http://www.decra.co.uk>

The copyright of this drawing and detail information belongs to Decra Roof Systems Limited. Reproduction or amendment outwith the terms of the licensing agreement by other parties is expressly forbidden.

<b>DECRA PLUS</b>		
CONTENT	<b>WARM ROOF RIDGE DETAIL VENTILATED 'D' RIDGE USING UNIVERSAL 'D' RIDGE VENTILATOR</b>	
DRAWING SCALE	<b>1:10</b>	DATE <b>12/01/04</b>
DRAWING NO	<b>DPSW021</b>	REVISION

10° minimum  
24° illustrated

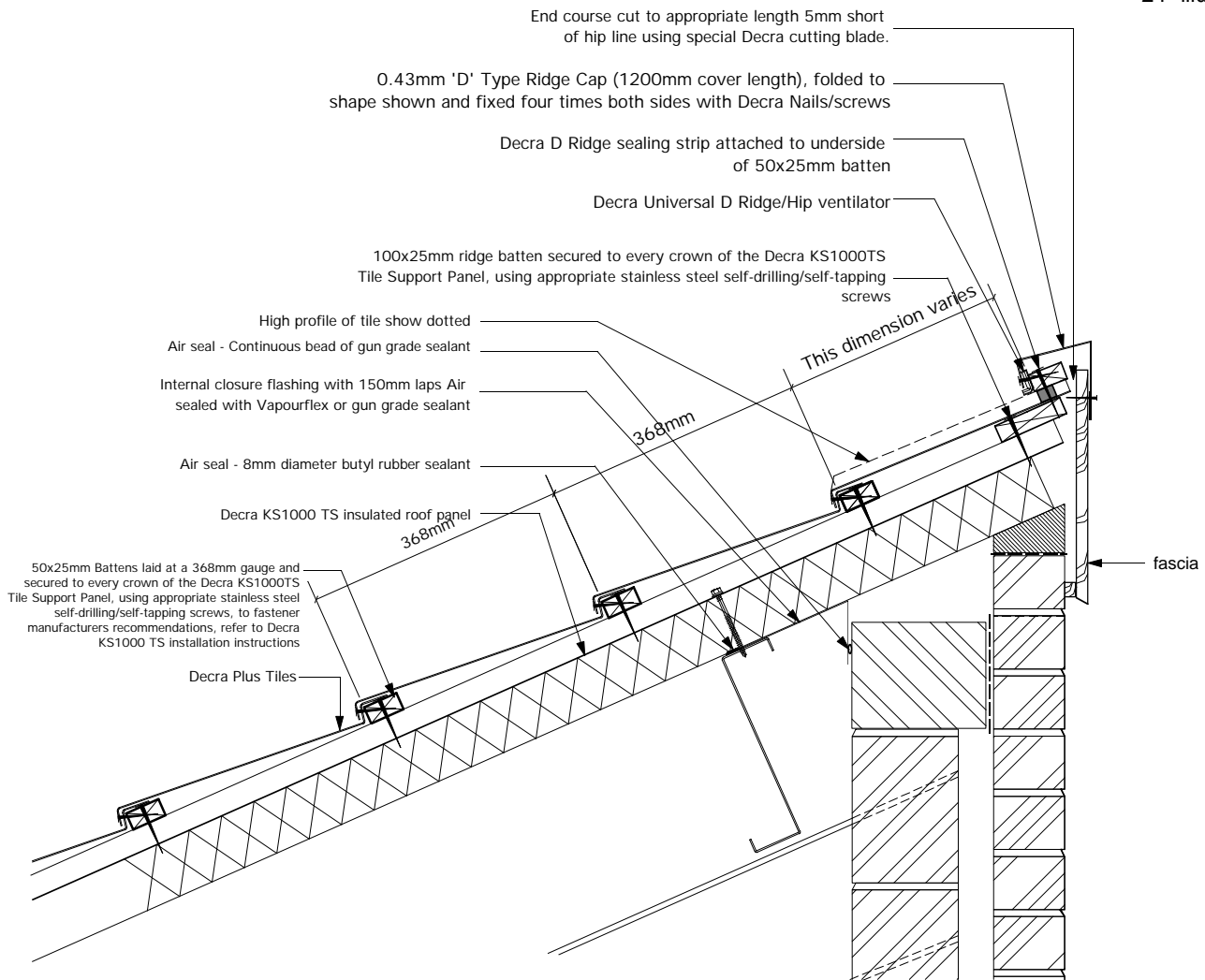

**Mono Ridge Detail**  
Scale 1:10

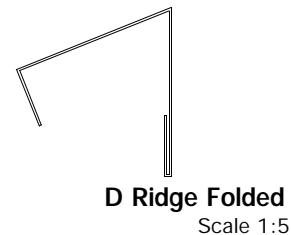

**Notes:**

This detail is to be read in conjunction with the instructions for the Decra KS1000 TS tile support system.

TS007

**Decra®**  
Roof Systems Limited

A member of the Icopal Group



Unit 4  
Crompton Fields  
Crompton Way  
Crawley  
West Sussex  
RH10 9QB

telephone: (01293) 545058/9  
fax: (01293) 562709

email: [technical@decra.co.uk](mailto:technical@decra.co.uk)  
web-Site: <http://www.decra.co.uk>

The copyright of this drawing and detail information belongs to Decra Roof Systems Limited. Reproduction or amendment outwith the terms of the licensing agreement by other parties is expressly forbidden.

**DECRA PLUS**

CONTENT  
**WARM ROOF RIDGE DETAIL  
MONO-RIDGE WITH DECRA UNIVERSAL  
D RIDGE/HIP VENTILATOR**

DRAWING SCALE  
**1:10**

DATE  
**13/01/04**

DRAWING NO  
**DPSW024**

REVISION

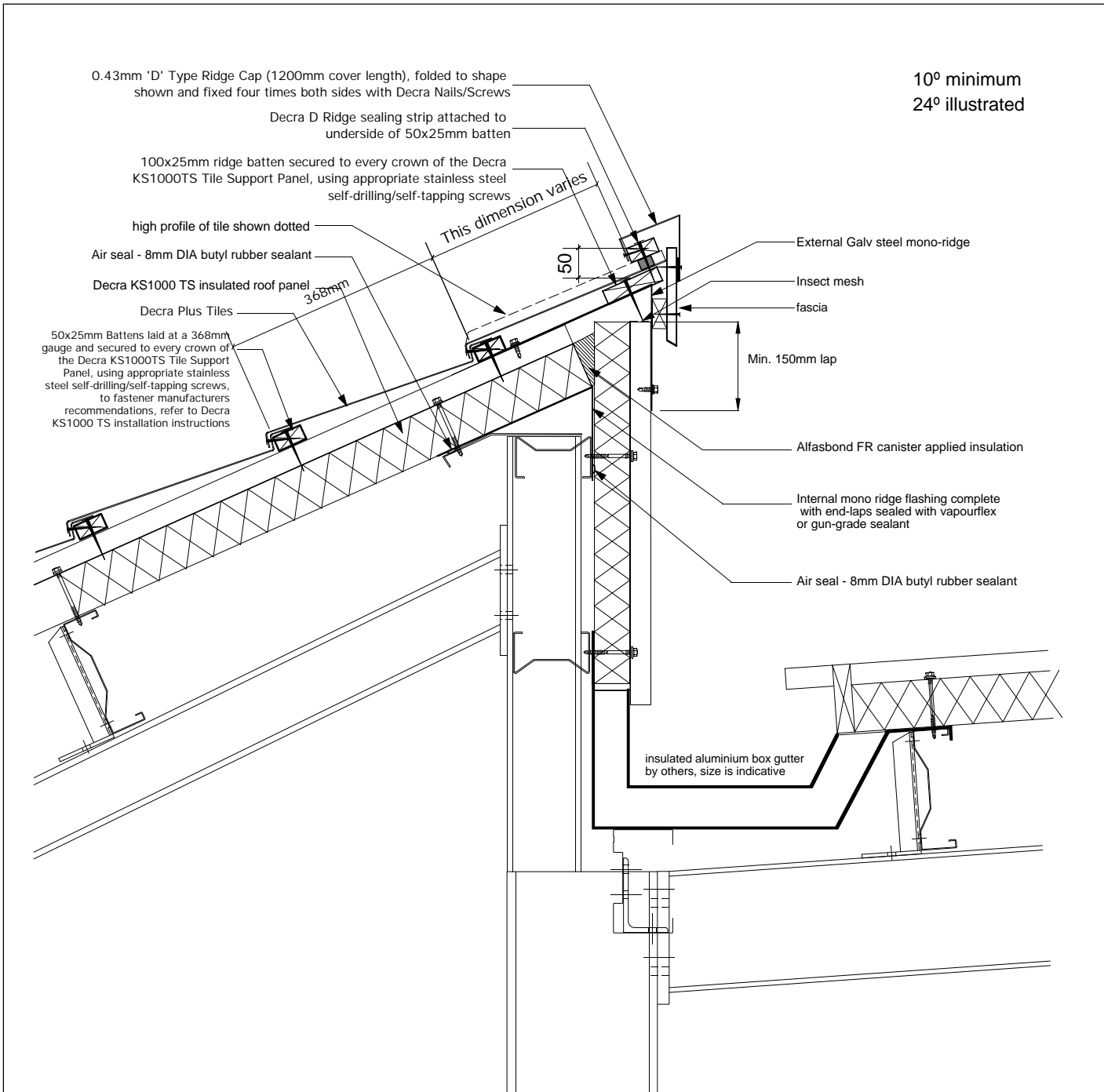

10° minimum  
24° illustrated

**Mono Ridge Mansard Roof Detail**  
Scale 1:10

**Notes:**

This detail is to be read in conjunction with the instructions for the Decra KS1000 TS tile support system.

TS008

**Decra**<sup>®</sup>  
Roof Systems Limited  
A member of the Icopal Group



Unit 4  
Crompton Fields  
Crompton Way  
Crawley  
West Sussex  
RH10 9QB

telephone: (01293) 545058/9  
fax: (01293) 562709  
email: [technical@decra.co.uk](mailto:technical@decra.co.uk)  
web-Site: <http://www.decra.co.uk>

The copyright of this drawing and detail information belongs to Decra Roof Systems Limited. Reproduction or amendment outwith the terms of the licensing agreement by other parties is expressly forbidden.

<b>DECRA PLUS</b>		
CONTENT	<b>WARM ROOF RIDGE DETAIL MONO-RIDGE MANSARD ROOF</b>	
DRAWING SCALE	<b>1:10</b>	DATE <b>13/01/04</b>
DRAWING NO	<b>DPSW030</b>	REVISION

10° minimum  
24° illustrated

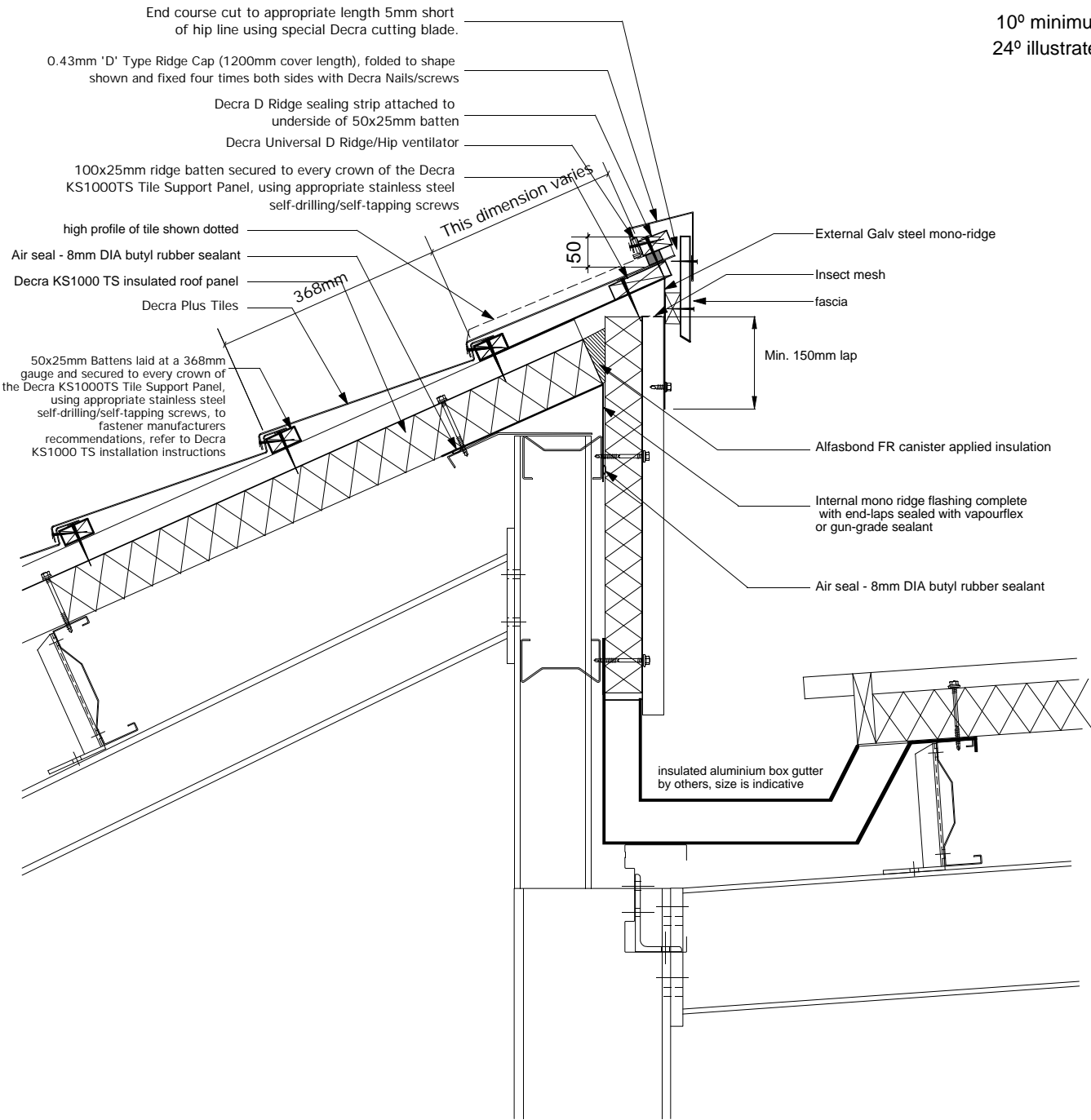

**Mono Ridge Mansard Roof Detail**  
Scale 1:10

**Notes:**  
This detail is to be read in conjunction with the instructions for the Decra KS1000 TS tile support system.

TS008

**Decra®**  
Roof Systems Limited  
A member of the Icopal Group



Unit 4  
Crompton Fields  
Crompton Way  
Crawley  
West Sussex  
RH10 9QB

telephone: (01293) 545058/9  
fax: (01293) 562709  
email: [technical@decra.co.uk](mailto:technical@decra.co.uk)  
web-Site: <http://www.decra.co.uk>

The copyright of this drawing and detail information belongs to Decra Roof Systems Limited. Reproduction or amendment outwith the terms of the licensing agreement by other parties is expressly forbidden.

<b>DECRA PLUS</b>		
CONTENT	<b>WARM ROOF RIDGE DETAIL MONO-RIDGE MANSARD ROOF WITH DECRA UNIVERSAL RIDGE VENT</b>	
DRAWING SCALE	<b>1:10</b>	DATE <b>13/01/04</b>
DRAWING NO	<b>DPSW031</b>	REVISION

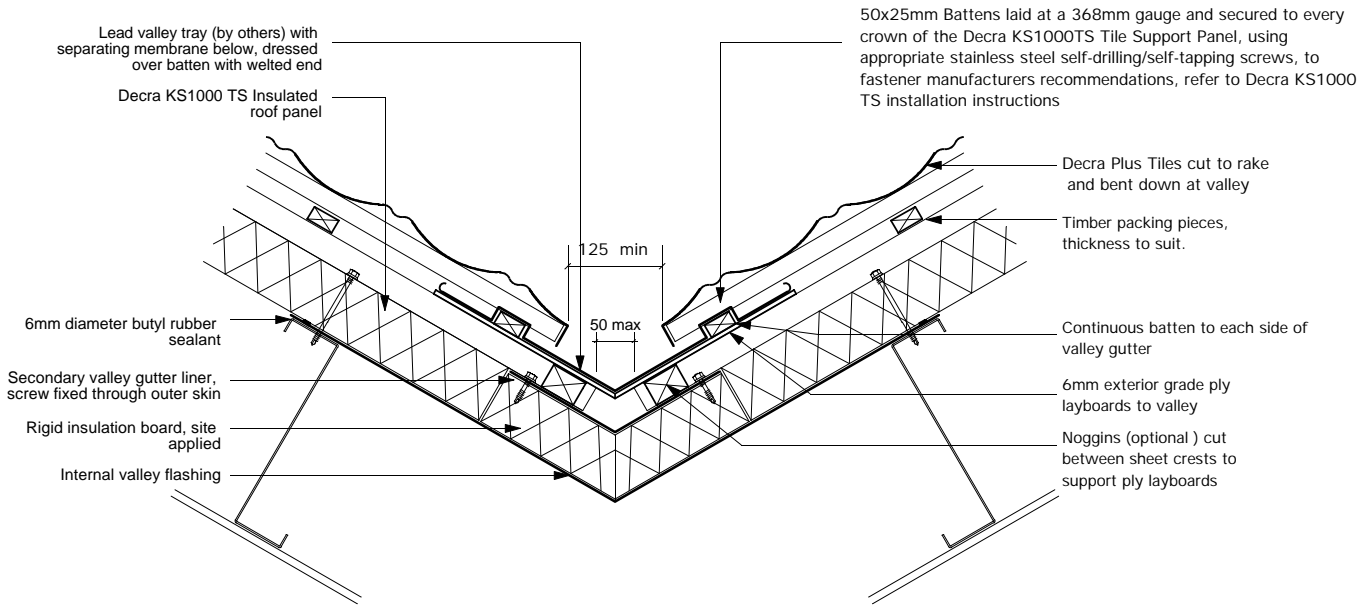

### Valley Detail using lead on ply layboards

Scale 1:10

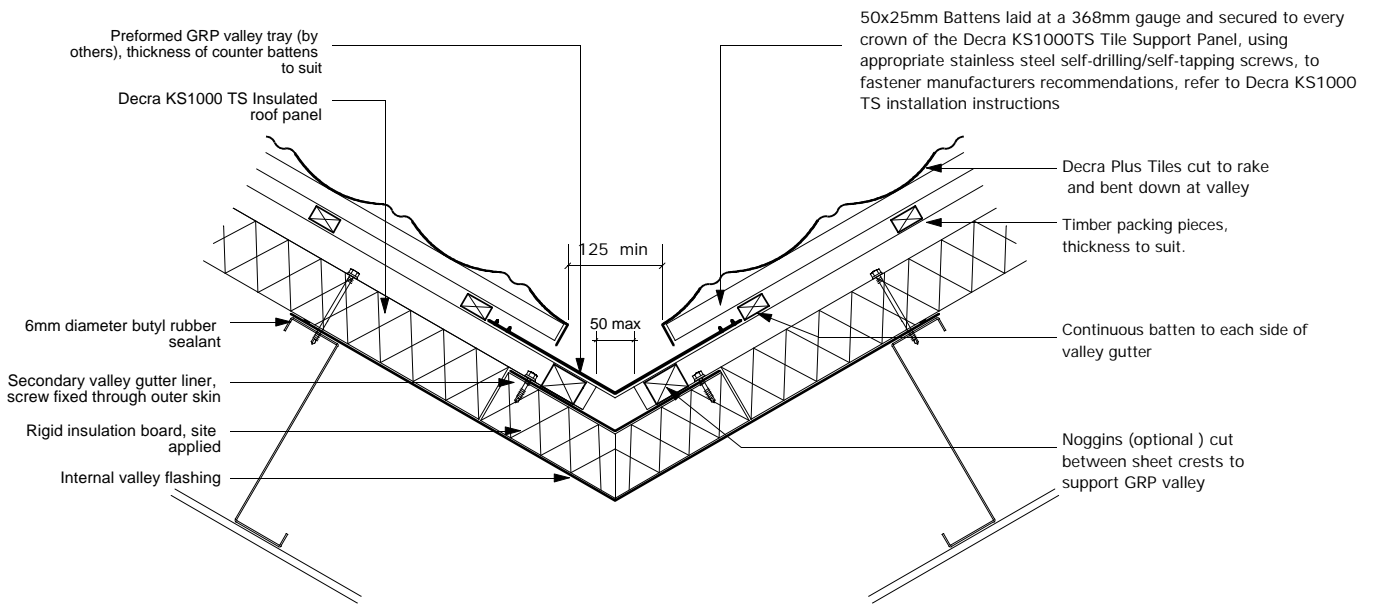

### GRP Valley Detail

Scale 1:10

#### Notes:

This detail is to be read in conjunction with the instructions for the Decra KS1000 TS tile support system.

Valley gutter sizes to be adjusted as required to comply with calculated width requirements of Code Of Practice as set out in BS 5534: Part1

The timber packing pieces are used to raise the tiling battens above the level of the rafters to create an upstand for the valley tray, and should be reduced from minimum 19mm thick across three or more sheet crests to avoid a visible rise in the tiling.

TS---

**Decra**<sup>®</sup>  
Roof Systems Limited

A member of the Icopal Group



Unit 4  
Crompton Fields  
Crompton Way  
Crawley  
West Sussex  
RH10 9QB

telephone: (01293) 545058/9  
fax: (01293) 562709

email: [technical@decra.co.uk](mailto:technical@decra.co.uk)  
web-Site: <http://www.decra.co.uk>

The copyright of this drawing and detail information belongs to Decra Roof Systems Limited. Reproduction or amendment outwith the terms of the licensing agreement by other parties is expressly forbidden.

## DECRA PLUS

CONTENT

WARM ROOF  
VALLEY DETAILS

DRAWING SCALE

1:10

DATE

13/01/04

DRAWING NO

DPSW035

REVISION

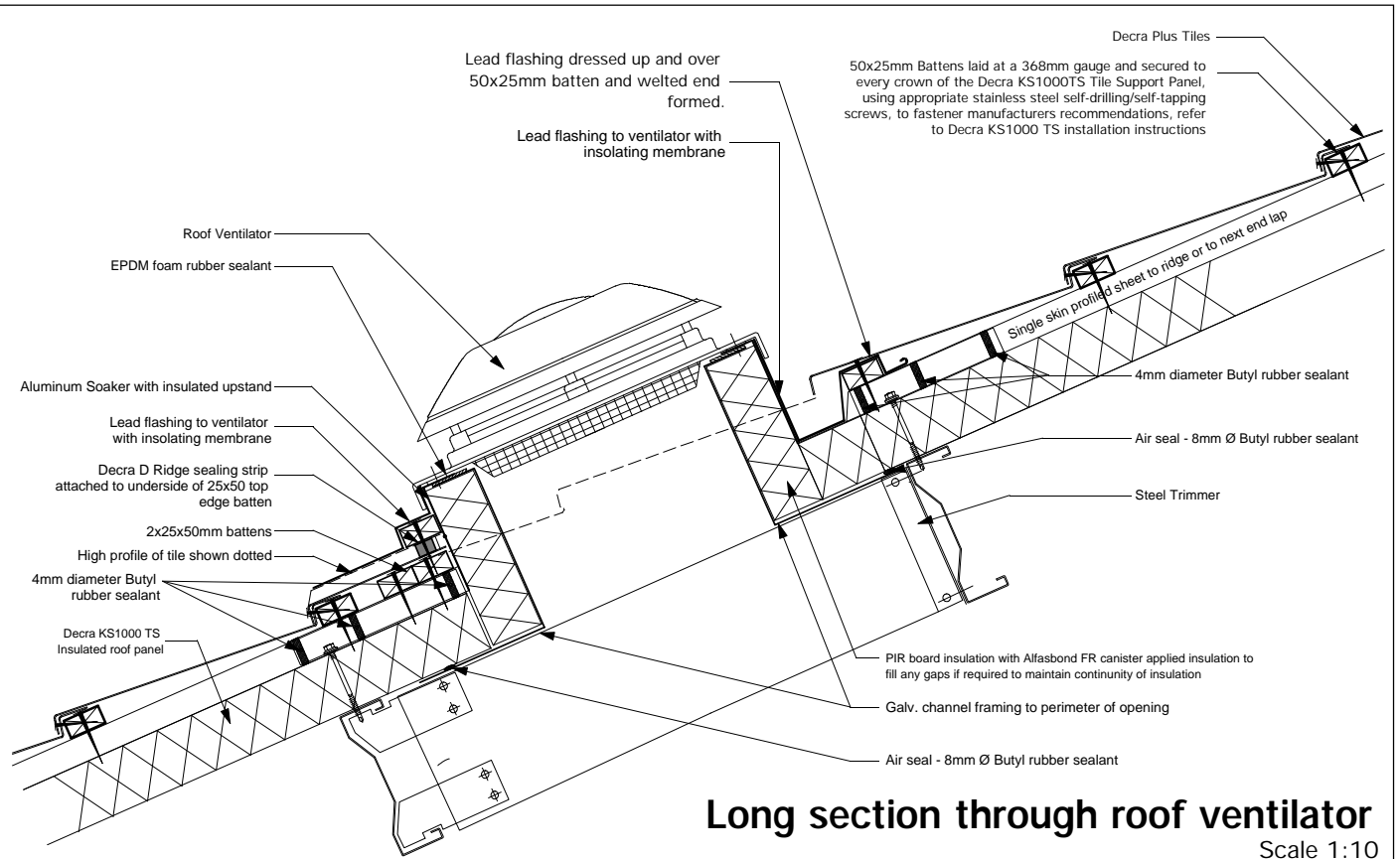

**Long section through roof ventilator**  
Scale 1:10

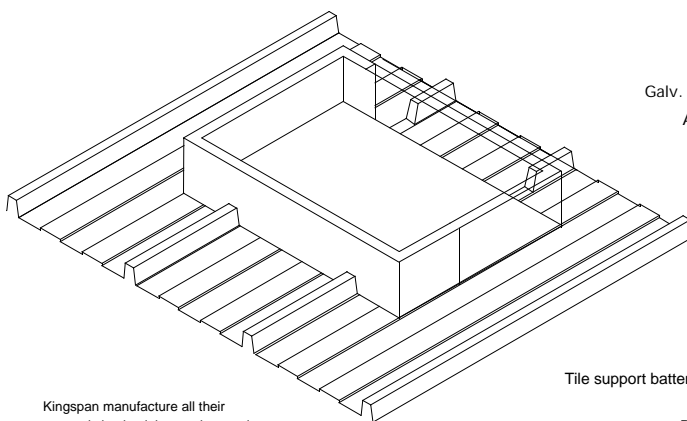

Kingspan manufacture all their upstands in aluminium and postpaint to matching roof colour.  
Note: correct, width, length & upstand lip should be specified

**Isometric of upstand flashing**  
not to scale

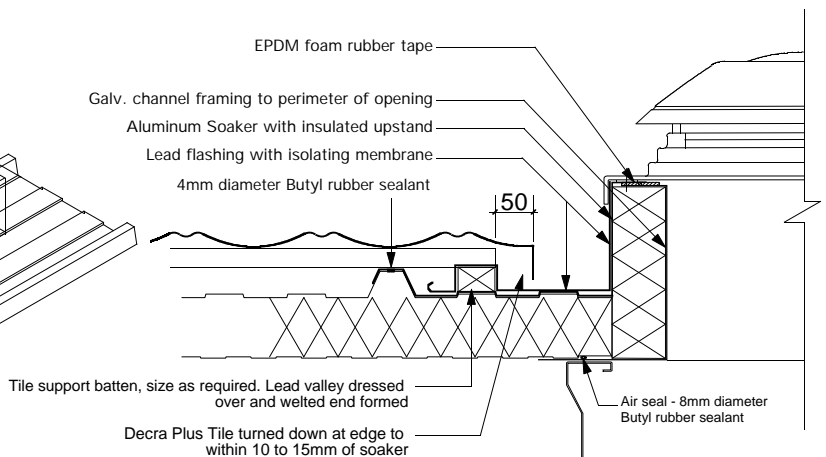

**Cross-section through roof ventilator**  
Scale 1:10

**Notes:**

This detail is to be read in conjunction with the instructions for the Decra KS1000 TS tile support system.

TS014

**Decra**<sup>®</sup>  
Roof Systems Limited

A member of the Icopal Group



Unit 4  
Crompton Fields  
Crompton Way  
Crawley  
West Sussex  
RH10 9QB

telephone: (01293) 545058/9  
fax: (01293) 562709

email: [technical@decra.co.uk](mailto:technical@decra.co.uk)  
web-Site: <http://www.decra.co.uk>

The copyright of this drawing and detail information belongs to Decra Roof Systems Limited. Reproduction or amendment outwith the terms of the licensing agreement by other parties is expressly forbidden.

**DECRA PLUS**

CONTENT

**WARM ROOF  
ROOF VENTILATOR**

DRAWING SCALE

**1:10**

DATE

**13/01/04**

DRAWING NO

**DPSW040**

REVISION

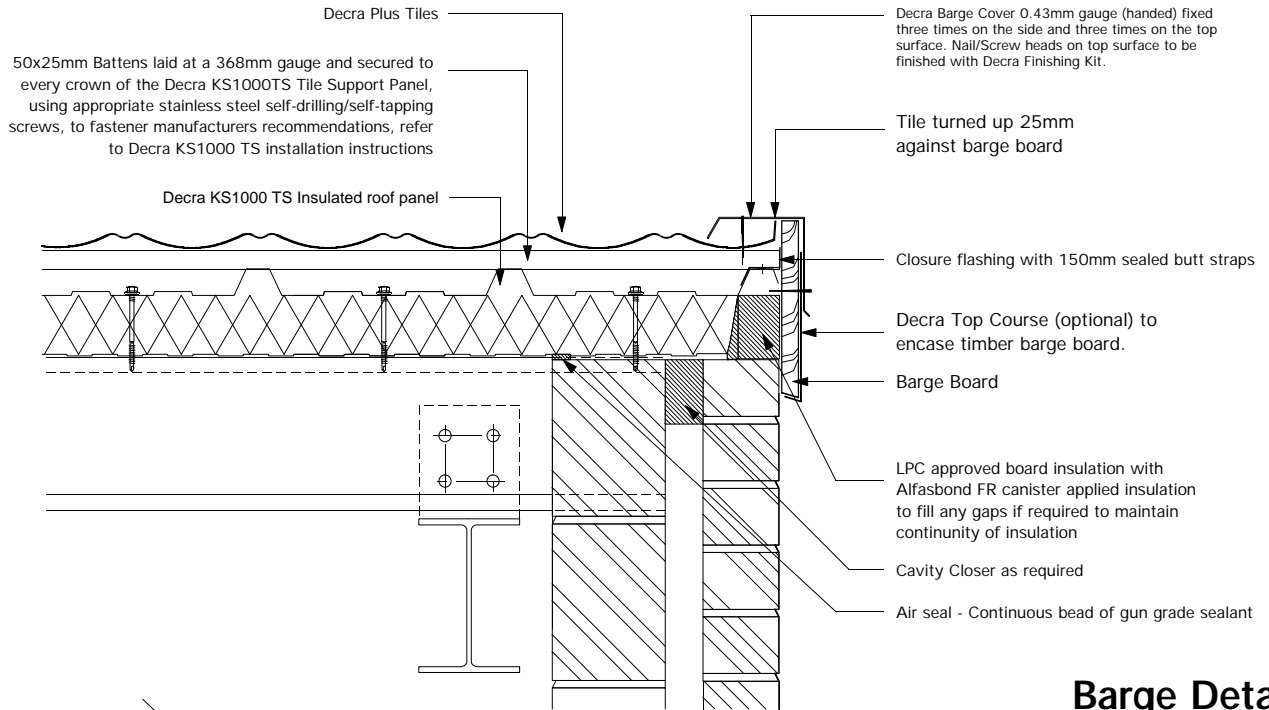

### Barge Detail

Scale 1:10

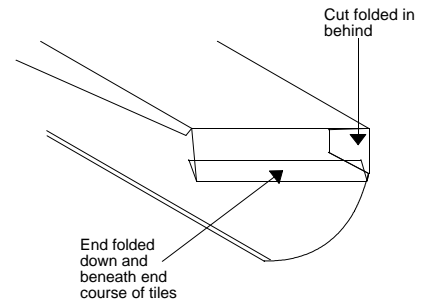
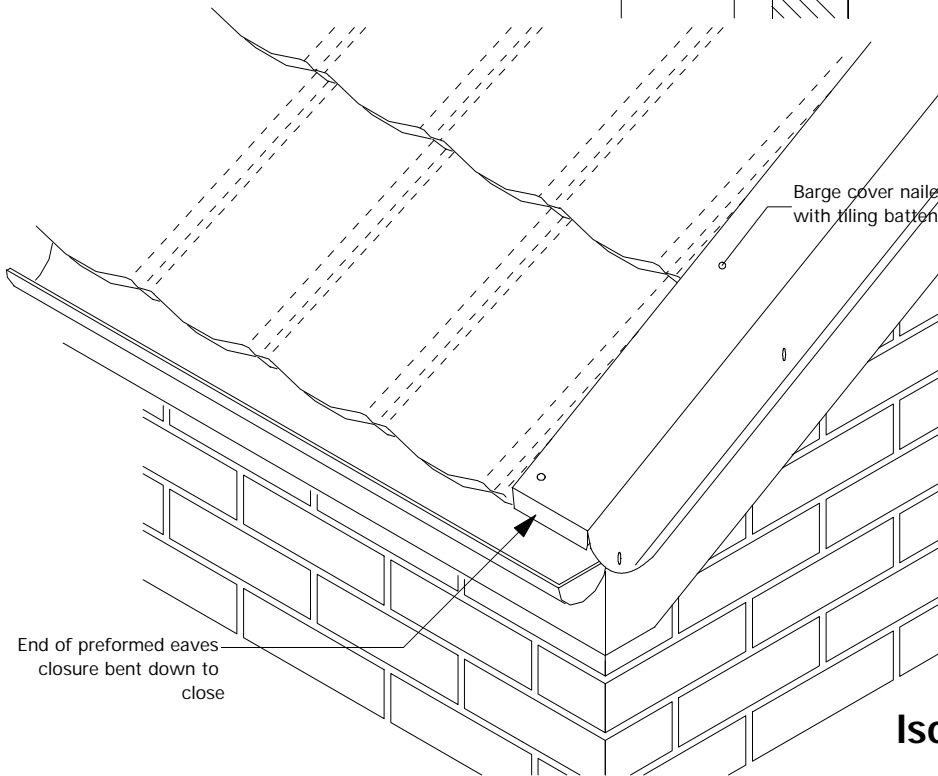

### Isometric View

Scale 1:5

### Isometric Detail at Gutter

Scale 1:10

#### Notes:

This detail is to be read in conjunction with the instructions for the Decra KS1000 TS tile support system.

*Decra Barge Covers available in 0.43mm standard gauge*

TS006

**Decra**<sup>®</sup>  
Roof Systems Limited

A member of the Icopal Group



Unit 4  
Crompton Fields  
Crompton Way  
Crawley  
West Sussex  
RH10 9QB

telephone: (01293) 545058/9

fax: (01293) 562709

email: [technical@decra.co.uk](mailto:technical@decra.co.uk)

web-Site: <http://www.decra.co.uk>

The copyright of this drawing and detail information belongs to Decra Roof Systems Limited. Reproduction or amendment outwith the terms of the licensing agreement by other parties is expressly forbidden.

## DECRA PLUS

CONTENT

WARM ROOF  
VERGE DETAIL

DRAWING SCALE

1:10

DATE

13/01/04

DRAWING NO

DPSW050

REVISION

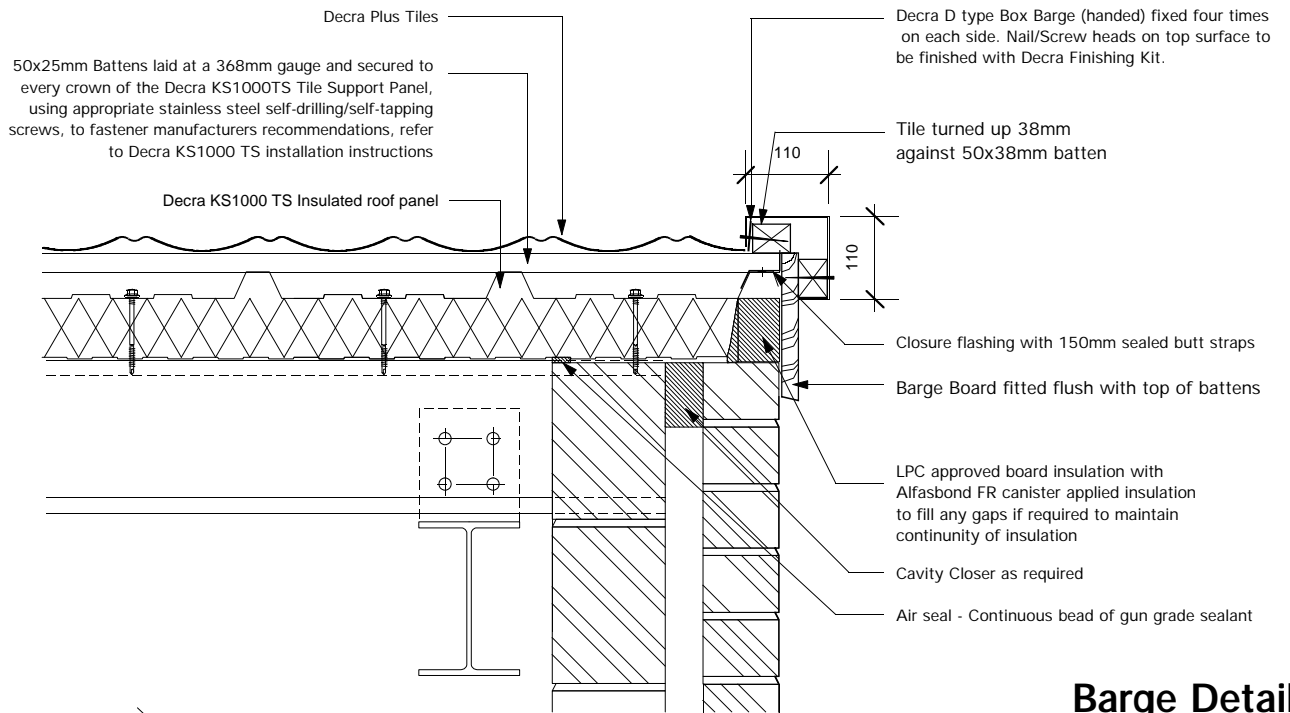

**Barge Detail**  
Scale 1:10

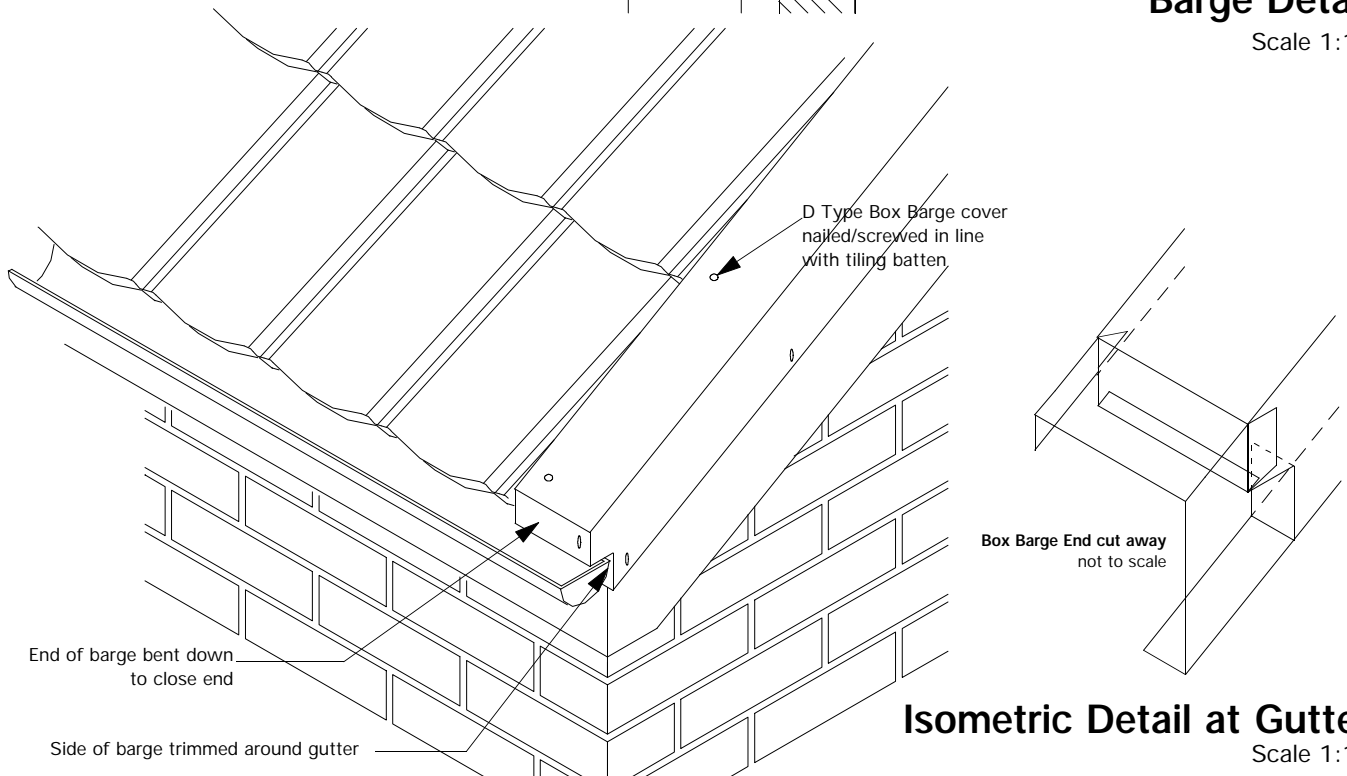

**Isometric Detail at Gutter**  
Scale 1:10

**Notes:**

This detail is to be read in conjunction with the instructions for the Decra KS1000 TS tile support system.

TS006

**Decra**<sup>®</sup>  
Roof Systems Limited  
A member of the Icopal Group



Unit 4  
Crompton Fields  
Crompton Way  
Crawley  
West Sussex  
RH10 9QB

telephone: (01293) 545058/9  
fax: (01293) 562709  
email: [technical@decra.co.uk](mailto:technical@decra.co.uk)  
web-Site: <http://www.decra.co.uk>

The copyright of this drawing and detail information belongs to Decra Roof Systems Limited. Reproduction or amendment outwith the terms of the licensing agreement by other parties is expressly forbidden.

**DECRA PLUS**

CONTENT

**WARM ROOF DETAIL  
VERGE DETAIL USING 'D' BOX BARGE**

DRAWING SCALE **1:10**

DATE **24/01/04**

DRAWING NO **DPSW051**

REVISION

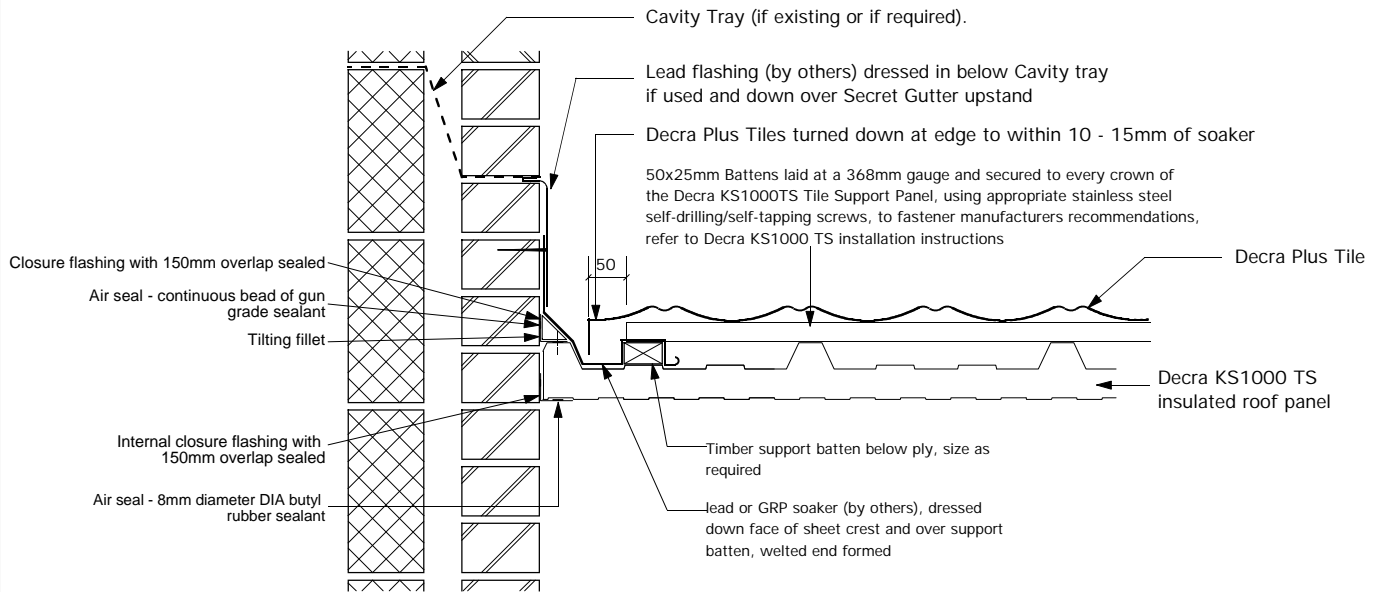

**Abutment Detail With Secret Gutter  
Detail at Crown abutting vertical surface**  
Scale 1:10

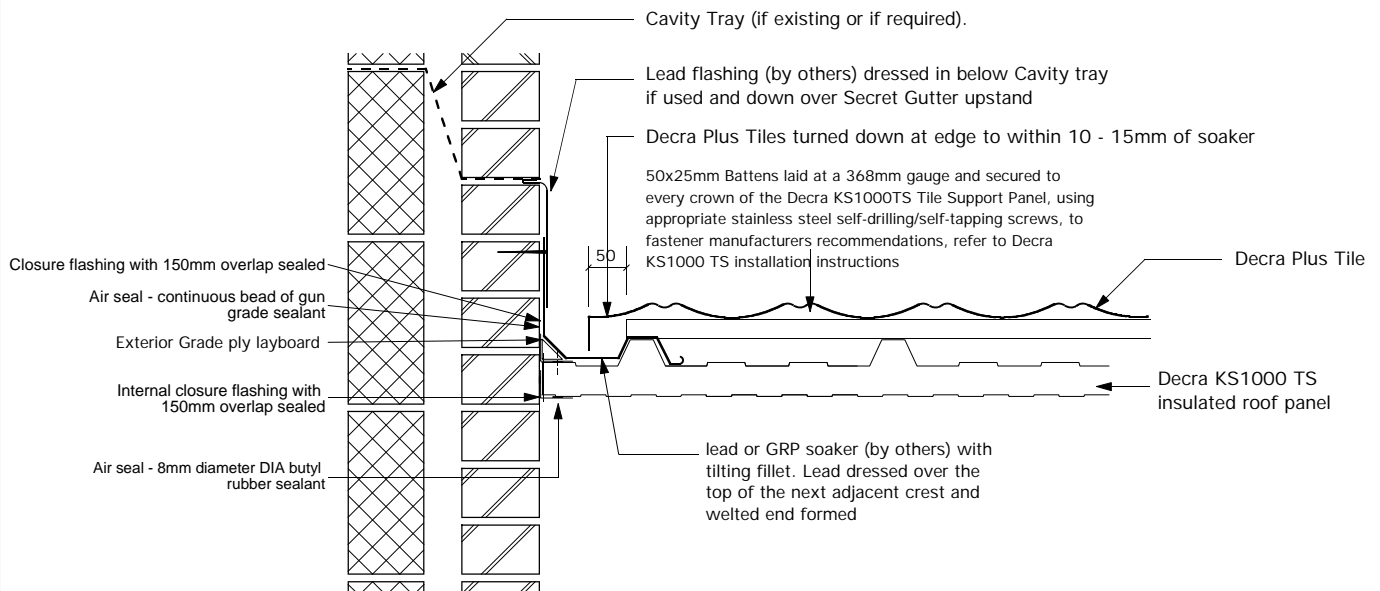

**Abutment Detail With Secret Gutter  
Detail at Valley abutting vertical surface**  
Scale 1:10

**Notes:**

This detail is to be read in conjunction with the instructions for the Decra KS1000 TS tile support system.

TS021

**Decra®**  
Roof Systems Limited

A member of the Icopal Group



Unit 4  
Crompton Fields  
Crompton Way  
Crawley  
West Sussex  
RH10 9QB

telephone: (01293) 545058/9  
fax: (01293) 562709

email: [technical@decra.co.uk](mailto:technical@decra.co.uk)  
web-Site: <http://www.decra.co.uk>

The copyright of this drawing and detail information belongs to Decra Roof Systems Limited. Reproduction or amendment outwith the terms of the licensing agreement by other parties is expressly forbidden.

**DECRA PLUS**

CONTENT

**WARM ROOF  
ABUTMENT DETAILS  
WITH SECRET GUTTER**

DRAWING SCALE

**1:10**

DATE

**13/01/04**

DRAWING NO

**DPSW052**

REVISION

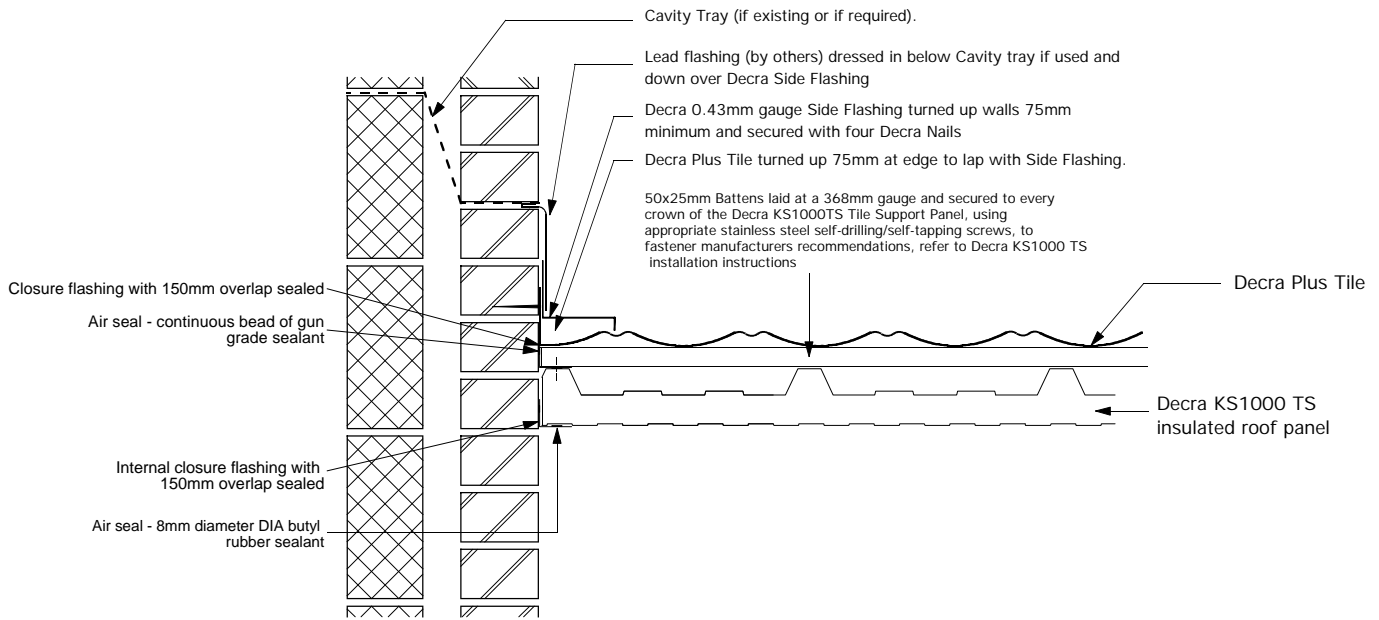

**Abutment Detail With Side Flashing**  
**Detail at Crown abutting vertical surface**  
 Scale 1:10

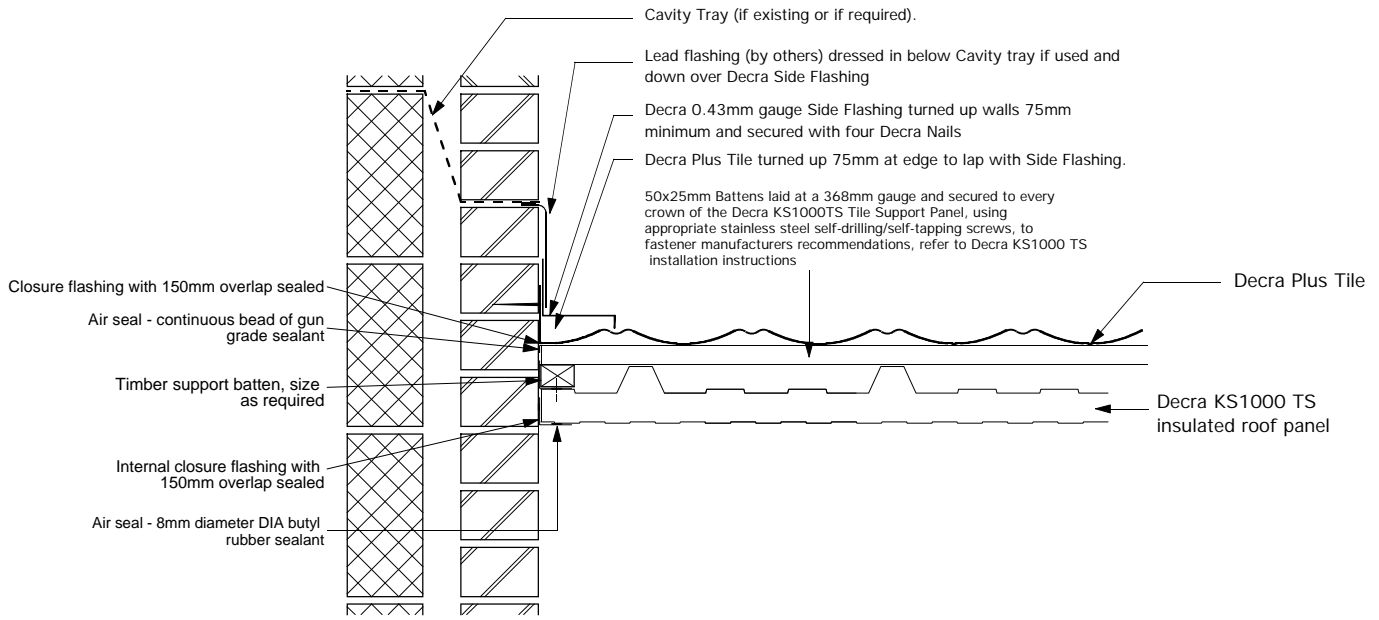

**Abutment Detail With Side Flashing**  
**Detail at Valley abutting vertical surface**  
 Scale 1:10

**Notes:**

This detail is to be read in conjunction with the instructions for the Decra KS1000 TS tile support system.

TS021

**Decra®**  
 Roof Systems Limited  
 A member of the Icopal Group



Unit 4  
 Crompton Fields  
 Crompton Way  
 Crawley  
 West Sussex  
 RH10 9QB

telephone: (01293) 545058/9  
 fax: (01293) 562709  
 email: [technical@decra.co.uk](mailto:technical@decra.co.uk)  
 web-Site: <http://www.decra.co.uk>

The copyright of this drawing and detail information belongs to Decra Roof Systems Limited. Reproduction or amendment outwith the terms of the licensing agreement by other parties is expressly forbidden.

<b>DECRA PLUS</b>		
CONTENT	<b>WARM ROOF ABUTMENT DETAILS WITH DECRA SIDE FLASHING</b>	
DRAWING SCALE	<b>1:10</b>	DATE <b>13/01/04</b>
DRAWING NO	<b>DPSW053</b>	REVISION

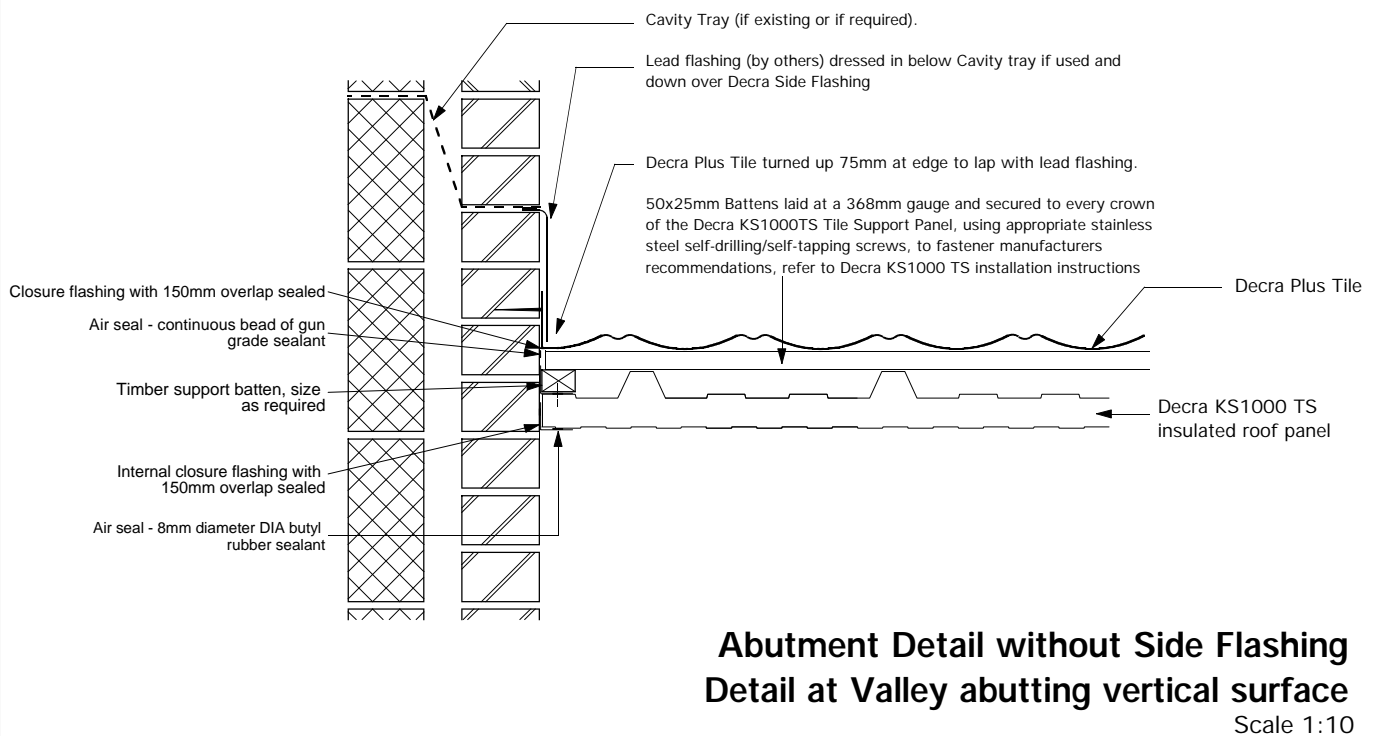
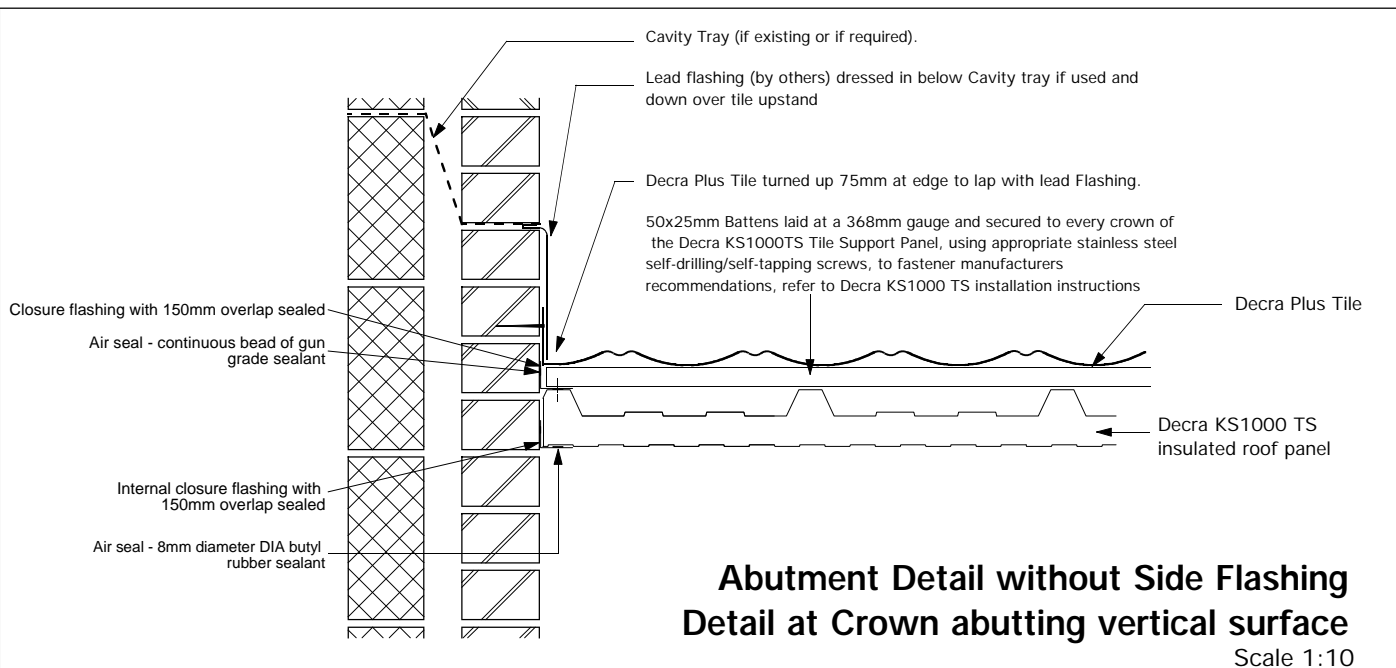

**Notes:**

This detail is to be read in conjunction with the instructions for the Decra KS1000 TS tile support system.

TS021

**Decra**<sup>®</sup>  
 Roof Systems Limited

A member of the Icopal Group



Unit 4  
 Crompton Fields  
 Crompton Way  
 Crawley  
 West Sussex  
 RH10 9QB

telephone: (01293) 545058/9  
 fax: (01293) 562709

email: [technical@decra.co.uk](mailto:technical@decra.co.uk)  
 web-Site: <http://www.decra.co.uk>

The copyright of this drawing and detail information belongs to Decra Roof Systems Limited. Reproduction or amendment outwith the terms of the licensing agreement by other parties is expressly forbidden.

**DECRA PLUS**

CONTENT

**WARM ROOF  
 ABUTMENT DETAILS  
 WITHOUT SIDE FLASHING**

DRAWING SCALE

**1:10**

DATE

**13/01/04**

DRAWING NO

**DPSW054**

REVISION

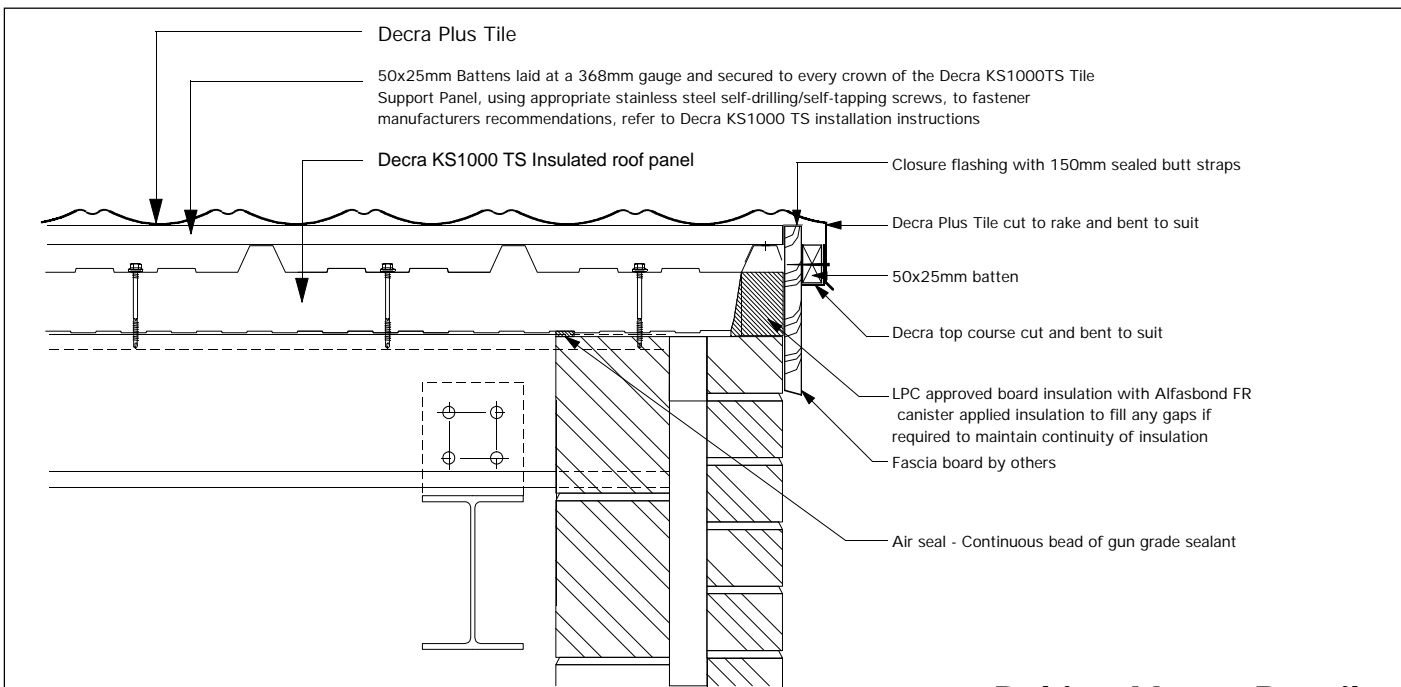

## Raking Verge Detail

Scale 1:10

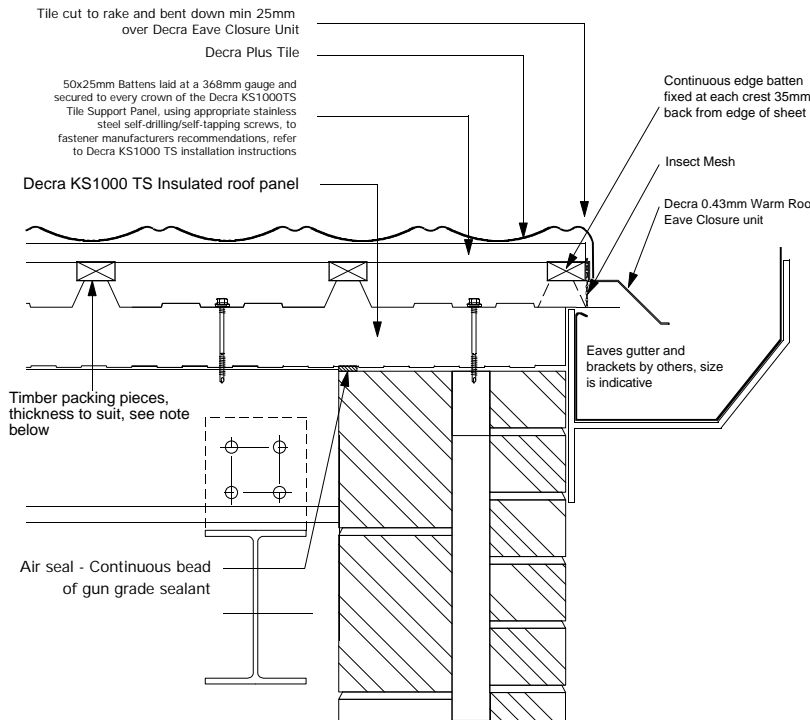

## Raking Verge Detail with gutter

Scale 1:10

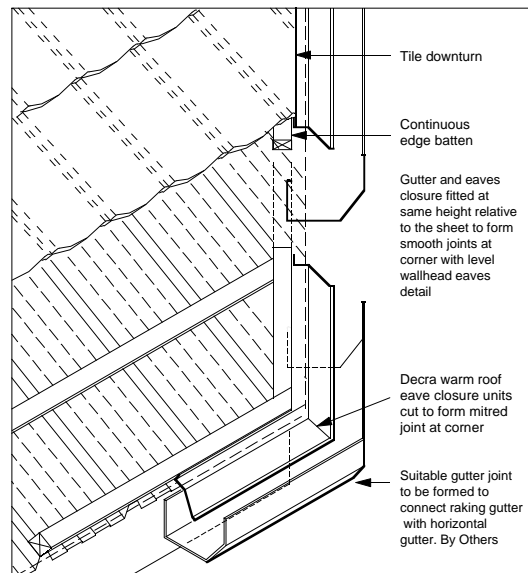

## Cutaway Isometric to Raking Verge

Scale 1:20

### Notes:

This detail is to be read in conjunction with the instructions for the Decra KS1000 TS tile support system.

**Note to Verge Detail With Gutter:** The timber packing pieces are used to raise the tiling battens above the level of the Crests to bring them above the line of the continuous edge batten, and should be reduced from minimum 25mm thick across three or more sheet crests to avoid a visible rise in the tiling.

Gutter sizes to be adjusted as required to comply with calculated width requirements of Code Of Practice as set out in BS 5534: Part1

TS006

**Decra**<sup>®</sup>  
Roof Systems Limited

A member of the Icopal Group



Unit 4  
Crompton Fields  
Crompton Way  
Crawley  
West Sussex  
RH10 9QB

telephone: (01293) 545058/9  
fax: (01293) 562709

email: [technical@decra.co.uk](mailto:technical@decra.co.uk)  
web-Site: <http://www.decra.co.uk>

The copyright of this drawing and detail information belongs to Decra Roof Systems Limited. Reproduction or amendment outwith the terms of the licensing agreement by other parties is expressly forbidden.

## DECRA PLUS

CONTENT

WARM ROOF  
RAKING VERGE DETAILS

DRAWING SCALE

1:10

DATE

13/01/04

DRAWING NO

DPSW055

REVISION

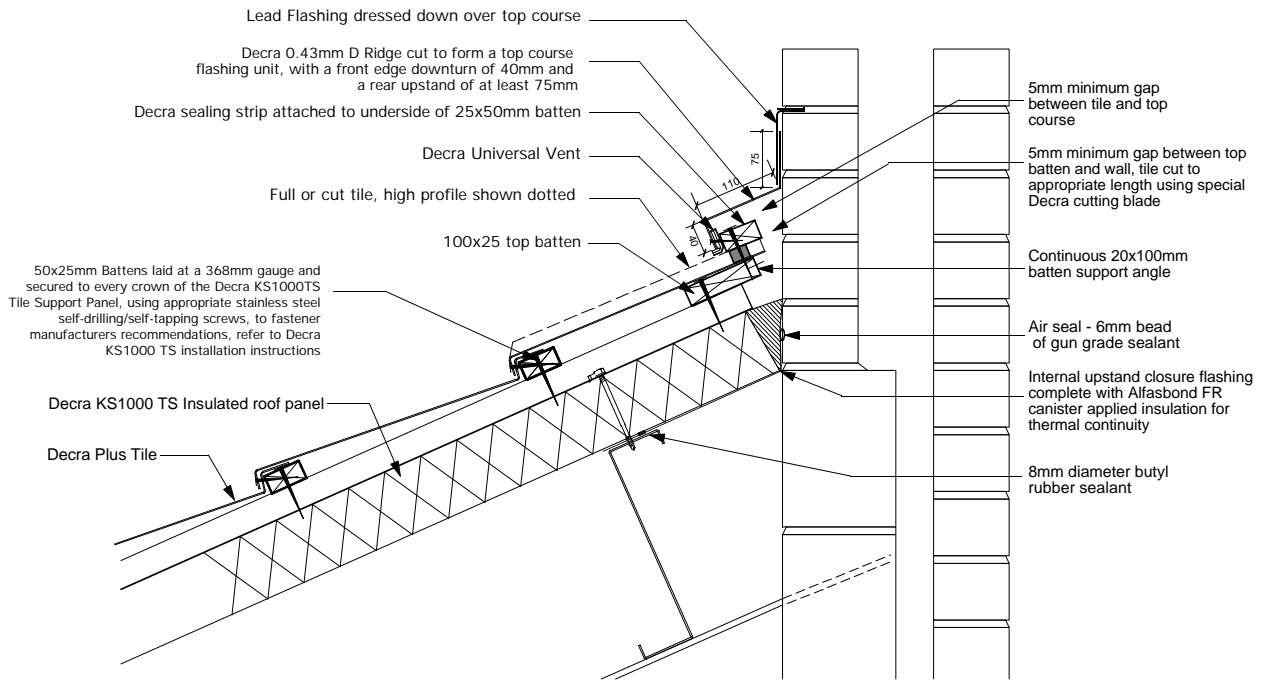

### Top Edge Abutment Detail, using Universal Vent Unit

Scale 1:10

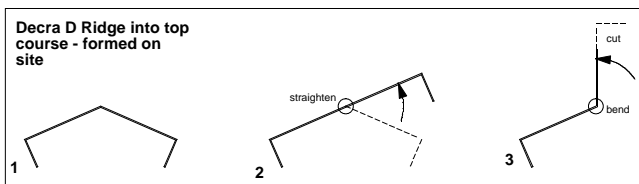

#### Notes:

This detail is to be read in conjunction with the instructions for the Decra KS1000 TS tile support system.

TS016

**Decra**<sup>®</sup>  
Roof Systems Limited

A member of the Icopal Group



Unit 4  
Crompton Fields  
Crompton Way  
Crawley  
West Sussex  
RH10 9QB

telephone: (01293) 545058/9  
fax: (01293) 562709

email: [technical@decra.co.uk](mailto:technical@decra.co.uk)  
web-Site: <http://www.decra.co.uk>

The copyright of this drawing and detail information belongs to Decra Roof Systems Limited. Reproduction or amendment outwith the terms of the licensing agreement by other parties is expressly forbidden.

## DECRA PLUS

CONTENT

WARM ROOF  
TOP EDGE ABUTMENT DETAILS  
(VENTILATED)

DRAWING SCALE

1:10

DATE

13/01/04

DRAWING NO

DPSW056

REVISION

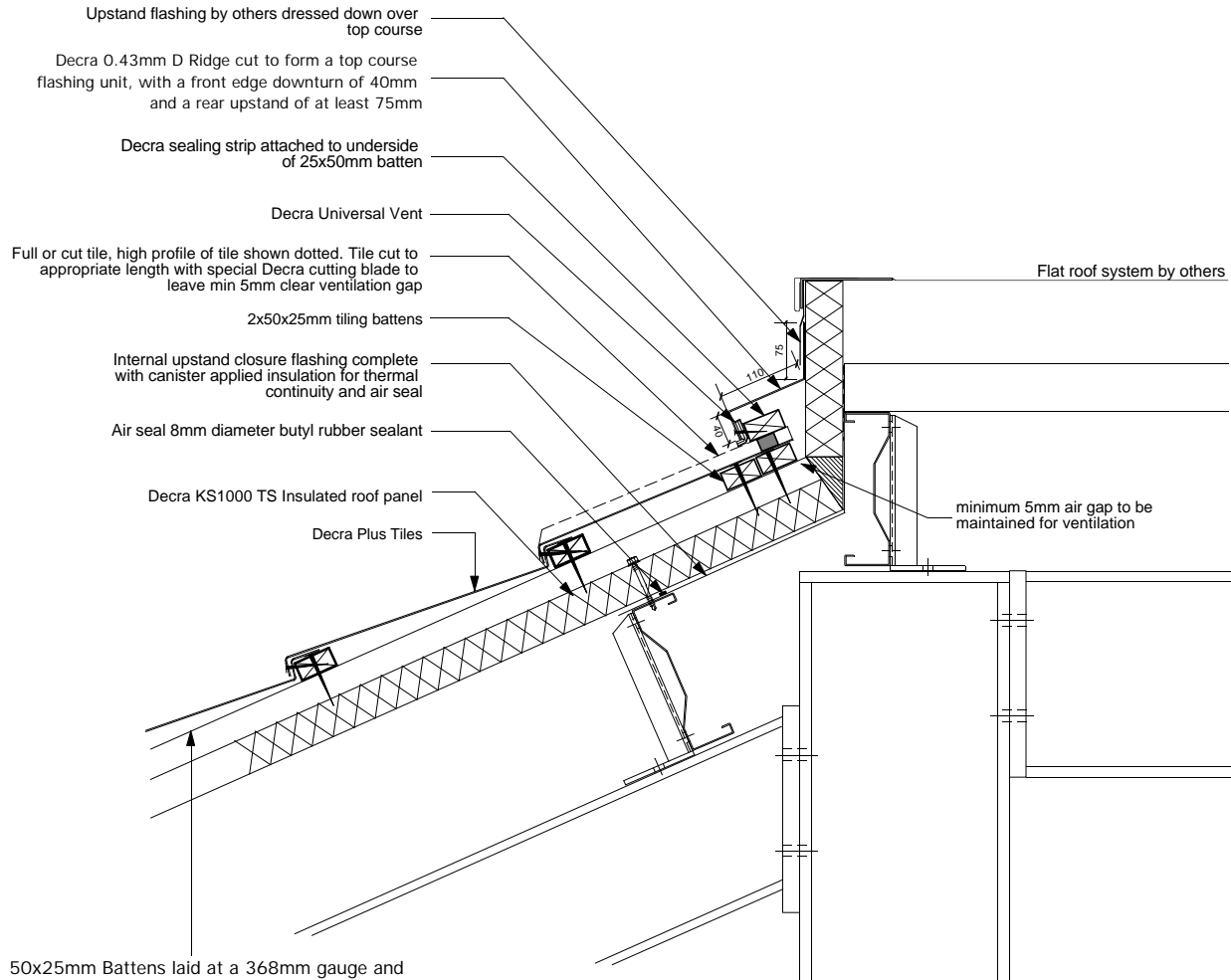

50x25mm Battens laid at a 368mm gauge and secured to every crown of the Decra KS1000TS Tile Support Panel, using appropriate stainless steel self-drilling/self-tapping screws, to fastener manufacturers recommendations, refer to Decra KS1000 TS installation instructions

**Flat Roof Top Edge Abutment Detail**  
Scale 1:10

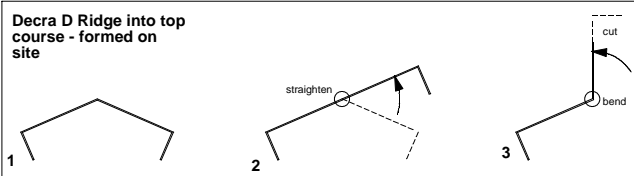

**Notes:**

This detail is to be read in conjunction with the instructions for the Decra KS1000 TS tile support system.

TS019

**Decra®**  
Roof Systems Limited

A member of the Icopal Group



Unit 4  
Crompton Fields  
Crompton Way  
Crawley  
West Sussex  
RH10 9QB

telephone: (01293) 545058/9  
fax: (01293) 562709

email: [technical@decra.co.uk](mailto:technical@decra.co.uk)  
web-Site: <http://www.decra.co.uk>

The copyright of this drawing and detail information belongs to Decra Roof Systems Limited. Reproduction or amendment outwith the terms of the licensing agreement by other parties is expressly forbidden.

**DECRA PLUS**

CONTENT

**WARM ROOF  
FLAT ROOF TOP EDGE ABUTMENT DETAIL**

DRAWING SCALE **1:10**

DATE **14/01/04**

DRAWING NO **DPSW057**

REVISION

50x25mm Battens laid at a 368mm gauge and secured to every crown of the Decra KS1000TS Tile Support Panel, using appropriate stainless steel self-drilling/self-tapping screws, to fastener manufacturers recommendations, refer to Decra KS1000 TS installation instructions

- 8mm diameter rubber sealant
- internal closure flashing
- Canister applied insulation
- Lead Flashing (by others)
- Decra KS1000 TS Insulated roof panel
- Decra Plus Tiles
- 8mm diameter rubber sealant

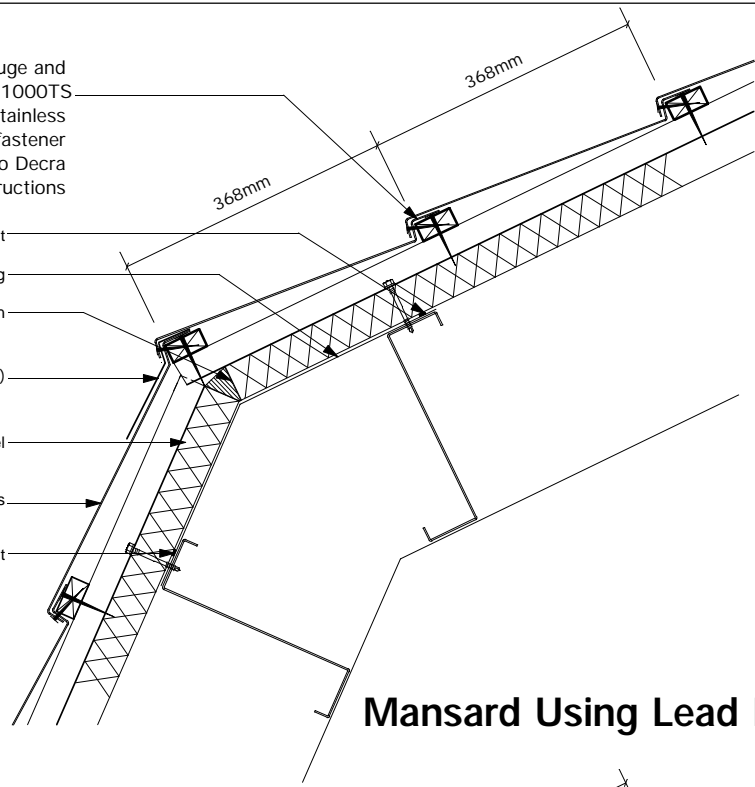

### Mansard Using Lead Flashing

Scale 1:10

50x25mm Battens laid at a 368mm gauge and secured to every crown of the Decra KS1000TS Tile Support Panel, using appropriate stainless steel self-drilling/self-tapping screws, to fastener manufacturers recommendations, refer to Decra KS1000 TS installation instructions

- Decra screws/nails fixed vertically through high point of tile to have finishing kit applied to head.
- Nosing of main roof tile to sit close to top course.
- If this dimension is over 150mm an additional short course of Decra tiles and sealing strip to be used underneath top course
- Decra 0.43mm gauge top course bent to suit spacing of tile batten at change of pitch.
- Decra Plus Tiles
- 8mm diameter rubber sealant
- Decra KS1000 TS Insulated roof panel

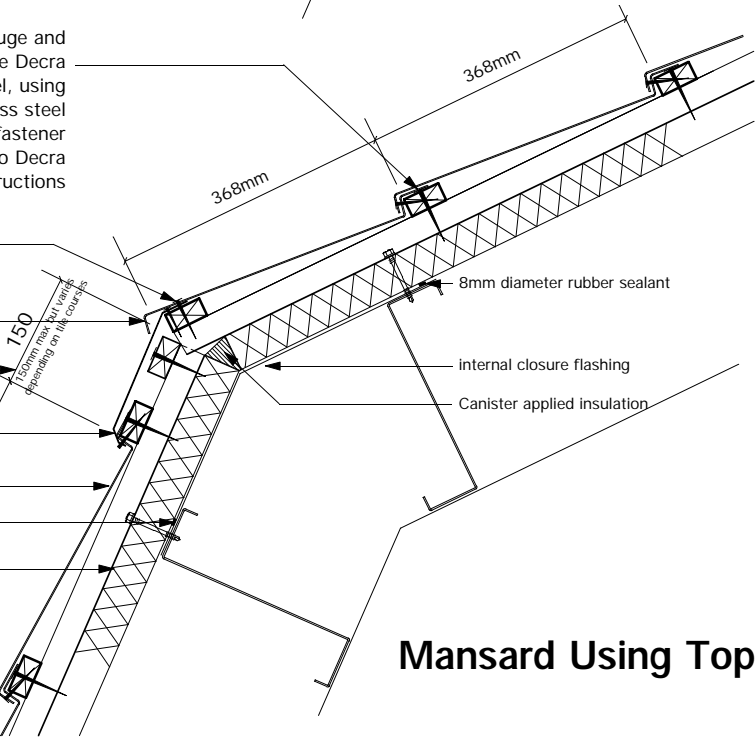

### Mansard Using Top Course

Scale 1:10

#### Notes:

This detail is to be read in conjunction with the instructions for the Decra KS1000 TS tile support system.

TS022

**Decra**<sup>®</sup>  
Roof Systems Limited

A member of the Icopal Group



Unit 4  
Crompton Fields  
Crompton Way  
Crawley  
West Sussex  
RH10 9QB

telephone: (01293) 545058/9  
fax: (01293) 562709

email: [technical@decra.co.uk](mailto:technical@decra.co.uk)  
web-Site: <http://www.decra.co.uk>

The copyright of this drawing and detail information belongs to Decra Roof Systems Limited. Reproduction or amendment outwith the terms of the licensing agreement by other parties is expressly forbidden.

## DECRA PLUS

CONTENT

WARM ROOF  
MANSARD ROOF DETAILS

DRAWING SCALE

1:10

DATE

14/01/04

DRAWING NO

DPSW060

REVISION

50x25mm Battens laid at a 368mm gauge and secured to every crown of the Decra KS1000TS Tile Support Panel, using appropriate stainless steel self-drilling/self-tapping screws, to fastener manufacturers recommendations, refer to Decra KS1000 TS installation instructions

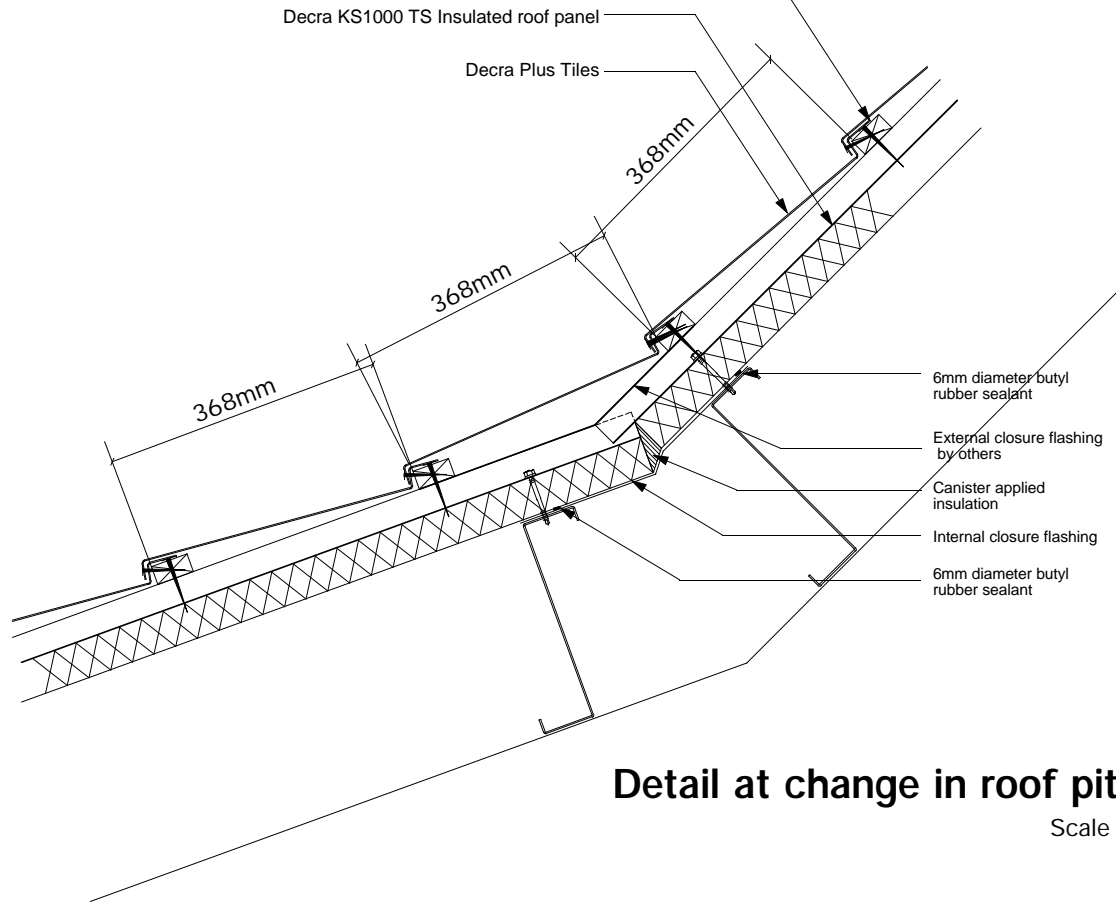

**Detail at change in roof pitch**  
Scale 1:10

**Notes:**

This detail is to be read in conjunction with the instructions for the Decra KS1000 TS tile support system.

TS---

**Decra**<sup>®</sup>  
Roof Systems Limited

A member of the Icopal Group



Unit 4  
Crompton Fields  
Crompton Way  
Crawley  
West Sussex  
RH10 9QB

telephone: (01293) 545058/9  
fax: (01293) 562709

email: [technical@decra.co.uk](mailto:technical@decra.co.uk)  
web-Site: <http://www.decra.co.uk>

The copyright of this drawing and detail information belongs to Decra Roof Systems Limited. Reproduction or amendment outwith the terms of the licensing agreement by other parties is expressly forbidden.

**DECRA PLUS**

CONTENT

**WARM ROOF  
CHANGE IN PITCH DETAILS**

DRAWING SCALE **1:10**

DATE **14/01/04**

DRAWING NO **DPSW061**

REVISION

# VELUX - EDH FLASHING

15° minimum - Velux rooflights cannot be fitted below this pitch  
24° illustrated

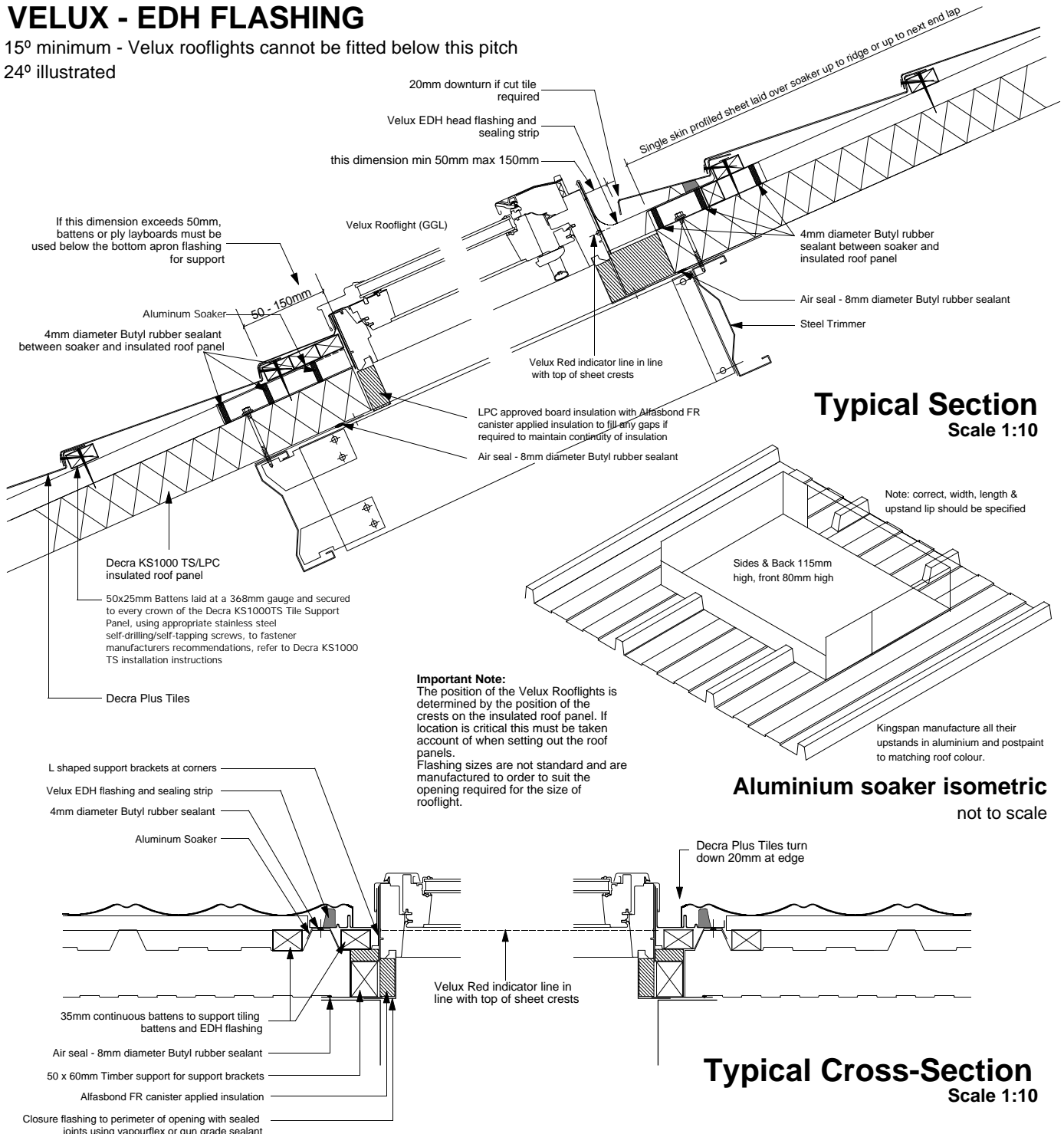

**Important Note:**  
The position of the Velux Rooflights is determined by the position of the crests on the insulated roof panel. If location is critical this must be taken account of when setting out the roof panels. Flashing sizes are not standard and are manufactured to order to suit the opening required for the size of rooflight.

**Notes:**

15° minimum roof pitch for Velux GGL Rooflights.  
Velux Type EDH flashings must be used  
The use of the following rooflights are to be strongly recommended for improved fitting in conjunction with Decra Plus Tiles GGL206, GGL306, GGL410, GGL606, Special sizes complying with overall external frame heights of 1180mmx1600mm.

Velux Rooflight profiles and details courtesy of, and copyright to, Velux.

This detail is to be read in conjunction with Velux installation and design instructions.

Design and installation must ensure that ventilation of roofspace requirements are adhered to. Detail shown may not suit all types of roof construction where ventilation is concerned .

This detail is to be read in conjunction with the instructions for the Decra KS1000 TS tile support system.

This detail to be read in conjunction with Acrobat files for velux installation instructions in the information section on the Decra Technical Services CD

TS015

**Decra®**  
Roof Systems Limited  
A member of the Icopal Group

**ico  
pal**

Unit 4  
Crompton Fields  
Crompton Way  
Crawley  
West Sussex  
RH10 9QB

telephone: (01293) 545058/9  
fax: (01293) 562709  
email: technical@decra.co.uk  
web-Site: http://www.decra.co.uk

The copyright of this drawing and detail information belongs to Decra Roof Systems Limited. Reproduction or amendment outwith the terms of the licensing agreement by other parties is expressly forbidden.

<b>DECRA PLUS</b>		
CONTENT	<b>WARM ROOF VELUX ROOFLIGHT DETAILS</b>	
DRAWING SCALE	<b>1:10</b>	DATE <b>14/01/04</b>
DRAWING NO	<b>DPSW070</b>	REVISION