

Velux Roof Light Installation Instructions

(Using Velux EDW type flashing & 50mm x 25mm tile battens)

The details shown below must be read in conjunction with Velux design and installation instructions. For tile installation details further reference should also be made to Decra Roof Systems technical literature.

Installation instructions illustrate the correct interface between the Decra Classic Tiles, Velux GGL, GGL rooflights and Velux EDW type flashings. Where Decra Stratos Tiles, Decra Oberon Tiles, Decra Plus Tiles and Parctiles are specified for use, all of the principles shown below still apply. Design and installation must ensure that ventilation of roofspace requirements are adhered to.

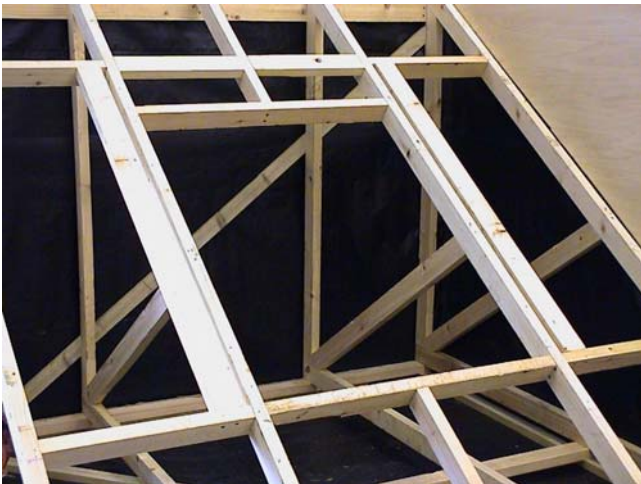

Figure (a)

Prepare roof structure for installation of roof light. Add timber noggins of suitable section where necessary (see figure a).

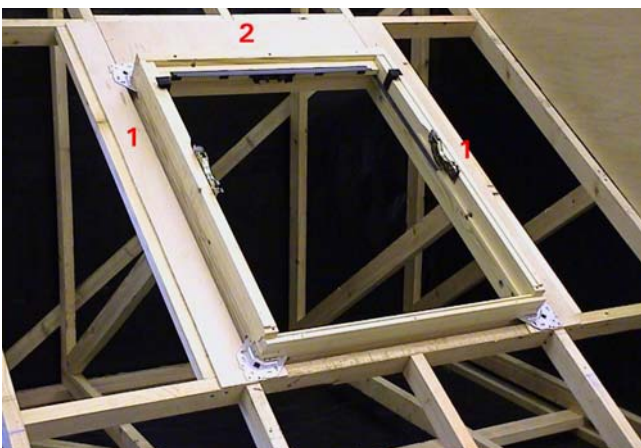

Figure (b)

Install 6mm exterior quality plywood layboards and secure to underlying rafters/noggins (see figure b).

Plywood layboard **1** (100mm width) should be installed leaving a 20mm gap between edge of plywood and roof light.

Plywood layboard **2** (220mm depth) should be installed leaving a 20mm gap between edge of plywood and roof light.



Figure (c)

Figure (d)

Install roof tile underlay and 50mm x 25mm tile battens (see figures c & d). To improve weathertightness of rooflight an optional Velux BFX collar, as recommended by Velux, can be installed over the tile battens as per Velux instructions (BFX collar omitted from following photograph for reasons of illustrative clarity)



Figure (e) Roof tile underlay omitted for clarity

Ensure end of tile battens butt against plywood layboards Do not install tile battens on top of plywood, but ensure tile battens butt against plywood layboard (see figure e). Secure tile battens to rafters and noggins with appropriate fasteners.



Figure (f) Roof tile underlay omitted for clarity

If tile batten at base of roof light fouls plywood layboard, notch tile batten to suit (see red line marked on figure f)

Install Velux EDW front apron flashing as per Velux installation manual (see figure g), taking care to dress malleable flashing neatly into profile of Decra Tile (see figure j). To improve fit of front apron flashing, flatten raised crowns of tile profile where the raised crowns overlap tile batten prior to installing front apron.

If the position of the Velux rooflight necessitates the use of a short course of tiles under the Velux front apron, Cut Decra tiles around front edge of rooflight to appropriate length using tin snips. Prior to installation of cut tile install suitable size timber packing piece to act as a support to head of cut tile, this packing piece should of a depth sufficient to ensure line of tile does not stand proud off or dip below existing sight line of adjoining Decra tiles.

Install Velux EDW side and back gutter flashing as per Velux installation manual (see figures h & i).

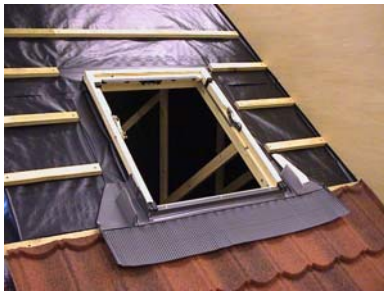

Figure (g)

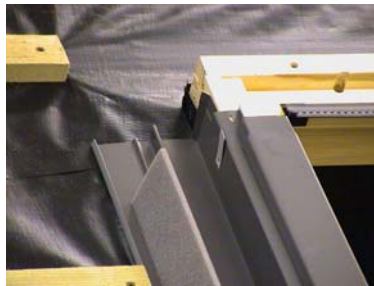

Figure (h)



Figure (i)



Figure (J)

Tiles adjacent Velux side flashing to be cut and bent to form a 20mm downturn , using a guillotine and bender (available from Decra). Tiles adjacent to Velux side flashings should oversail tile battens and gap between the edge of the tile and the roof light should not be less than 30mm (see figure j & k).

Flare edge of nose of Decra tile outwards to form neat outlet to Velux side flashing gutter (see figure l)



Figure (k)

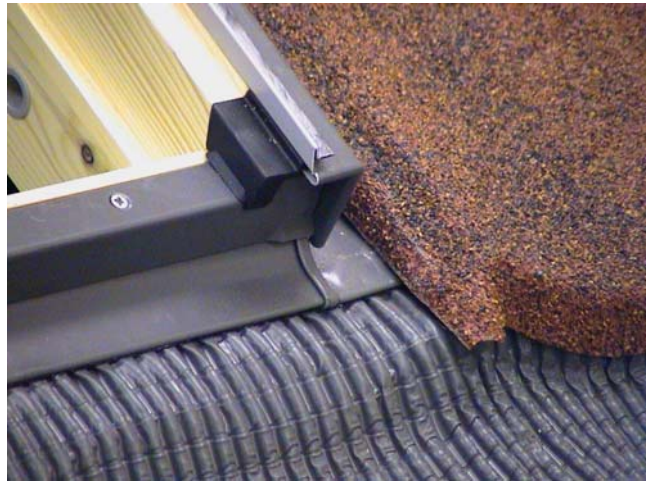

Figure (l)



Figure (m)

Install eaves batten directly behind Velux EDW back gutter flashing. The bottom course of Decra tiles to be secured with four Decra fixing nails driven vertically, close to the high point of the tile profile into the eaves batten. These nail heads to be sealed, using Decra finishing kit.

Tiles adjacent to Velux back gutter flashing should oversail eaves battens and gap between the edge of the tile and the roof light should not be less than 60mm and not greater than 150mm (see figure m & n).

If the position of the rooflight dictates a short course of tiles, cut tiles adjacent Velux back gutter flashing and bend to form a 25mm downturn, using a guillotine and bender (available from Decra).



Figure (J)



Finished Rooflight

For further information please contact

Icopal Limited
Barton Dock Road
Stretford
Manchester
United Kingdom
M32 0YL

Tel 0161 8654444
Fax 0161 8642616

E-mail technical@decra.co.uk
Web <http://www.decra.co.uk>